

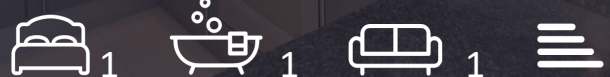

## Parliament View Apartments

1 Albert Embankment, SE1 7XQ

Asking Price £499,950



## Floor Plan

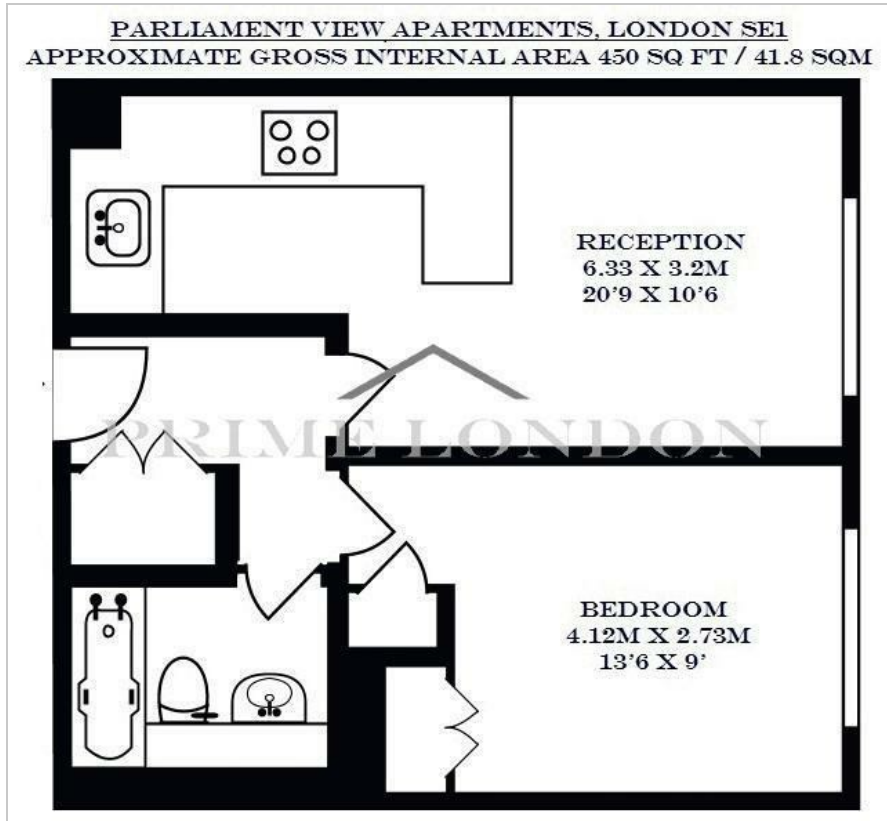

## Area Map



## Energy Efficiency Graph

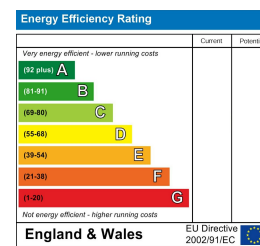

## Viewing

Please contact our on 0207 928 6663 if you wish to arrange a viewing appointment for this property or require further information.

- Floor to ceiling windows
- 24 hour concierge
- Light south-facing reception
- Residents' gymnasium
- Secure underground parking
- Excellent location space

**\*EWS1 Compliant\*** A modern and bright apartment with floor to ceiling windows and a south-facing reception, secure underground parking, secluded position and excellent specifications, available for sale chain free and exclusively through Prime London. The property also includes an open-plan kitchen with granite topped work surface and Bosch integrated appliances, Philippe Starck bathroom and hardwood flooring. Parliament View itself offers a 24 hour concierge service, resident's gymnasium and an excellent location on the river between Lambeth and Vauxhall Bridge. As a result the development is within easy reach of the West End, Westminster, the City and South Bank. Vauxhall rail and underground station.



These particulars, whilst believed to be accurate are set out as a general outline only for guidance and do not constitute any part of an offer or contract. Intending purchasers should not rely on them as statements of representation of fact, but must satisfy themselves by inspection or otherwise as to their accuracy. No person in this firm's employment has the authority to make or give any representation or warranty in respect of the property.