



Hyde Park Gardens

Hyde Park, W2 2LZ

Asking Price £1,450,000



Floor Plan

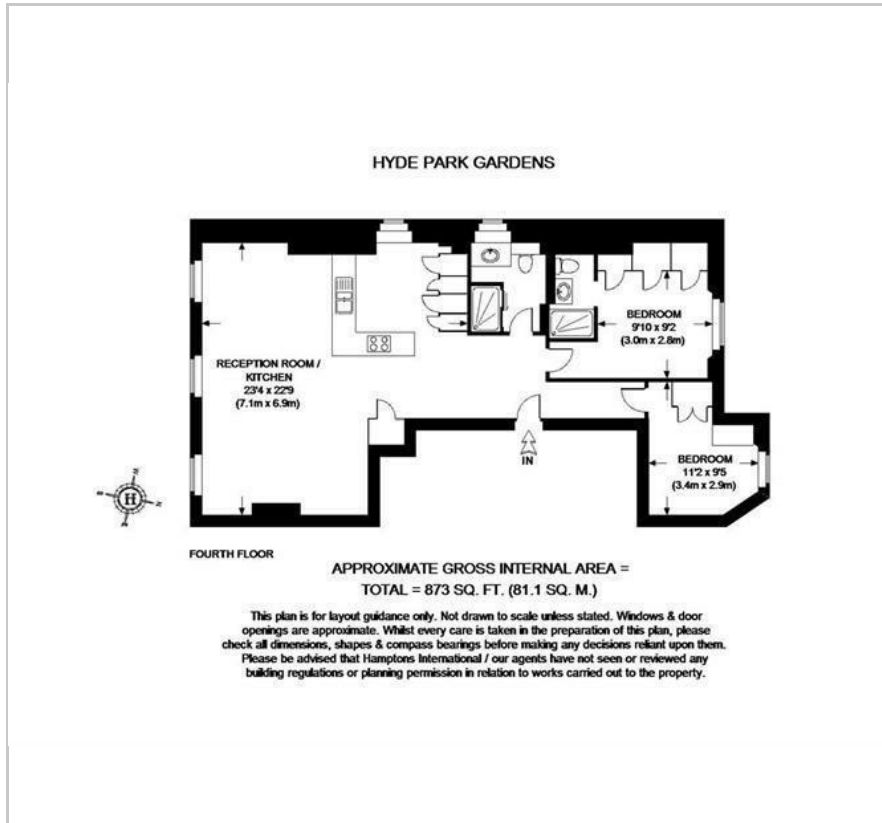

Area Map



Energy Efficiency Graph

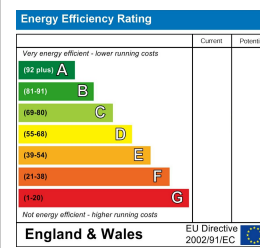

Viewing

By appointment. Contact us on 0207 052 1075 if you wish to arrange a viewing appointment for this property, or require further information.

- Two bedroom contemporary ■ Views over Hyde Park apartment
- Porter/Concierge ■ Passenger Lift
- Private Parking



A contemporary two bedroom apartment with views over Hyde Park in a portered building (with lift) in the exclusive Hyde Park Gardens.

Features include high specification kitchen, marble fireplace, wooden flooring, built-in storage to master and private parking. An ideal 'lock up and leave' London apartment, available to view now.



These particulars, whilst believed to be accurate are set out as a general outline only for guidance and do not constitute any part of an offer or contract. Intending purchasers should not rely on them as statements of representation of fact, but must satisfy themselves by inspection or otherwise as to their accuracy. No person in this firm's employment has the authority to make or give any representation or warranty in respect of the property.