



## The Corniche

23 Albert Embankment, SE1 7GG

Asking Price £1,300,000





## Floor Plan

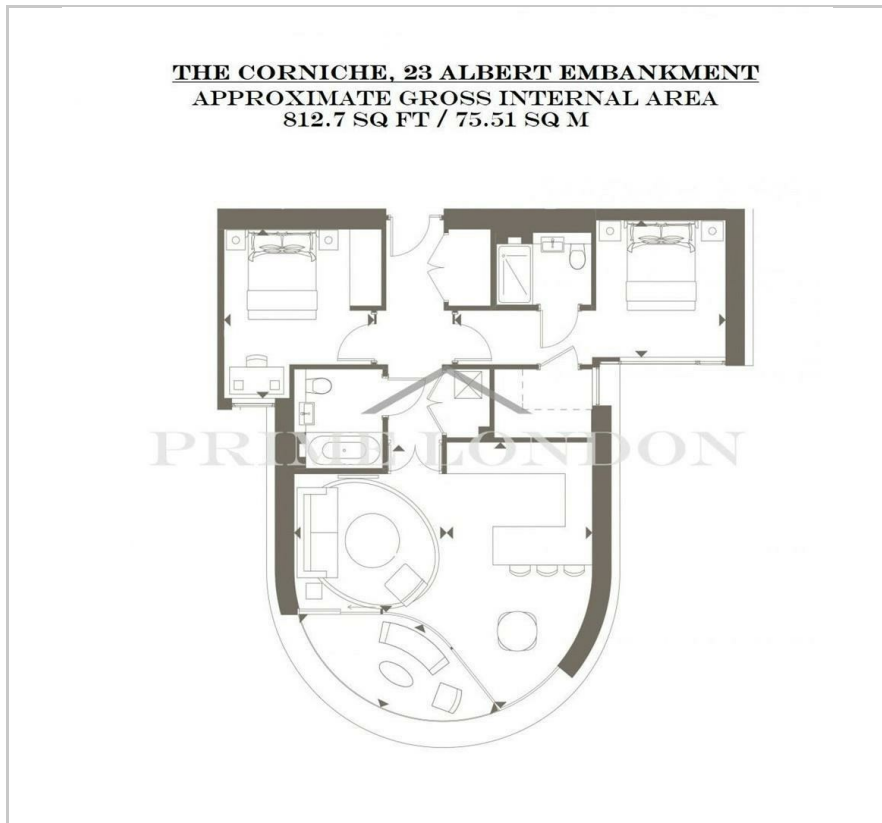

## Area Map



## Energy Efficiency Graph

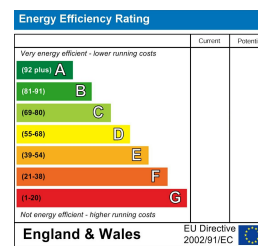

## Viewing

Please contact our on 0207 928 6663 if you wish to arrange a viewing appointment for this property or require further information.

- River facing two bedroom ▪ 812.7 sq ft (75.51 sq m) apartment
- Chain free
- Gym, spa, pool, and Sky Lounge
- Private balcony
- Views of the River Thames
- Underfloor heating and comfort cooling
- 24 hour concierge



This modern and luxurious river facing two bedroom two bathroom apartment is available for chain free sale through Prime London in The Corniche, 23 Albert Embankment.

Located in an enviable position on the bank of the River Thames, The Corniche (designed by Foster & Partners) captures some of London's most exquisite views, not only the Houses of Parliament and the River Thames, but also the Tate Britain, London Eye and the City.

The development includes extensive residents facilities including a restaurant, gym, spa, pool and cinema, and also commercial spaces such as restaurants and cafes focused around a well considered and inviting public space.



These particulars, whilst believed to be accurate are set out as a general outline only for guidance and do not constitute any part of an offer or contract. Intending purchasers should not rely on them as statements of representation of fact, but must satisfy themselves by inspection or otherwise as to their accuracy. No person in this firm's employment has the authority to make or give any representation or warranty in respect of the property.