

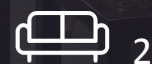

Penthouse

St Johns Building, 79 Marsham Street, SW1P 4SB

Asking Price £3,500,000

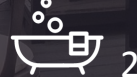

Floor Plan

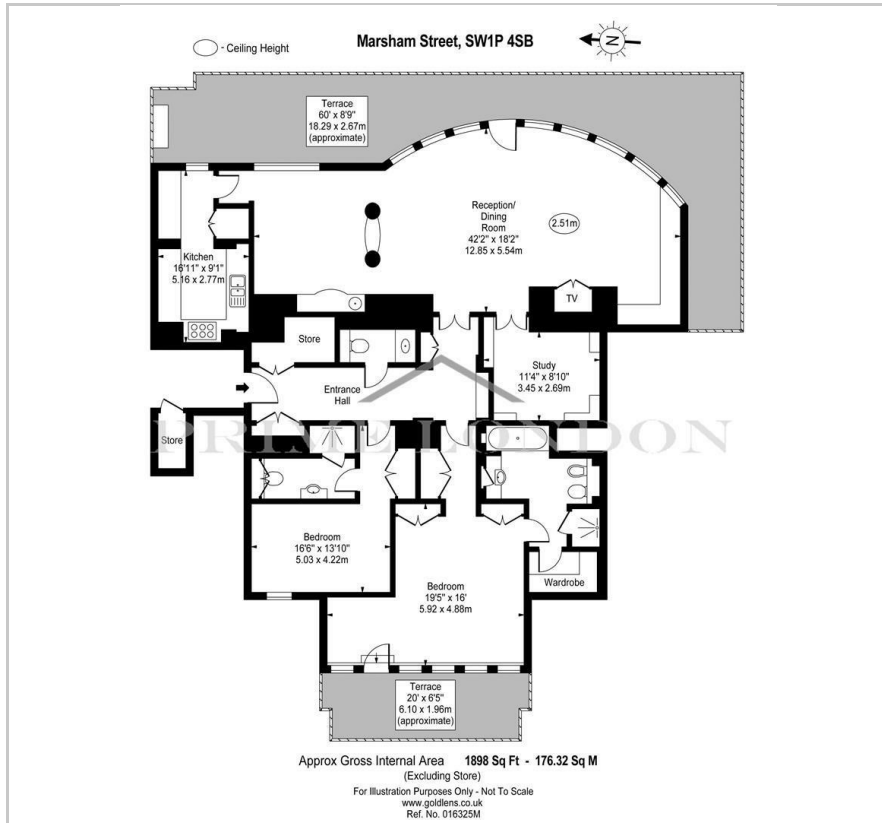

Area Map



Energy Efficiency Graph

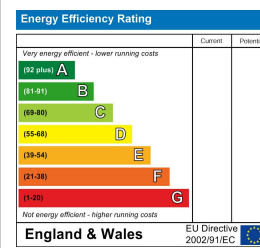

Viewing

By appointment. Contact us on 0207 052 1075 if you wish to arrange a viewing appointment for this property, or require further information.

- Immaculate penthouse apartment
- Large roof terraces
- Views of the Palace of Westminster, Big Ben and London skyline
- 1,898 sq ft (176.32 sqm) internally
- 24 hour concierge
- Residents' only leisure suite
- Meeting Room
- Valet parking

An immaculate penthouse apartment, benefiting from a large roof terrace and fabulous views of the Palace of Westminster, Big Ben and London skyline, available for sale exclusively through Prime London. The property, totalling some 1,898 sq ft (176.32 sqm) internally, has especially good living and entertaining space, situated all on one level, leading directly to the principal roof terrace, with a second roof terrace accessed from the master bedroom suite. St Johns is a sought after building providing 24 hour concierge, residents' only leisure suite, meeting room and valet parking. The building is located 0.5 miles from Pimlico underground station (Victoria Line) which provides access to Victoria and the West End. Westminster underground station (Jubilee / Circle and District Line) is 0.7 miles from the property which provides access to the City and Canary Wharf. The amenities of Great Peter Street and Horseferry Road are located 0.2 miles from the property.



These particulars, whilst believed to be accurate are set out as a general outline only for guidance and do not constitute any part of an offer or contract. Intending purchasers should not rely on them as statements of representation of fact, but must satisfy themselves by inspection or otherwise as to their accuracy. No person in this firm's employment has the authority to make or give any representation or warranty in respect of the property.