



Whitehouse Apartments

9 Belvedere Road, South Bank, SE1 8YP

£807 Per Week



2



2



1



C

Floor Plan

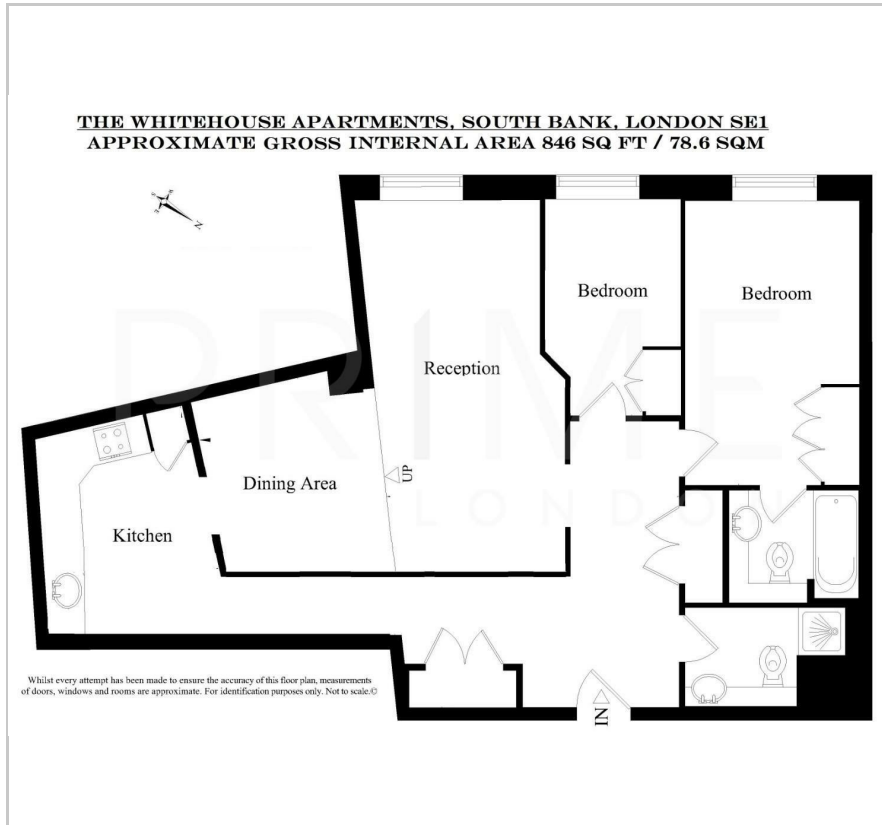

Area Map



Energy Efficiency Graph

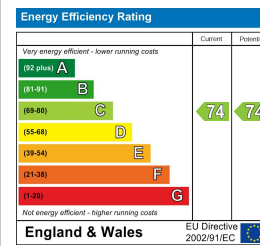

Viewing

By appointment. Contact us on 0207 928 6663 if you wish to arrange a viewing appointment for this property, or require further information.

- Larger style
- Exclusive access to the spa and fitness centre
- 24 hour concierge service
- 846 sq ft (78.6 sqm)
- Gymnasium, heated swimming pool, steam room and sauna
- Communal roof terrace

This larger style apartment of some 846 sq ft (78.6 sqm) offers a rare opportunity to lease such a spacious property within the Whitehouse Apartments, South Bank. The property is available exclusively through Prime London.

The apartment offers a large and open reception, two double bedrooms with built-in storage (master with en suite), a fully fitted kitchen, dining/office area and separate shower room.

Additionally, residents enjoy exclusive access to the spa and fitness centre complete with fully equipped gymnasium, heated swimming pool, steam room and sauna.

The Whitehouse Apartments further features a 24 hour concierge service and communal roof terrace. Positioned moments from the South Bank, the location offers an array of some of London's finest cultural attractions, restaurants, cafes and shops.

Nearby Waterloo station provides superb transport links via the Bakerloo, Jubilee, Northern and Waterloo & City lines.



These particulars, whilst believed to be accurate are set out as a general outline only for guidance and do not constitute any part of an offer or contract. Intending purchasers should not rely on them as statements of representation of fact, but must satisfy themselves by inspection or otherwise as to their accuracy. No person in this firm's employment has the authority to make or give any representation or warranty in respect of the property.

Palace View, 131 Lambeth Road, London SE1 7BT | 21 Grosvenor Gardens, Belgravia, London SW1W 0BP

Tel: 0207 928 6663 | 0207 052 1075 Email: Office@PrimeLondonResidential.com www.PrimeLondonResidential.com