

The Tower

One St. George Wharf, SW8 2BW

£1,730 Per Week

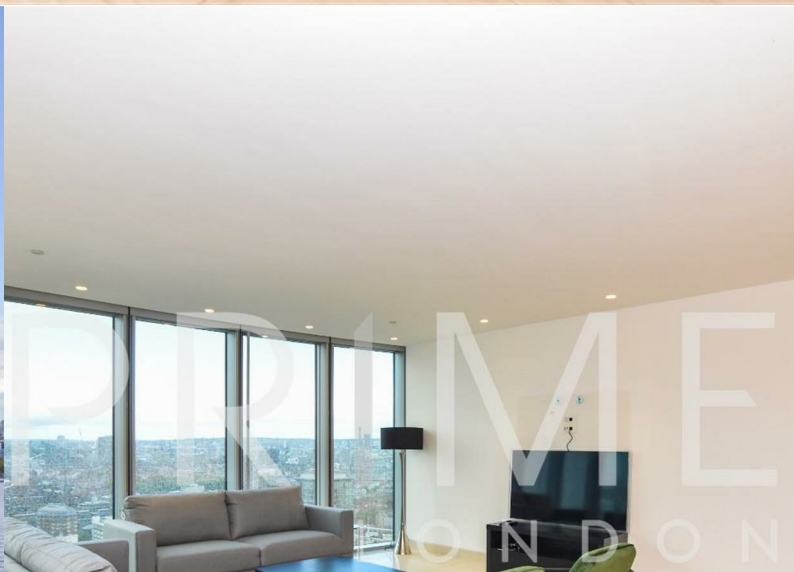

3



2



1



B

Floor Plan

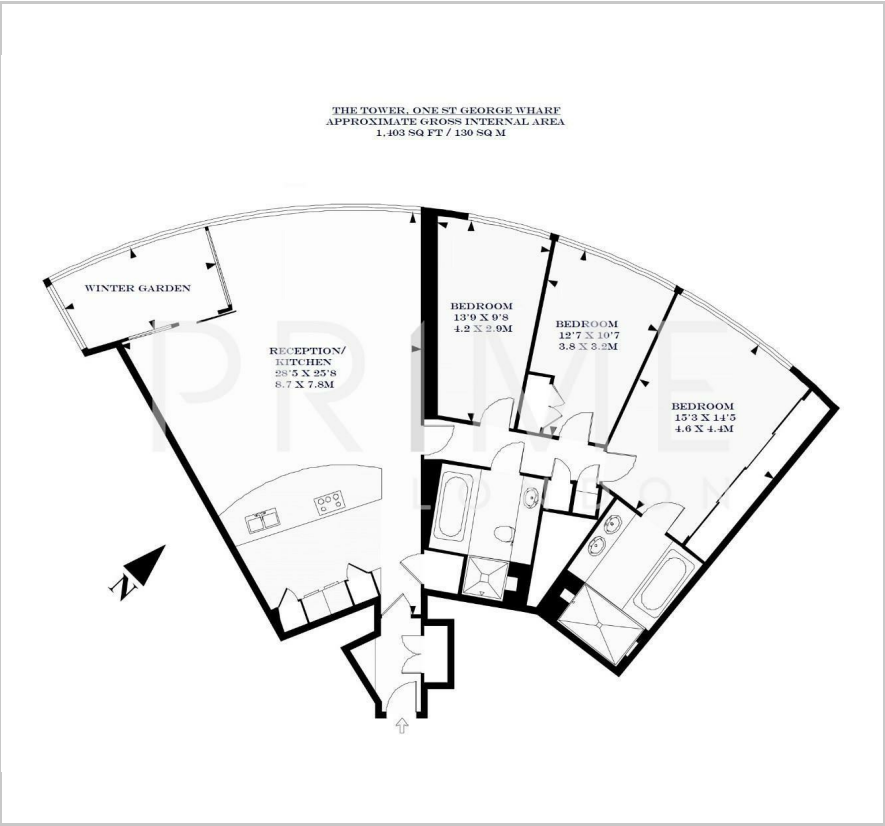

Area Map

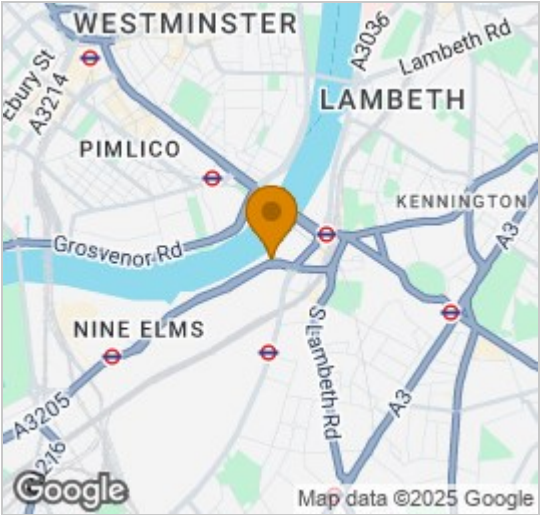

Energy Efficiency Graph

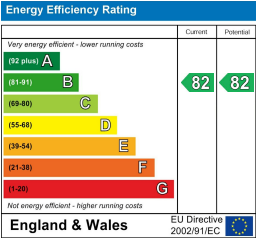

Viewing

By appointment. Contact us on 0207 928 6663 if you wish to arrange a viewing appointment for this property, or require further information.

- Beautiful three bedroom ■ 1,403 sq ft (130 sqm) apartment
- Unparalleled views up and down ■ In excellent condition throughout the river
- Gym, pool and sauna facilities ■ Private cinema
- Valet parking ■ 24 hour concierge



With unparalleled views up and down the River Thames, this exceptionally well positioned and fully furnished three bedroom apartment, located in the iconic St George Wharf Tower on the River Thames, offers a great living space with stunning views over London and is available to rent through Prime London.

This 1,403 sq ft (130 sqm) apartment features an excellent specification throughout include marble, glass and walnut finishes and includes underfloor heating and comfort cooling. The apartment further benefits from its own sky garden balcony, fully comprehensive kitchen with Miele appliances, modern bathrooms and valet parking.

Amenities include front door concierge with valet parking, first floor gym, pool and sauna facilities as well as a private cinema.

St George Wharf offers on site riverside bars and restaurants such as Waterfront London, The Riverside, Four Degree and Pop Art Sushi as well as direct access to Vauxhall Underground Station on the Victoria Line. For additional convenience other on site outlets include Tesco Express, Pret a Manger, Hudson's Dry Cleaners, Riverside Medical Centre & Dental Spa and more.



These particulars, whilst believed to be accurate are set out as a general outline only for guidance and do not constitute any part of an offer or contract. Intending purchasers should not rely on them as statements of representation of fact, but must satisfy themselves by inspection or otherwise as to their accuracy. No person in this firms employment has the authority to make or give any representation or warranty in respect of the property.