



## Anchor House

St George Wharf, SW8 2FH

£475 Per Week



## Floor Plan

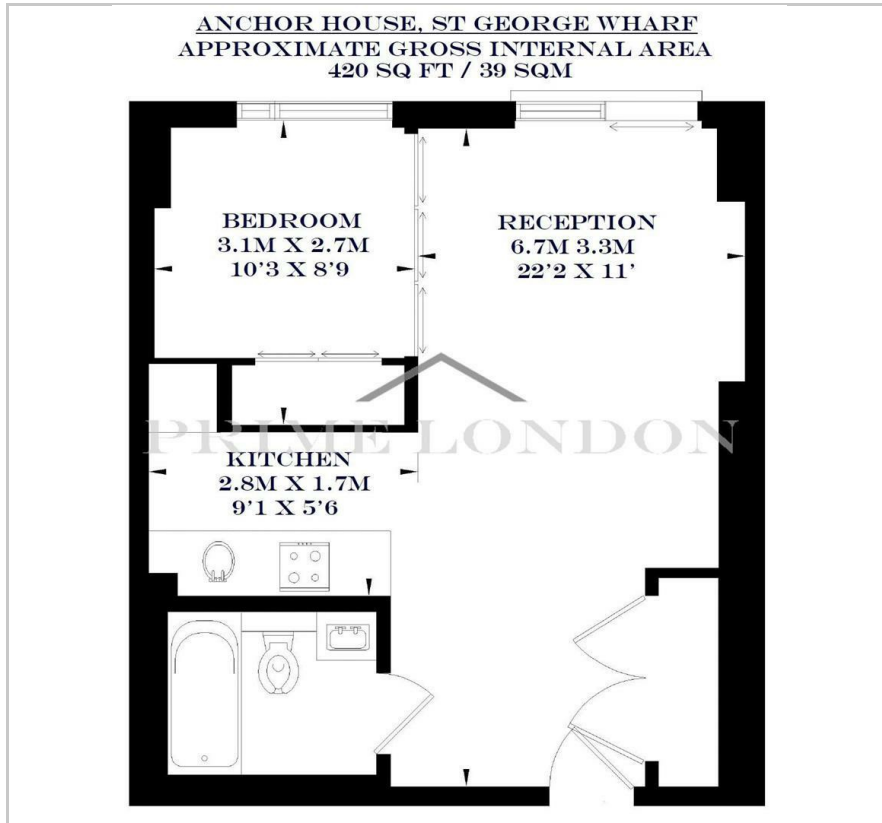

## Area Map

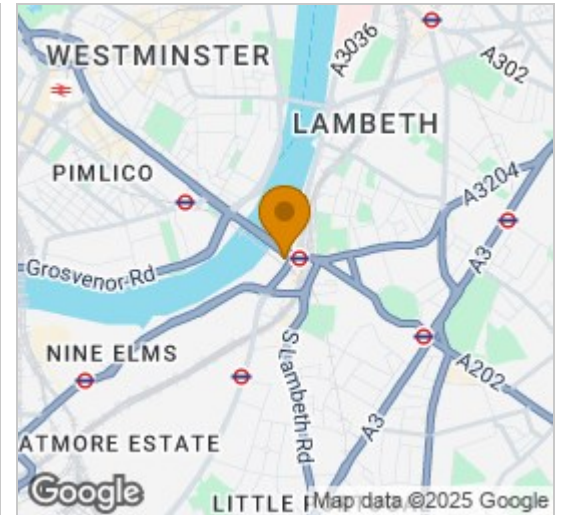

## Energy Efficiency Graph

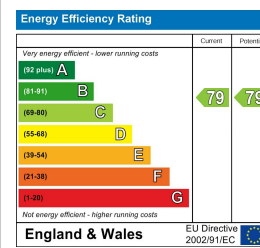

## Viewing

By appointment. Contact us on 0207 928 6663 if you wish to arrange a viewing appointment for this property, or require further information.

- Air cooling
- Manhattan style apartment
- Fantastic transport links
- 24 hour concierge

A high specification Manhattan style apartment, with air cooling and quality furnishings, available through Prime London in this excellently located and well-served riverside development, St George Wharf.

This apartment offers an open reception, open-plan kitchen, wooden flooring, and separate family bathroom.

This apartment has fantastic transport links afforded by this very well kept complex by The River Thames.

St George Wharf offers on site riverside bars and restaurants such as Waterfront London, The Riverside, Four Degree and Pop Art Sushi as well as direct access to Vauxhall Underground Station on the Victoria Line.

For additional convenience other on site outlets include Tesco Express, Pret a Manger, Hudson's Dry Cleaners, Riverside Medical Centre & Dental Spa and more.



These particulars, whilst believed to be accurate are set out as a general outline only for guidance and do not constitute any part of an offer or contract. Intending purchasers should not rely on them as statements of representation of fact, but must satisfy themselves by inspection or otherwise as to their accuracy. No person in this firm's employment has the authority to make or give any representation or warranty in respect of the property.

Palace View, 131 Lambeth Road, London SE1 7BT | 21 Grosvenor Gardens, Belgravia, London SW1W 0BP

Tel: 0207 928 6663 | 0207 052 1075 Email: [Office@PrimeLondonResidential.com](mailto:Office@PrimeLondonResidential.com) [www.PrimeLondonResidential.com](http://www.PrimeLondonResidential.com)