

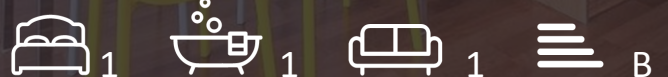

The Bridge

334 Queenstown Road Town, Battersea, SW11 8NP

£485 Per Week



Floor Plan

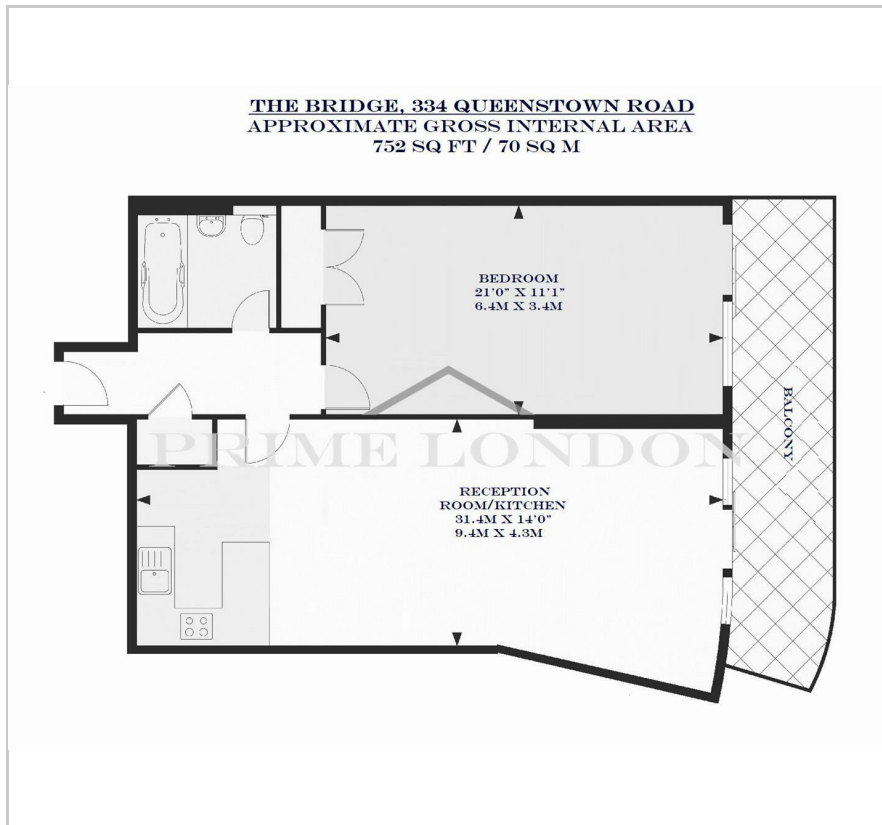

Area Map

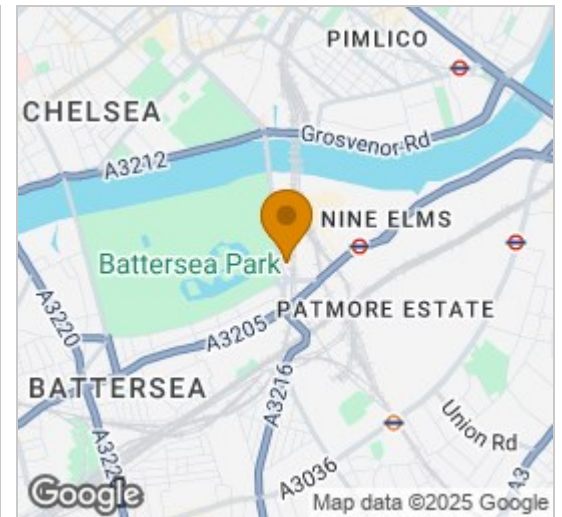

Energy Efficiency Graph

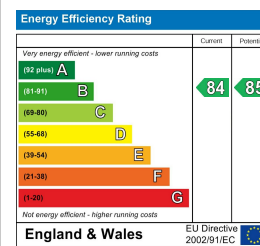

Viewing

By appointment. Contact us on 0207 928 6663 if you wish to arrange a viewing appointment for this property, or require further information.

- Spacious apartment
- Views of Battersea Park
- Fully furnished
- 752 sq ft (70 sqm)
- Large private balcony
- Concierge service

This exceptionally large and bright one-bedroom apartment with large private balcony, set within a modern development with concierge, lift, and located just moments from Battersea Park, is available to rent through Prime London.

This superb and fully furnished apartment is well laid out and is presented in excellent order throughout. The property comprises a spacious and contemporary reception with a fully-fitted kitchen and breakfast bar, a double bedroom with fitted wardrobes, and modern family bathroom.

The property additionally benefits from wooden flooring and excellent storage throughout, as well as large balcony that offers views across to Battersea Park.



These particulars, whilst believed to be accurate are set out as a general outline only for guidance and do not constitute any part of an offer or contract. Intending purchasers should not rely on them as statements of representation of fact, but must satisfy themselves by inspection or otherwise as to their accuracy. No person in this firm's employment has the authority to make or give any representation or warranty in respect of the property.