



## Moore House

Grosvenor Waterside, 2 Gatliff Road, SW1W 8DU

£1,441 Per Week



## Floor Plan

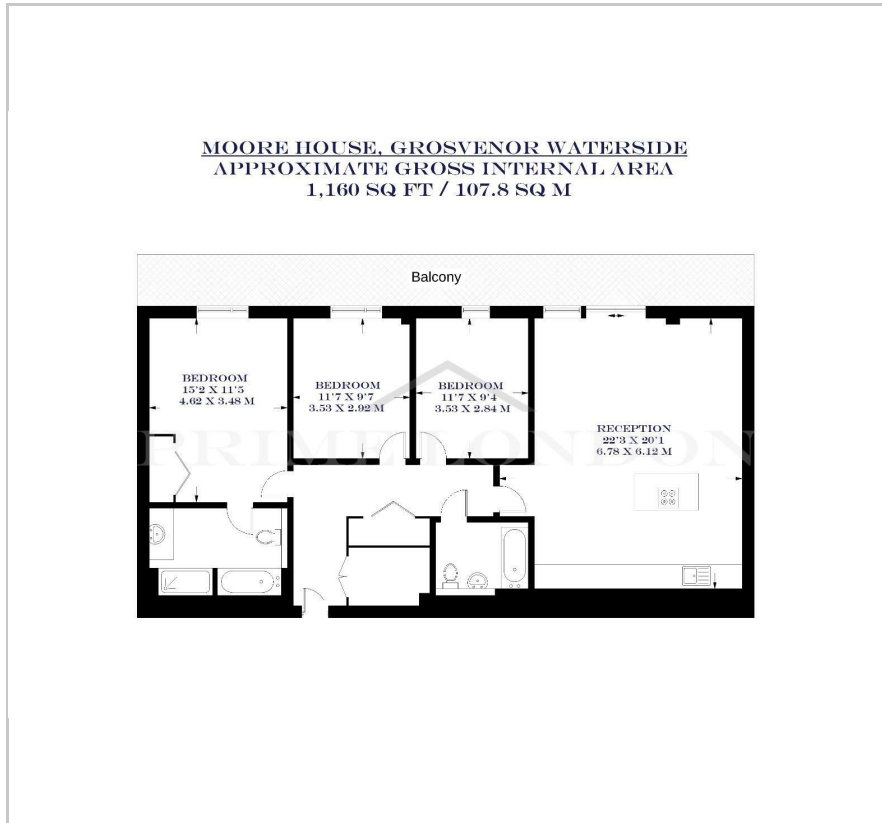

## Area Map

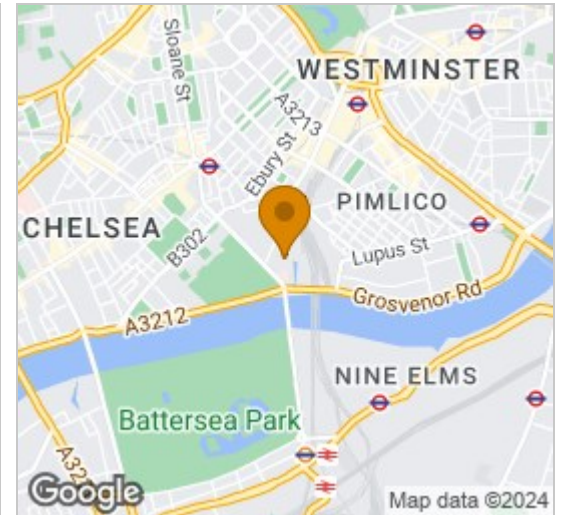

## Energy Efficiency Graph

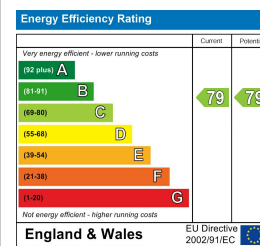

## Viewing

By appointment. Contact us on 0207 052 1075 if you wish to arrange a viewing appointment for this property, or require further information.

- Three large bedroom ▪ 1,124 sq. ft (104.4 sqm) apartment
- Furnished ▪ Open plan kitchen and large reception area
- Residents' gym and spa ▪ 24 hours concierge facilities

This bright and spacious three bedroom apartment in Moore House, located in the sought-after development of Grosvenor Waterside, is available to rent through Prime London.

This 1,124 sq. ft (104.4 sq m) property comprises of three double bedrooms and two bathrooms; one of which is an en-suite to the master bedroom. This apartment further benefits from a large open plan kitchen with an island and reception room leading out onto a large balcony.

Residents of Grosvenor Waterside benefit from a gym, spa, and 24-hour concierge services. It is a perfect environment for modern living in one of London's most prestigious and dynamically changing areas.

Situated on the north side of the river by Chelsea Bridge, the open spaces of Battersea Park are also close by. Grosvenor Waterside is located just half a mile away from Sloane Square underground station and within easy walking distance of fashionable Kings Road.

The Victoria mainlines and underground station (Victoria, Circle and District lines, zone 1) are also within close proximity.



These particulars, whilst believed to be accurate are set out as a general outline only for guidance and do not constitute any part of an offer or contract. Intending purchasers should not rely on them as statements of representation of fact, but must satisfy themselves by inspection or otherwise as to their accuracy. No person in this firm's employment has the authority to make or give any representation or warranty in respect of the property.