



Jellicoe House

St George Wharf, SW8 2JF

£750 Per Week



Floor Plan

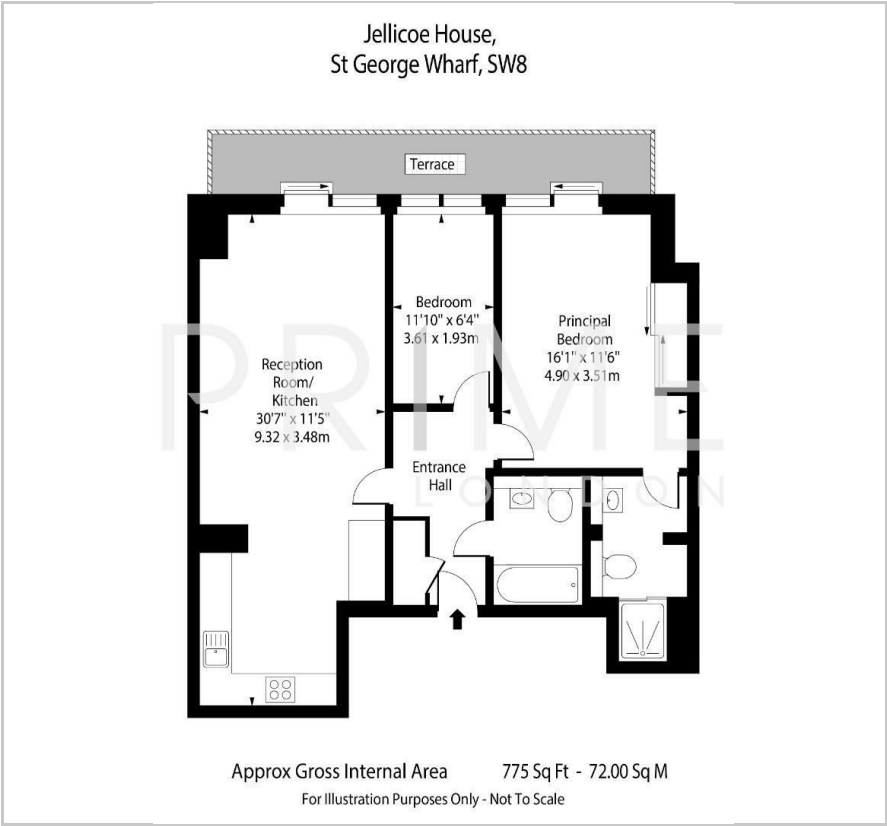

Area Map



Energy Efficiency Graph

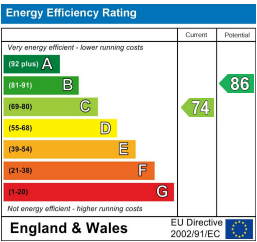

Viewing

By appointment. Contact us on 0207 928 6663 if you wish to arrange a viewing appointment for this property, or require further information.

- Generous space
- High specification
- On-site riverside bars and restaurants
- 775 sq ft
- Full length balcony
- Fantastic transport links



A high specification and generous two bedroom apartment of 775 sq ft, with full length balcony, available through Prime London in this excellently located riverside development, St. George Wharf.

This apartment benefits from the fantastic transport links afforded by this very well kept complex by The River Thames.

St George Wharf also offers on site riverside bars and restaurants such as Waterfront London, The Riverside, Cottons, and Vine Bar, as well as direct access to Vauxhall Underground Station.

For additional convenience other on-site outlets include Tesco Express, Pret a Manger, Hudson's Dry Cleaners, Riverside Medical Centre, Dental Spa and more.



These particulars, whilst believed to be accurate are set out as a general outline only for guidance and do not constitute any part of an offer or contract. Intending purchasers should not rely on them as statements of representation of fact, but must satisfy themselves by inspection or otherwise as to their accuracy. No person in this firms employment has the authority to make or give any representation or warranty in respect of the property.