



Milliners House, London Bridge, SE1 3UW

£595 Per Week





£595 Per Week

Milliners House

London Bridge, SE1 3UW

- Exceptionally spacious
- Stylish, boutique conversion
- Unique village lifestyle
- 675 sq ft (62.7 sqm)
- Bars, cafés and award winning eateries
- Close to London Bridge

An exceptionally spacious top floor apartment of 675 sq ft (62.7 sqm), within a warehouse conversion on the fashionable Bermondsey Street, available for lease exclusively through Prime London.

Milliners House is a stylish, boutique conversion for those looking to enjoy a unique village lifestyle within Central London.

This fantastic location offers an array of bars, cafés and award winning eateries as well as boutique shops and other artisan businesses on the doorstep.

The property is a short walk from Borough Market, More London and Bankside, and London Bridge offers transport connections to Canary Wharf, The City, and the West End





Floor Plans

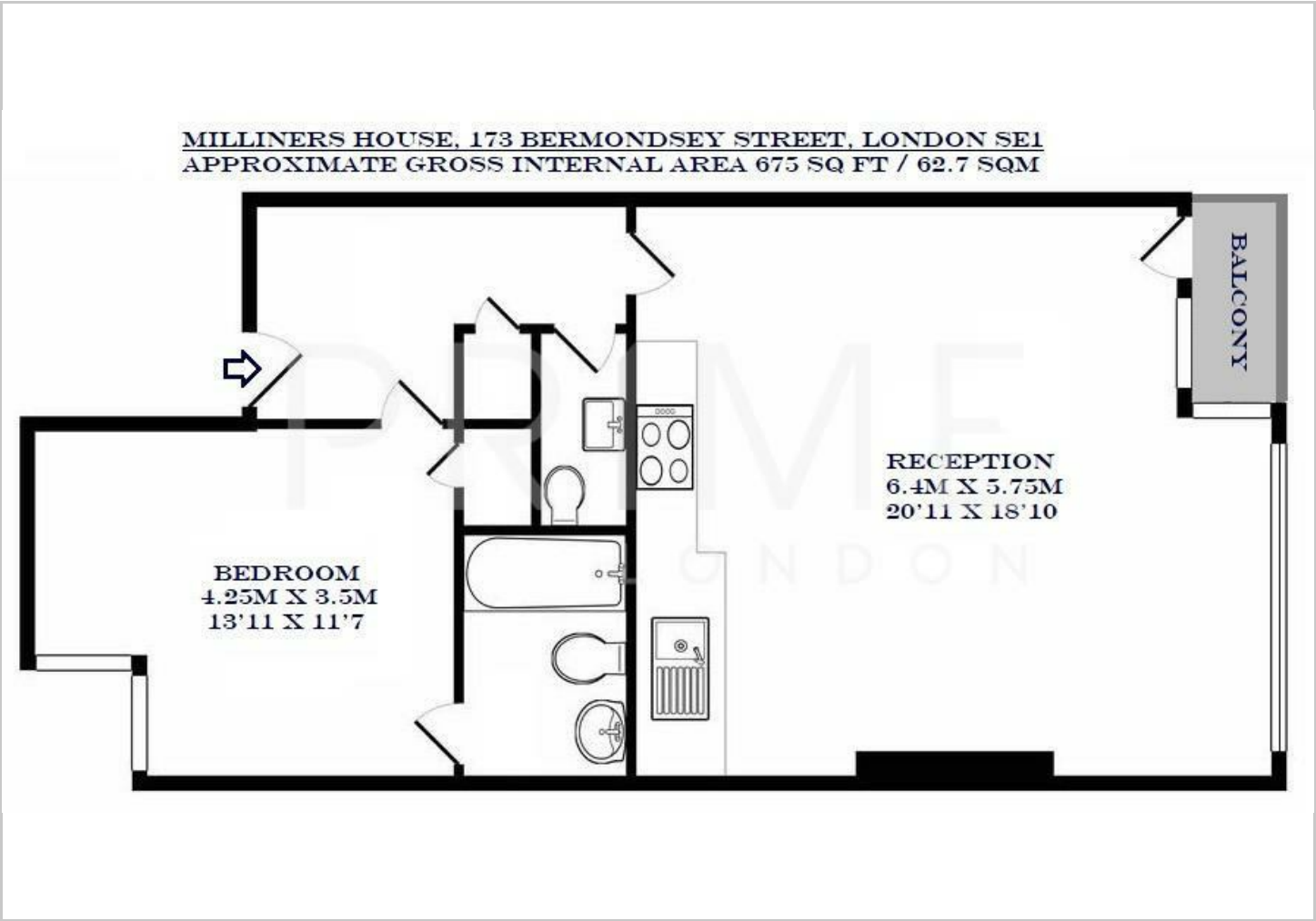

Viewing

By appointment. Contact us if you wish to arrange a viewing appointment for this property, or require further information.

The particulars are set out as a general outline only for the guidance of intended purchasers or lessees, and do not constitute, any part of a contract. Nothing in these particulars shall be deemed to be a statement that the property is in good structural condition or otherwise nor that any of the services, appliances, equipment or facilities are in good working order. Purchasers should satisfy themselves of this prior to purchasing.

Location Map

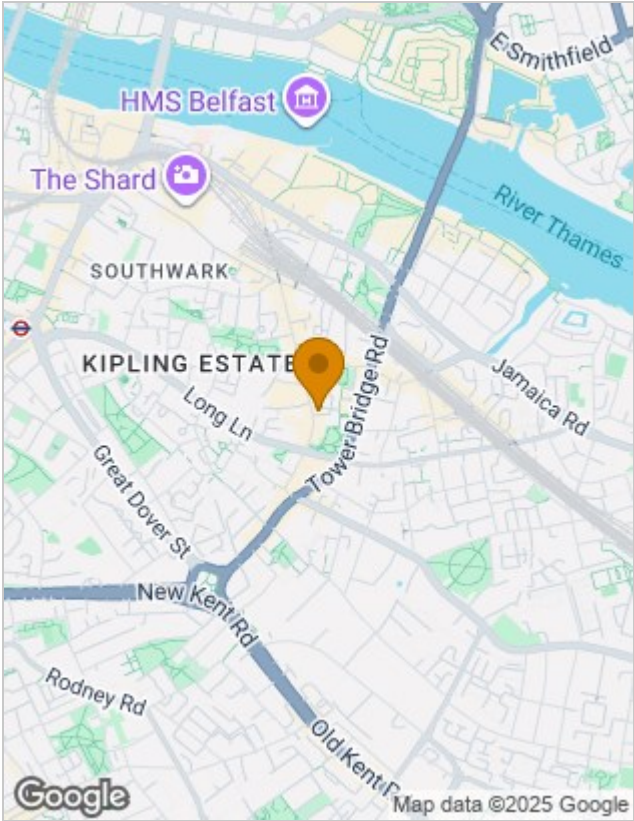

Energy Performance Graph

