



## The Corniche

24 Albert Embankment, SE1 7GJ

£1,250 Per Week



## Floor Plan

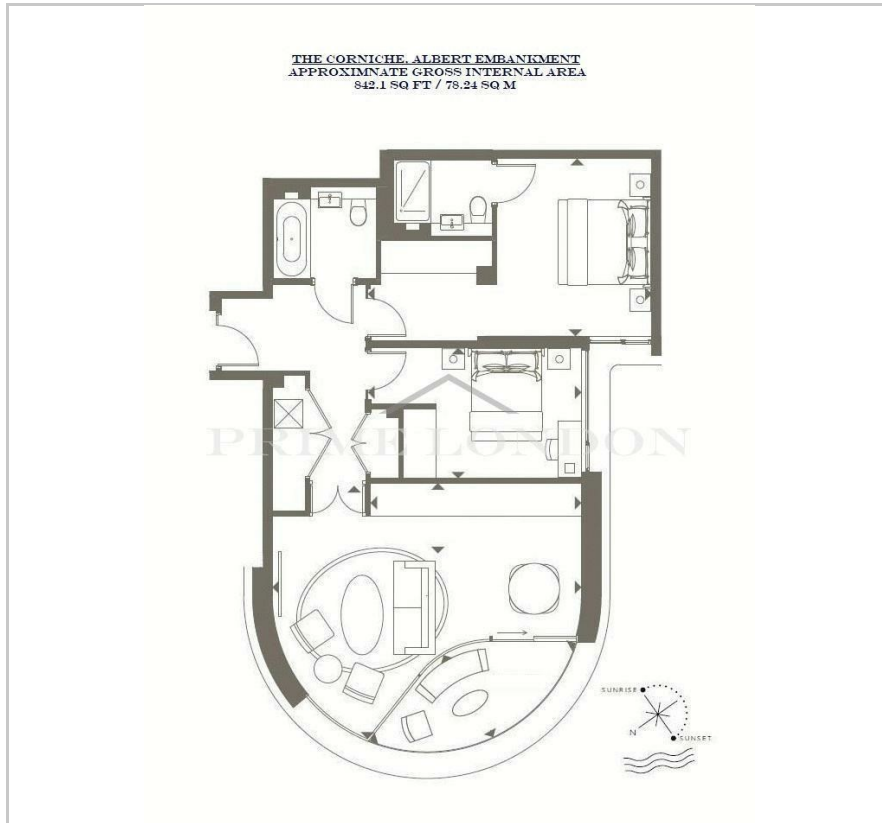

## Area Map

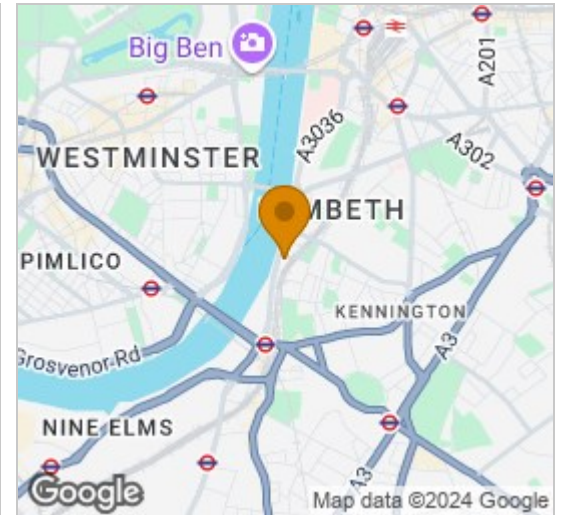

## Energy Efficiency Graph

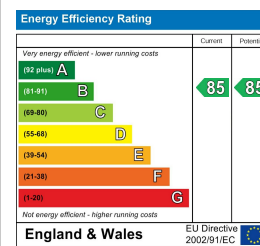

## Viewing

By appointment. Contact us on 0207 928 6663 if you wish to arrange a viewing appointment for this property, or require further information.

- River facing two bedroom ▪ Beautifully furnished apartment
- 842.1 sq ft (78.24 sqm) ▪ Views of the River Thames and Houses of Parliament
- Gym, spa, pool, and Sky ▪ 24 hour concierge Lounge

This luxurious and beautifully furnished two bedroom apartment, set in an excellent position facing the River Thames, is available to rent through Prime London in The Corniche, 24 Albert Embankment.

Located in an enviable position on the bank of the River Thames, The Corniche (designed by Foster & Partners) captures some of London's most exquisite views, not only the Houses of Parliament and the River Thames, but also the Tate Britain, London Eye and the City.

The development includes extensive residents facilities including a gym, spa, swimming pool, cinema and bowling alley as well as a residents' club and bar with stunning roof terrace overlooking Big Ben and the Houses of Parliament.



These particulars, whilst believed to be accurate are set out as a general outline only for guidance and do not constitute any part of an offer or contract. Intending purchasers should not rely on them as statements of representation of fact, but must satisfy themselves by inspection or otherwise as to their accuracy. No person in this firm's employment has the authority to make or give any representation or warranty in respect of the property.