

## Murray House

3 Vandon Street, Westminster, SW1H 0AE

£550 Per Week





## Floor Plan

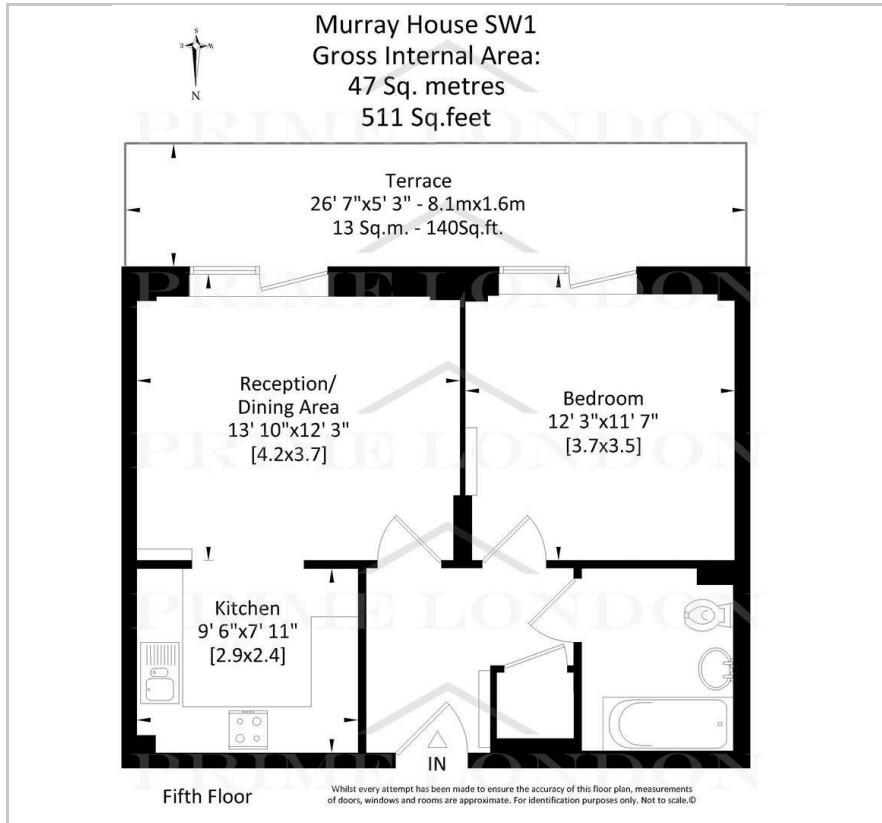

## Area Map



## Energy Efficiency Graph

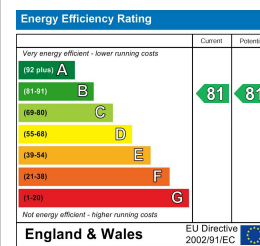

## Viewing

By appointment. Contact us on 0207 928 6663 if you wish to arrange a viewing appointment for this property, or require further information.

- Bright and spacious
- Large private terrace
- 511 sq ft (47 sqm) internally
- Centrally located



A bright and spacious one bedroom apartment, set on the top floor (with lift) of this superbly located building in the heart of Westminster, available for rent through Prime London.

This modern apartment has a large bright bedroom with storage, spacious reception area, and a large private terrace running along the front of the property providing ample natural light. There is also a modern, newly installed, bathroom and spacious kitchen.

The property benefits from being centrally located in Westminster, just off Victoria Street, and is surrounded by shops, bars, restaurants and Parks (St James's, Green Park and Hyde Park are all within 2-10 mins walk).

It also gives easy access to the rest of the city - 100m from St James's Park station and 5 minutes from Victoria tube (Circle, District or Victoria lines) or Westminster tube (Circle, District or Jubilee) stations. Any resident will have easy access to some of the capital's best known historic sights - including Buckingham Palace (2 mins walk), the Houses of Parliament and Westminster Abbey.



These particulars, whilst believed to be accurate are set out as a general outline only for guidance and do not constitute any part of an offer or contract. Intending purchasers should not rely on them as statements of representation of fact, but must satisfy themselves by inspection or otherwise as to their accuracy. No person in this firm's employment has the authority to make or give any representation or warranty in respect of the property.