



4 Whitehall Court

Westminster, SW1A 2EP

£1,650 Per Week



3 3 2 D

Floor Plan

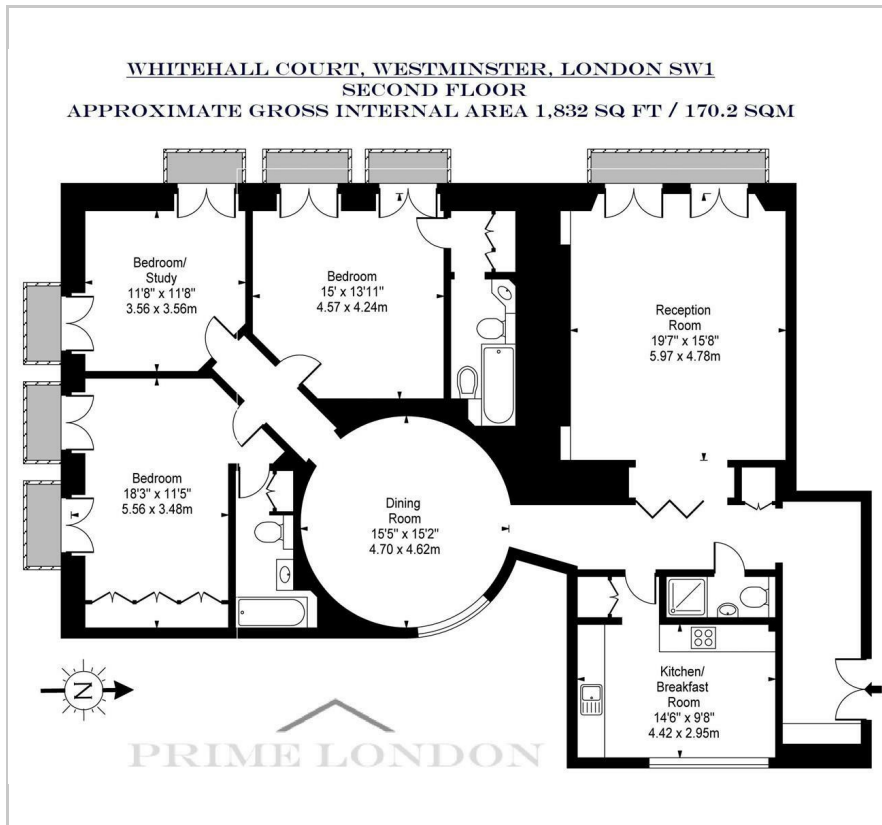

Area Map



Energy Efficiency Graph

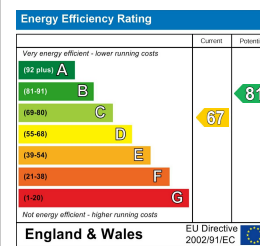

Viewing

By appointment. Contact us on 0207 052 1075 if you wish to arrange a viewing appointment for this property, or require further information.

- Unique lateral three bedroom apartment
- Seven stone balconies
- Overlooking Horseguards and the London Eye
- One of Westminster's most iconic buildings
- 24 hour portorage

A unique lateral three bedroom apartment on the second floor of this elegant building, with seven individual stone balconies and floor to ceiling French windows, overlooking Horseguards and the London Eye.

Tucked away on one of the most prestigious streets in Westminster, Whitehall Court is fabulously positioned. The apartments were built in mid 1880s, AND its grand stature, white Portland stone and highly desirable location have made it one of Westminster's most iconic buildings.

It further features an impressive lobby with 24 portorage, lift to all floors and a connected to the Royal Horseguards Hotel and the Farmers Club.

Transport links include Embankment tube station (Northern, Bakerloo, Circle, District lines), and two mainline stations (Charing Cross, Waterloo). The West End is easily accessible as are the Royal Festival Hall on the South bank.



These particulars, whilst believed to be accurate are set out as a general outline only for guidance and do not constitute any part of an offer or contract. Intending purchasers should not rely on them as statements of representation of fact, but must satisfy themselves by inspection or otherwise as to their accuracy. No person in this firm's employment has the authority to make or give any representation or warranty in respect of the property.