



## Whitehouse Apartments

9 Belvedere Road, Southbank, SE1 8YP

£900 Per Week





Floor Plan

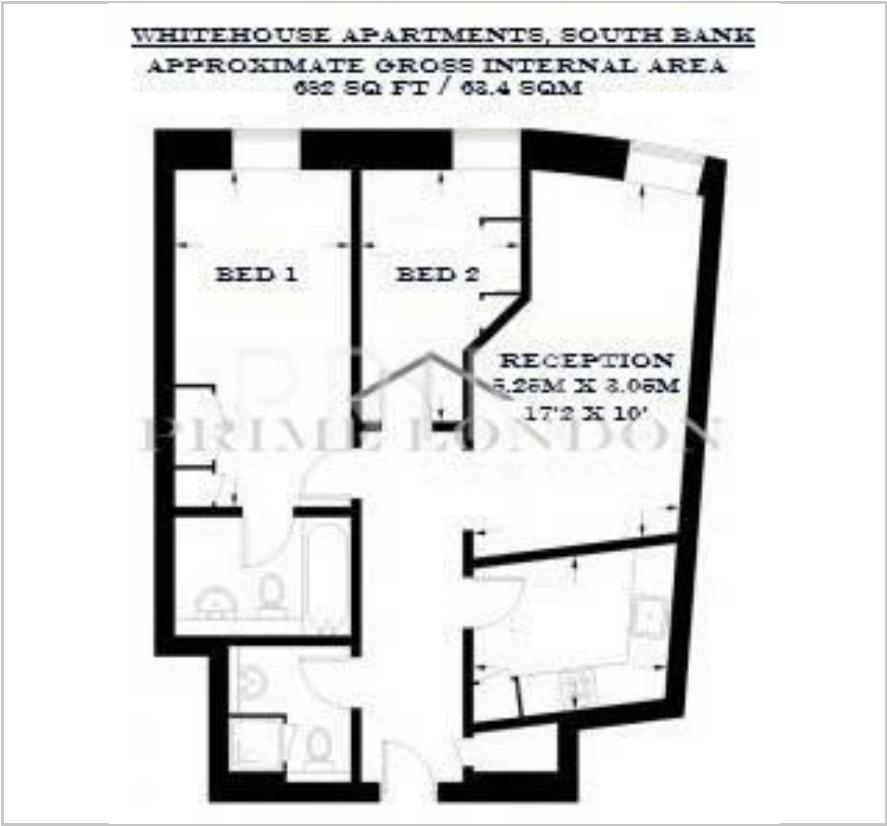

Area Map



Energy Efficiency Graph

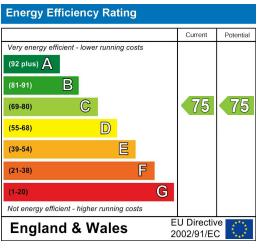

Viewing

By appointment. Contact us on 0207 928 6663 if you wish to arrange a viewing appointment for this property, or require further information.

- Two bedroom two bathroom
- Furnished
- Facing towards the Royal Festival Hall
- Fully equipped gymnasium, heated swimming pool, steam room and sauna
- Residents' roof terrace
- 24 hour concierge



Available from mid August, this front facing two bedroom apartment, with peaceful views towards the Royal Festival Hall, is available to rent through Prime London. The property also comes with a secure parking space and a separate storage unit.

The apartment offers a spacious reception room, fully fitted separate kitchen, two bedrooms (primary with en suite), and separate shower room.

Additionally, residents enjoy exclusive access to the spa and fitness centre complete with fully equipped gymnasium, heated swimming pool, steam room and sauna. The Whitehouse Apartments further features a 24 hour concierge service and communal roof terrace.

Positioned moments from the South Bank, the location offers an array of some of London's finest cultural attractions, restaurants, cafes and shops. Nearby Waterloo station provides superb transport links via the Bakerloo, Jubilee, Northern and Waterloo & City lines.



These particulars, whilst believed to be accurate are set out as a general outline only for guidance and do not constitute any part of an offer or contract. Intending purchasers should not rely on them as statements of representation of fact, but must satisfy themselves by inspection or otherwise as to their accuracy. No person in this firms employment has the authority to make or give any representation or warranty in respect of the property.