



The Tower

One St George Wharf, SW8 2DA

Asking Price £1,600,000



Floor Plan

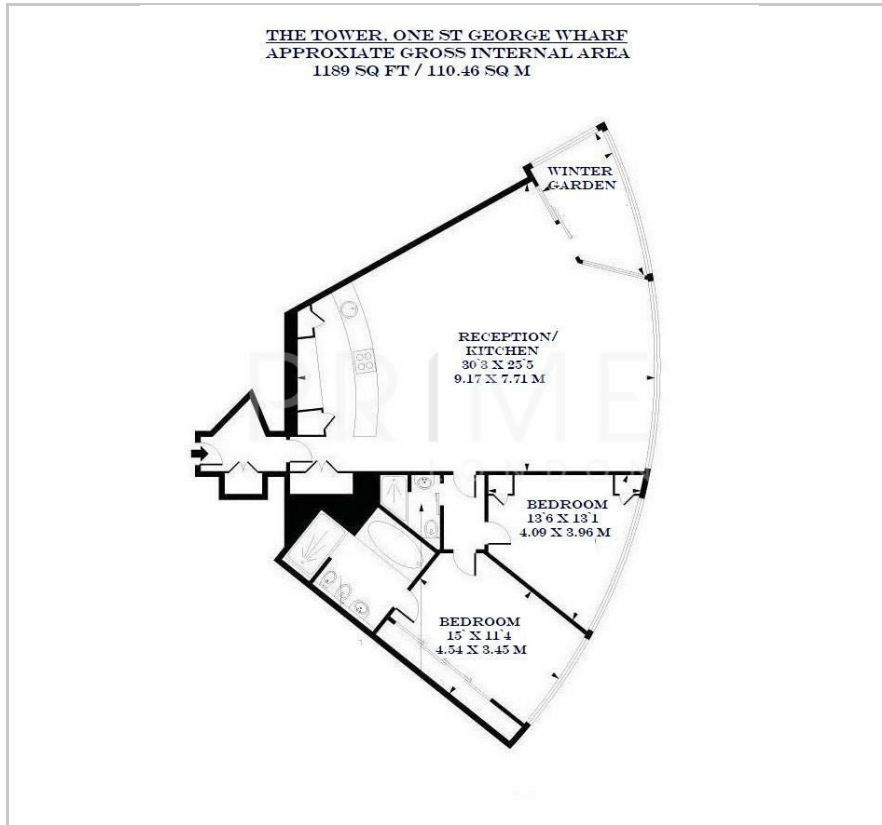

Area Map

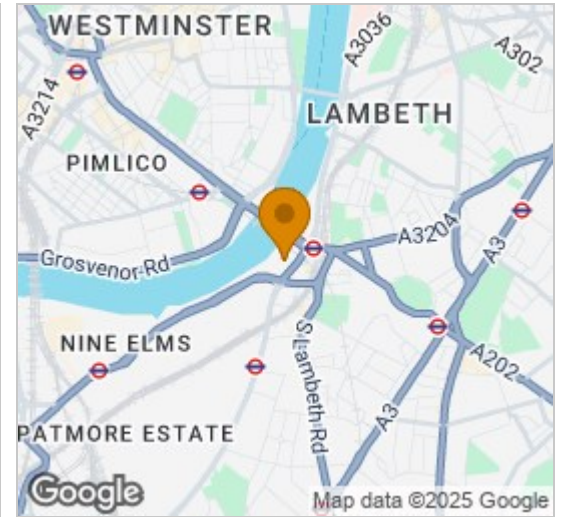

Energy Efficiency Graph



Viewing

By appointment. Contact us on 0207 928 6663 if you wish to arrange a viewing appointment for this property, or require further information.

- Elite edition two bedroom ▪ 1,189 sq ft (110 sqm) apartment
- Chain free and EWS1 ▪ Front door concierge with compliant valet parking
- Gym, pool and sauna ▪ Private Cinema, riverside bars and restaurants

With an excellent panorama south-west facing and extensive lateral space totalling some 1,189 sq ft (110.46 sqm), this bright and luxurious two bedroom apartment with views of the River Thames is available for chain free sale through Prime London. The property also comes with a valet parking spaces, which is rare for the development.

The apartment offers a fully integrated kitchen with Miele appliances, high specification bathrooms with exquisite tiling and additional fittings such as a handheld bidet sprayer, comfort cooling, touch panel controls, recessed lighting and automated winter garden.

Amenities include front door concierge, first floor gym, pool and sauna facilities as well as a private cinema.

St George Wharf offers on site riverside bars and restaurants such as Waterfront London, The Riverside, Four Degree and Pop Art Sushi as well as direct access to Vauxhall Underground Station on the Victoria Line. For additional convenience other on site outlets include Tesco Express, Pret a Manger, Hudson's Dry Cleaners, Riverside Medical Centre & Dental Spa and more.



These particulars, whilst believed to be accurate are set out as a general outline only for guidance and do not constitute any part of an offer or contract. Intending purchasers should not rely on them as statements of representation of fact, but must satisfy themselves by inspection or otherwise as to their accuracy. No person in this firm's employment has the authority to make or give any representation or warranty in respect of the property.