



## Drake House

76 Marsham Street, London, SW1P 4LY

£1,846 Per Week



## Floor Plan

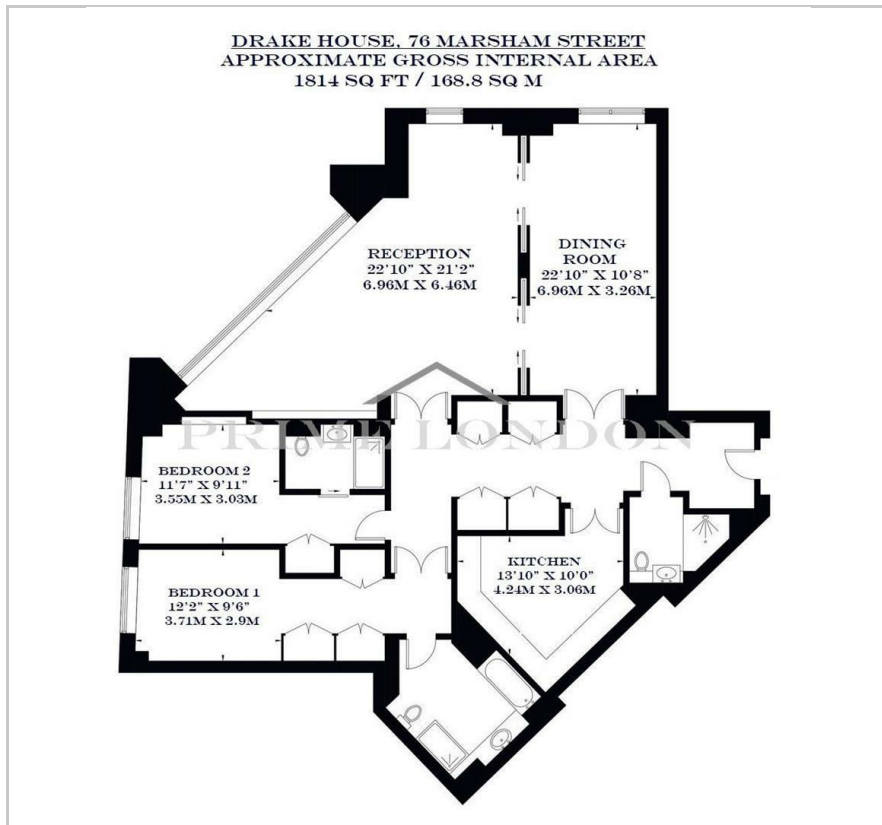

## Area Map



## Energy Efficiency Graph

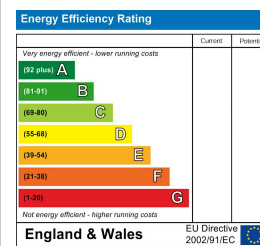

## Viewing

By appointment. Contact us on 0207 052 1075 if you wish to arrange a viewing appointment for this property, or require further information.

- One/Two reception rooms
- Two/Three double bedrooms
- Three bathrooms
- Fully furnished
- Prestigious Westminister building
- 24 hour concierge service building



A superbly interior-designed home of tremendous style and taste, with perfectly proportioned living accommodation, is available to rent through Prime London. This property includes one/two receptions, two/three double bedrooms, three exceptionally stylish bathrooms, an ultra-modern kitchen, and high ceilings throughout.

This impressive apartment is situated within a prestigious Westminister building, featuring a luxurious entrance lobby with a seating area for guests and a 24-hour concierge service. Located on Marsham Street, right in the heart of Westminister, it offers direct access to parliamentary buildings such as the Houses of Parliament and Westminister Abbey.

Residents will enjoy easy access to the green open spaces of St James's Park and Green Park, as well as the transport links at Victoria station (Victoria, District, and Circle lines, National Rail, and the Gatwick Express). The nearby Westminister underground station provides the Jubilee line, offering a swift ride to Canary Wharf. Pimlico and the numerous shops and restaurants on Horseferry Road and Victoria Street are all within easy reach.



These particulars, whilst believed to be accurate are set out as a general outline only for guidance and do not constitute any part of an offer or contract. Intending purchasers should not rely on them as statements of representation of fact, but must satisfy themselves by inspection or otherwise as to their accuracy. No person in this firm's employment has the authority to make or give any representation or warranty in respect of the property.