



## Ebury Apartments

1B Sutherland Street, Victoria, SW1V 4BF

£1,345,000



3



2



1



B

## Floor Plan

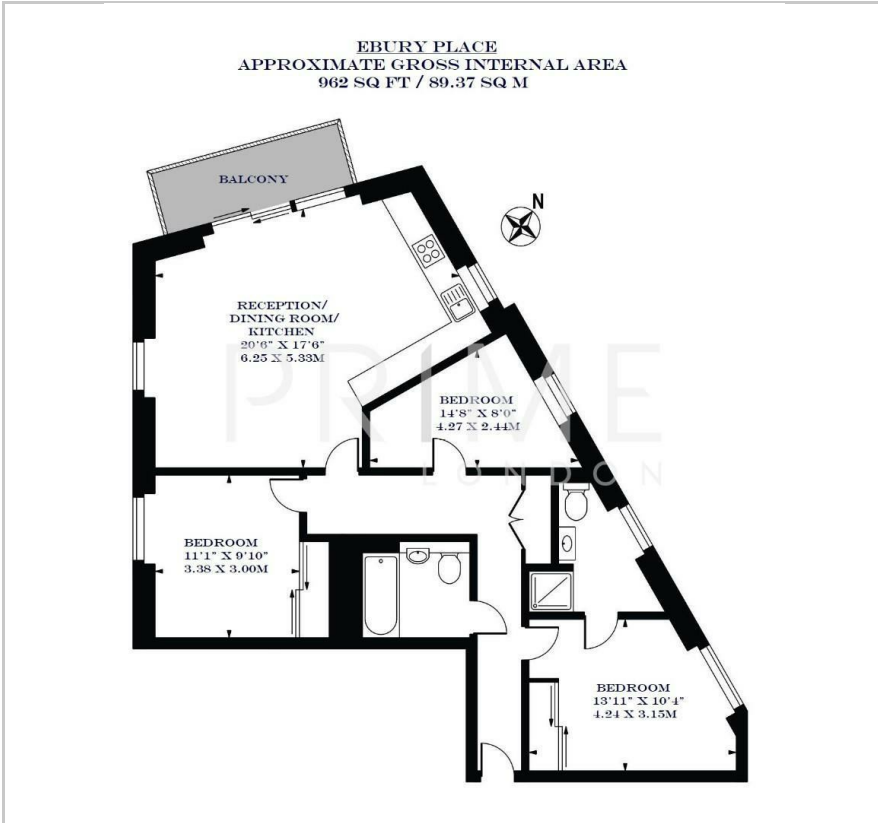

## Area Map



## Energy Efficiency Graph



## Viewing

By appointment. Contact us on 0207 052 1075 if you wish to arrange a viewing appointment for this property, or require further information.

- 3 bedroom apartment
- 962 sqft / 89.37 sqm
- 24 hour concierge
- Located near Victoria station



This stunning three-bedroom apartment with 962 sqft / 89.37 sqm of space in the modern Ebury Apartments development is available for chain free sale through prime London.

Situated in the heart of Pimlico, within the City of Westminster, this apartment embodies luxury living in one of London's most sought-after locations. The apartment is bathed in natural light and features a private terrace, comfort cooling, underfloor heating, modern bathrooms, and an open-plan kitchen.

Residents also enjoy the benefits of a 24-hour concierge, a stylish lobby, communal gardens, and secure bike storage.

Located in the heart of Westminster, close to restaurants, shops and the easy connections that come with Zone 1 living. This is a prime central London location renowned for its culture and creativity with the world-class art gallery, Tate Britain, and many of the capital's most iconic and historic landmarks just a short walk away.



These particulars, whilst believed to be accurate are set out as a general outline only for guidance and do not constitute any part of an offer or contract. Intending purchasers should not rely on them as statements of representation of fact, but must satisfy themselves by inspection or otherwise as to their accuracy. No person in this firm's employment has the authority to make or give any representation or warranty in respect of the property.