



Carrington House

Hertford Street, Mayfair, W1J 7RG

£1,100 Per Week

Floor Plan

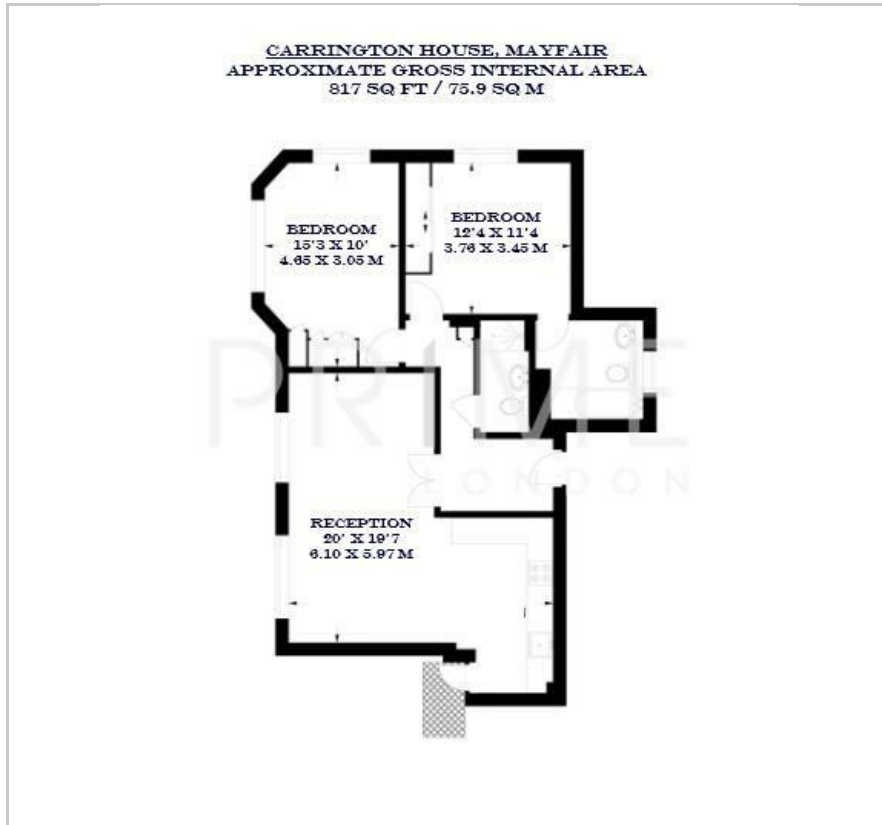

Area Map



Energy Efficiency Graph

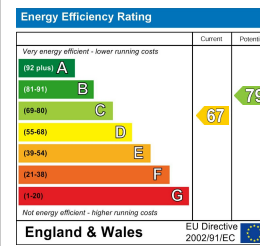

Viewing

By appointment. Contact us on 0207 052 1075 if you wish to arrange a viewing appointment for this property, or require further information.

- Two bedroom apartment
- Juliet balcony
- Just 0.2 miles to Green Park station
- 817 sq ft (75.9 sqm)
- Moments away from Hyde Park and Park Lane
- Lift and porter services

This beautifully presented two-bedroom apartment, located in an elegant period building in the heart of Mayfair, is available for lease through Prime London.

Spanning approximately 817 sq ft (75.9 sqm), the apartment boasts an inviting reception room, and the modern open-plan kitchen is equipped with sleek, integrated appliances.

The main bedroom is generously sized and features an en suite bathroom. The second bedroom is bright and airy, complete with a Juliet balcony, providing a charming outlook and additional light. There is also an additional bathroom.

Residents will also benefit from lift access, as well as porter services.

Carrington House is ideally situated moments away from the high-end shops and world-class restaurants of Piccadilly and the renowned Park Lane. With Hyde Park just a short stroll away, residents can enjoy the perfect serene green spaces.



These particulars, whilst believed to be accurate are set out as a general outline only for guidance and do not constitute any part of an offer or contract. Intending purchasers should not rely on them as statements of representation of fact, but must satisfy themselves by inspection or otherwise as to their accuracy. No person in this firm's employment has the authority to make or give any representation or warranty in respect of the property.