



## Parliament View Apartments

1 Albert Embankment, SE1 7XL

£530 Per Week





## Floor Plan

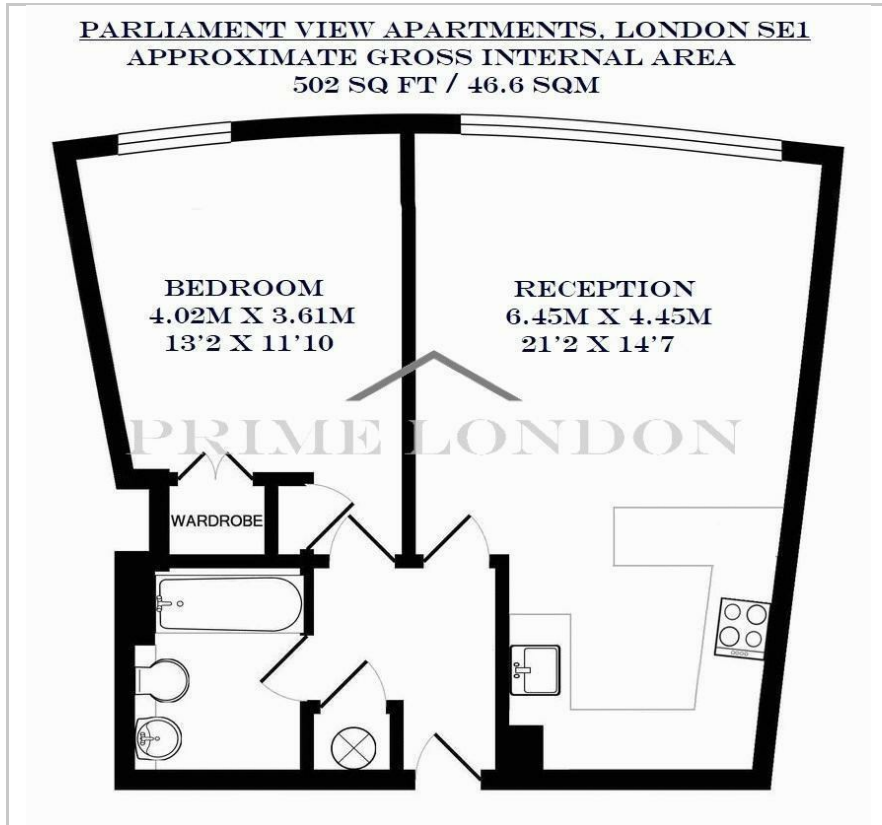

## Area Map



## Energy Efficiency Graph

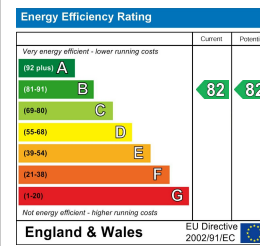

## Viewing

By appointment. Contact us on 0207 928 6663 if you wish to arrange a viewing appointment for this property, or require further information.

- Modern one bed of over 500 sq ft
- Fully furnished
- Air cooling
- Residents' gymnasium
- Parking available by separate negotiation
- 24 hour concierge service



A bright and modern apartment of over 500 sq ft in Parliament View Apartments, available for lease through Prime London.

The apartment comprises a bright reception, open-plan kitchen, master bedroom with integrated storage, separate bathroom, wooden flooring and air cooling. Parking available by separate negotiation.

Parliament View itself offers a 24 hour concierge service, residents' gymnasium and an excellent location on the river between Lambeth and Vauxhall Bridge. As a result the development is within easy reach of the West End, Westminster, the City and South Bank. Vauxhall rail and underground station.



These particulars, whilst believed to be accurate are set out as a general outline only for guidance and do not constitute any part of an offer or contract. Intending purchasers should not rely on them as statements of representation of fact, but must satisfy themselves by inspection or otherwise as to their accuracy. No person in this firm's employment has the authority to make or give any representation or warranty in respect of the property.