



39 Hill Street

Mayfair, London, W1J 5LZ

£630 Per Week



Floor Plan

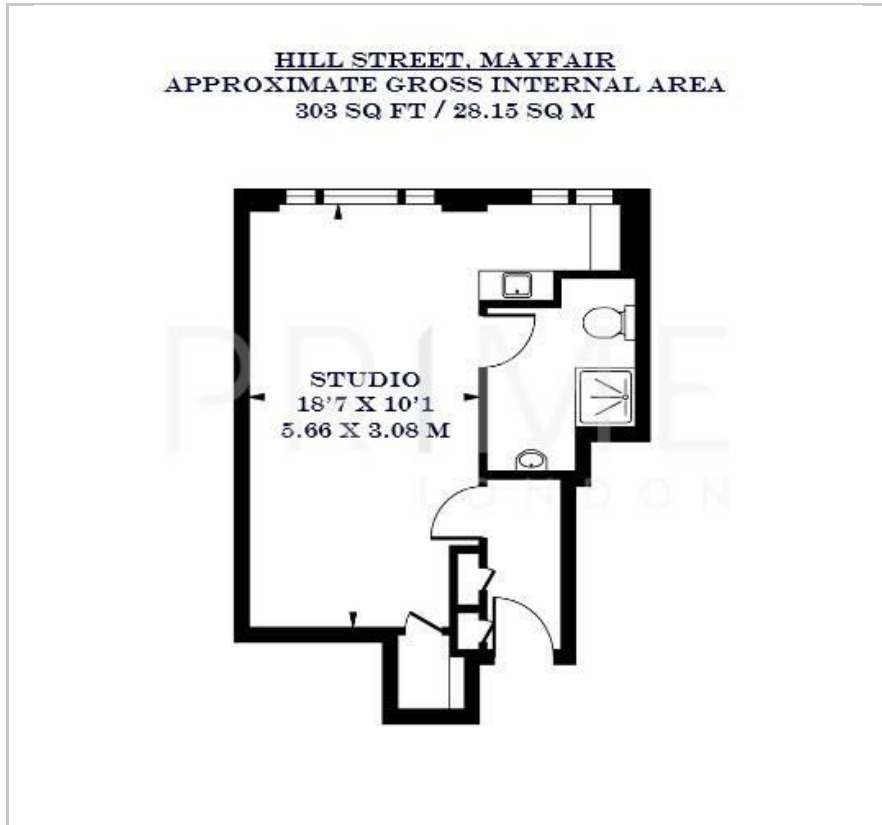

Area Map



Energy Efficiency Graph

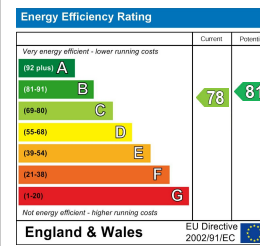

Viewing

By appointment. Contact us on 0207 052 1075 if you wish to arrange a viewing appointment for this property, or require further information.

- Studio apartment
- Contemporary finishes
- Just 0.3 miles to Green Park station
- 303 sq ft (28.15 sqm)
- In the vibrant Mayfair district
- On-site building manager and communal gardens



This contemporary studio apartment, nestled in the vibrant Mayfair district of London, is available for lease through Prime London.

Spanning 303 sq ft (28.15 sqm), the property boasts a generous studio room with space for dining, one bathrooms with sleek finishes, and a fully integrated kitchen.

Residents benefit from the convenience of an on-site building manager, elevator service and communal gardens.

Hill Street is located in one of London's most prestigious neighborhoods, just east of Hyde Park and north of Piccadilly. It is adjacent to the iconic Berkeley Square and is within close proximity to a variety of amenities, dining options, and flagship designer boutiques on Mount Street, New Bond Street, South Molton Street, and the surrounding areas.

Local transportation options include Green Park (Piccadilly, Victoria, and Jubilee lines), situated 0.3 miles from the property, and Bond Street (Central and Jubilee lines), situated 0.5 miles from the property.



These particulars, whilst believed to be accurate are set out as a general outline only for guidance and do not constitute any part of an offer or contract. Intending purchasers should not rely on them as statements of representation of fact, but must satisfy themselves by inspection or otherwise as to their accuracy. No person in this firm's employment has the authority to make or give any representation or warranty in respect of the property.