



10 Park Drive

Canary Wharf, London, E14 9GD

£634 Per Week



Floor Plan

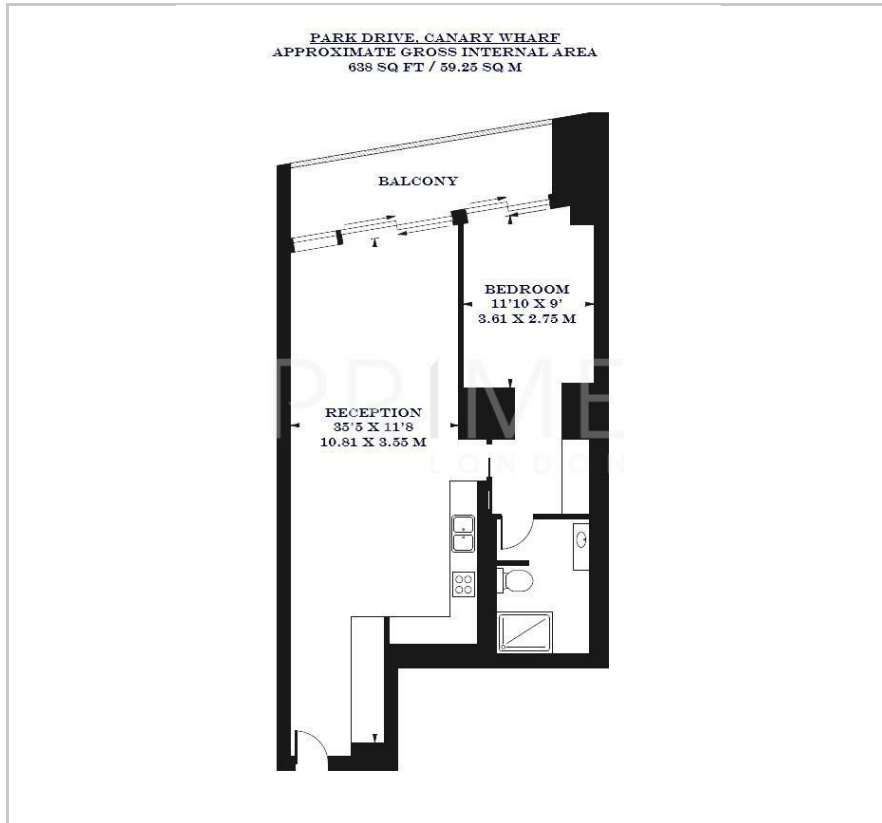

Area Map



Energy Efficiency Graph



Viewing

By appointment. Contact us on 0207 052 1075 if you wish to arrange a viewing appointment for this property, or require further information.

- Large one bed with private balcony with dock views
- 24 hour concierge
- Fitness club with gym, pool, Jacuzzi, sauna, and yoga studio
- Comfort cooling and underfloor heating
- Furnished - Available Now!

Presenting a beautifully furnished one-bedroom apartment to let at 10 Park Drive, Canary Wharf, with superb dock views and a generous private balcony, ideal for enjoying the tranquil waterfront.

This contemporary apartment offers an open-plan living space with floor-to-ceiling windows, filling the room with natural light. The sleek kitchen is fitted with high-spec appliances, perfect for those who enjoy cooking and entertaining.

Ready for immediate occupancy, this property provides a straightforward move-in for discerning tenants.

Residents benefit from exceptional amenities located directly opposite, including a state-of-the-art health and fitness club with a swimming pool, gym, jacuzzi, sauna, steam rooms, and a dedicated studio for Pilates, yoga, and other fitness classes. Private treatment rooms are also available for a range of therapies.

Additional features include a 24-hour concierge, secure bike storage, and a stylish residents' lounge, making this apartment ideal for those seeking a luxurious lifestyle with convenient access to Canary Wharf's retail, dining, and transport links.



These particulars, whilst believed to be accurate are set out as a general outline only for guidance and do not constitute any part of an offer or contract. Intending purchasers should not rely on them as statements of representation of fact, but must satisfy themselves by inspection or otherwise as to their accuracy. No person in this firm's employment has the authority to make or give any representation or warranty in respect of the property.