



## Sky Gardens

143-161 Wandsworth Road, London, SW8 2LY

Asking Price £599,950



## Floor Plan

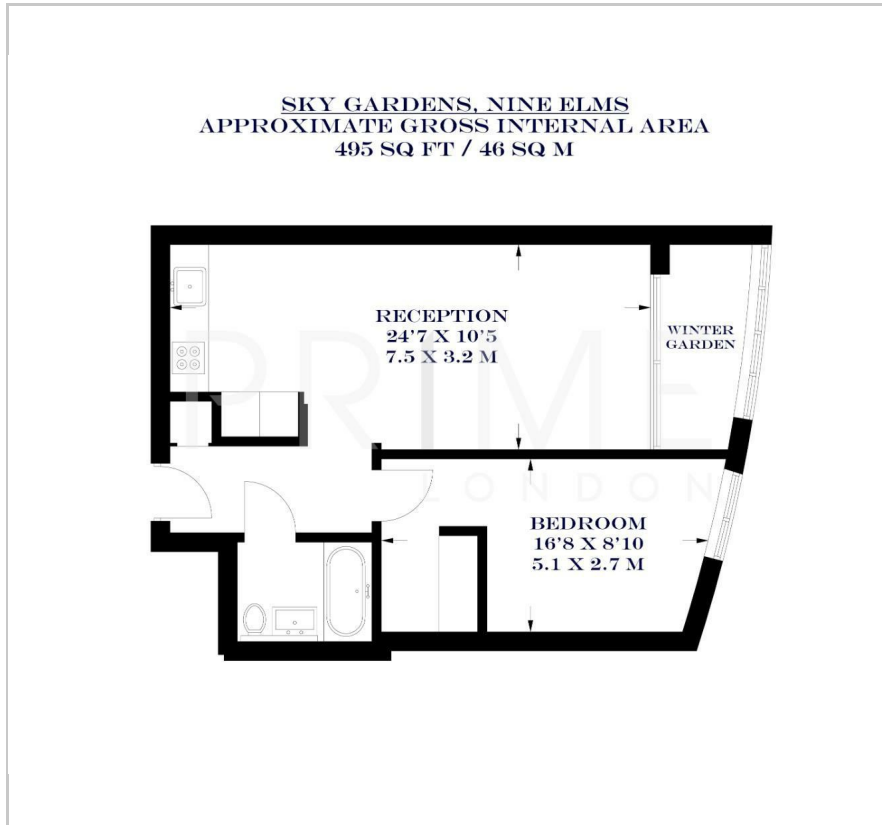

## Area Map

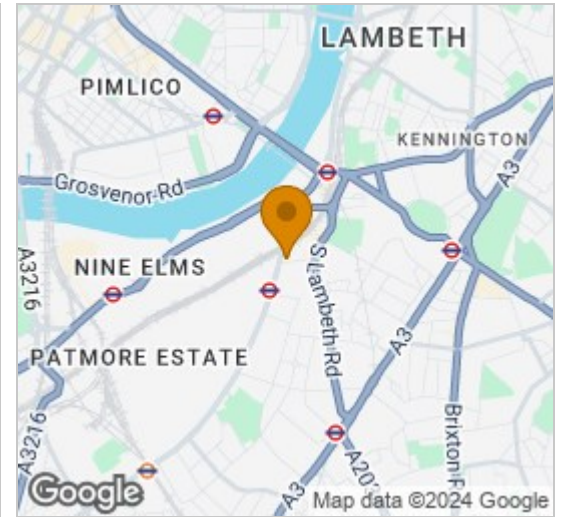

## Energy Efficiency Graph

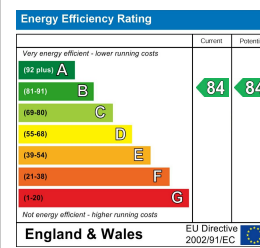

## Viewing

By appointment. Contact us on 0207 928 6663 if you wish to arrange a viewing appointment for this property, or require further information.

- One bedroom apartment
- Views of London's skyline
- Short walk to amenities of St George's Wharf
- 495 sq ft (46 sqm)
- Resident's gym and terrace
- 24 hour concierge

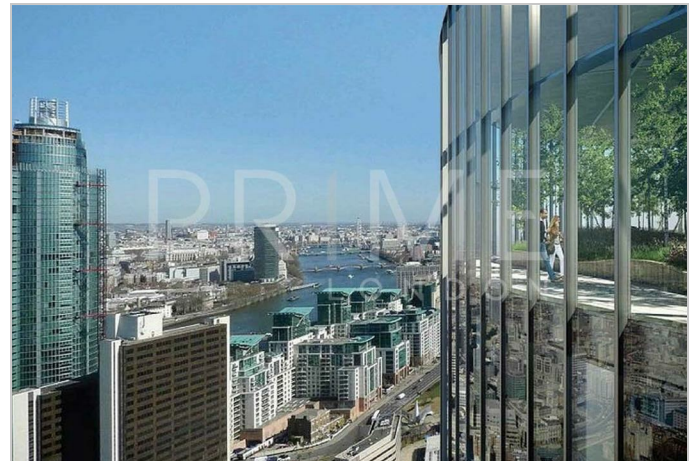

This bright one-bedroom apartment, located in the highly sought-after Sky Gardens development in Nine Elms, is available for sale chain-free through Prime London.

Spanning 495 sq ft (46 sqm), the property features an open-plan reception area with a fully-fitted kitchen, leading to a spacious winter garden, as well as a generous bedroom and bathroom. The apartment is equipped with comfort cooling and underfloor heating.

Sky Gardens residents enjoy access to a state-of-the-art gym on the eighth floor, a 24-hour concierge, and a rooftop garden on the thirty-fourth floor.

The development is conveniently located near Vauxhall's transport options, including rail, tube, bus, and river taxi services. Nearby amenities include Waitrose, Sainsbury's, Argos, Starbucks, and a variety of restaurants at St George Wharf.



These particulars, whilst believed to be accurate are set out as a general outline only for guidance and do not constitute any part of an offer or contract. Intending purchasers should not rely on them as statements of representation of fact, but must satisfy themselves by inspection or otherwise as to their accuracy. No person in this firm's employment has the authority to make or give any representation or warranty in respect of the property.