



Clement House

190 Strand, WC2R 1AB

£3,500 Per Week



3



3



1



B

Floor Plan

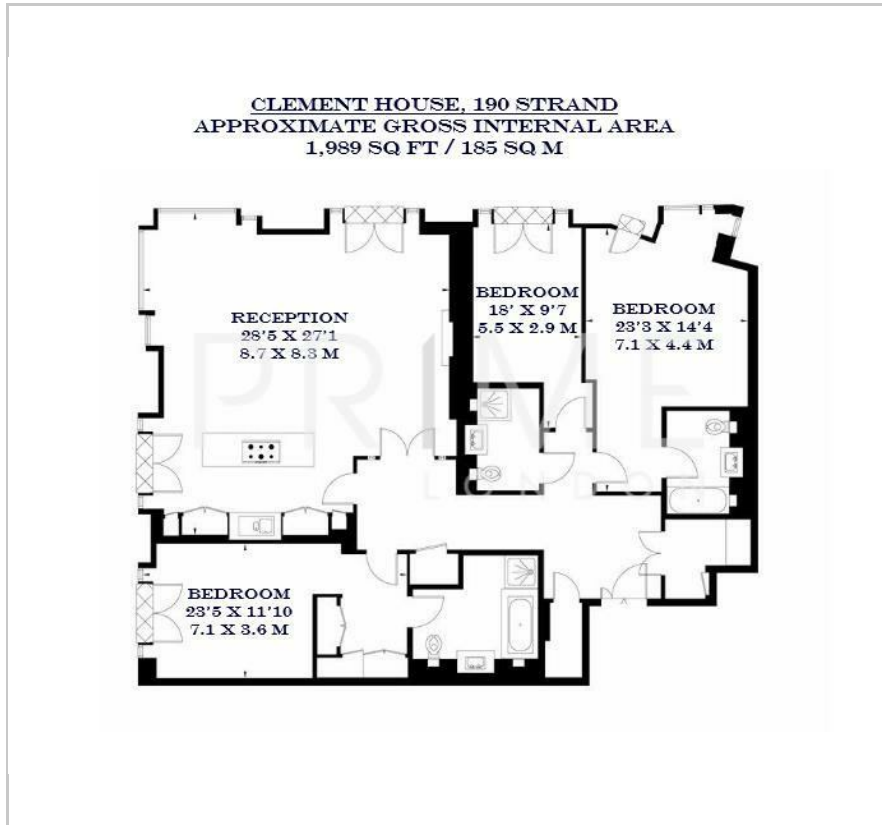

Area Map

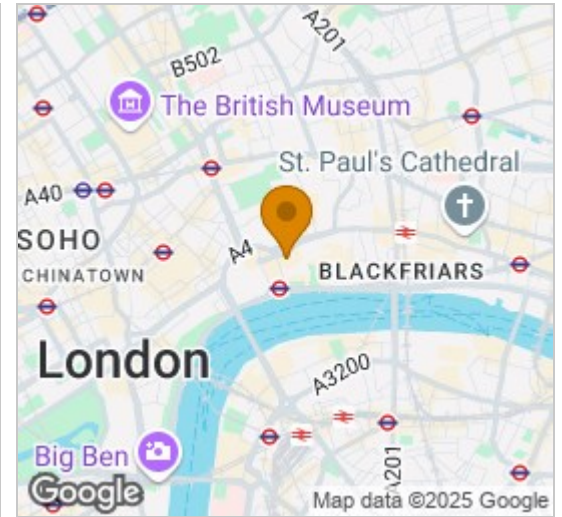

Energy Efficiency Graph

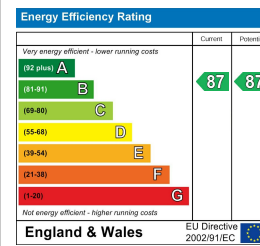

Viewing

By appointment. Contact us on 0207 052 1075 if you wish to arrange a viewing appointment for this property, or require further information.

- Three bedroom apartment ▪ 1,989 sq ft (185 sqm)
- Short walk from the famous Covent Garden Piazza ▪ Resident's gym, spa/sauna, pool and golf simulator
- Just 0.1 miles to Temple ▪ 24 hour concierge station



This beautiful three-bedroom apartment, located in 190 Strand, one of Covent Garden's most prestigious developments, is available for lease through Prime London.

Totalling 1,989 sq ft (185 sqm), the apartment boasts a spacious open-plan living area, seamlessly blending with a bespoke modern kitchen. The master bedroom features a dressing area and a fully tiled en-suite bathroom. In addition, there are two more generously sized double bedrooms, complemented by a second fully tiled family bathroom.

This luxurious residence offers an array of top-tier amenities, including a concierge service, gym, sauna, golf simulator, and swimming pool.

190 Strand is just a short stroll from the iconic Covent Garden Piazza, providing access to a vibrant selection of shops, restaurants, bars, and theatres.

The location is exceptionally well-connected, with Temple Station (Circle & District lines) just 0.1 miles away, and Covent Garden Station (Piccadilly Line) only 0.5 miles from the development.



These particulars, whilst believed to be accurate are set out as a general outline only for guidance and do not constitute any part of an offer or contract. Intending purchasers should not rely on them as statements of representation of fact, but must satisfy themselves by inspection or otherwise as to their accuracy. No person in this firm's employment has the authority to make or give any representation or warranty in respect of the property.