

Woods House

Grosvenor Waterside, 7 Gatliff Road, SW1W 8DF

£577 Per Week

Floor Plan

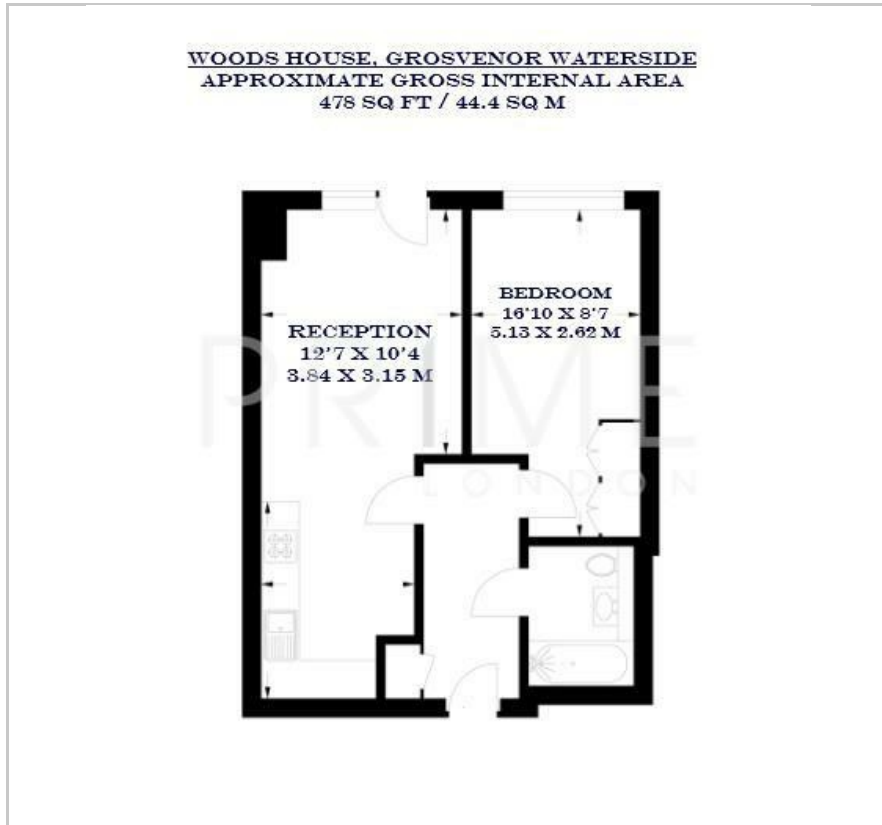

Area Map

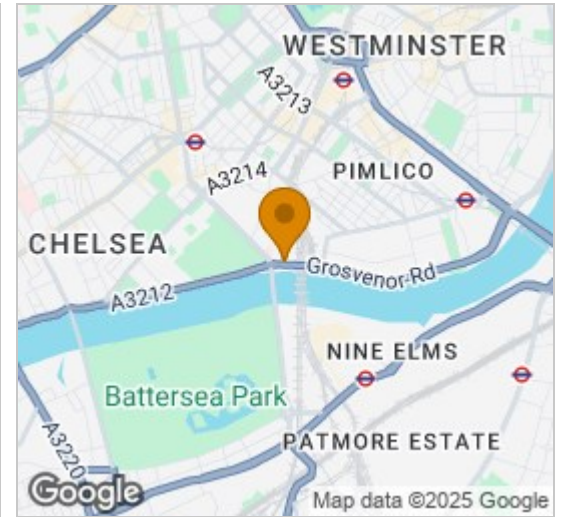

Energy Efficiency Graph

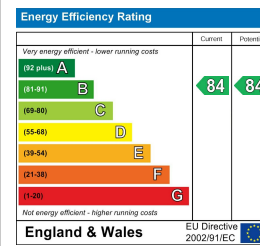

Viewing

By appointment. Contact us on 0207 052 1075 if you wish to arrange a viewing appointment for this property, or require further information.

- One bedroom apartment
- Fully furnished
- Short walk to Kings Road and Sloane Square
- 478 sq ft (44.4 sqm)
- Resident's gym, spa and on-site café
- 24 hour concierge

This one-bedroom apartment, located in the popular Grosvenor Waterside, is available for lease through Prime London.

Totalling 478 sq ft (44.4 sqm), the property features a bright reception room and an open-plan kitchen. The apartment includes a well-proportioned bedroom, a bathroom, and is fully furnished, making it ideal for contemporary living in one of London's most prestigious and evolving neighborhoods.

Located on the north side of the river near Chelsea Bridge, the open green spaces of Battersea Park are within easy reach.

The Victoria mainline and underground station (Victoria, Circle, and District lines, zone 1) is also close by. Grosvenor Waterside is only half a mile from Sloane Square underground station, with the stylish Kings Road within walking distance.

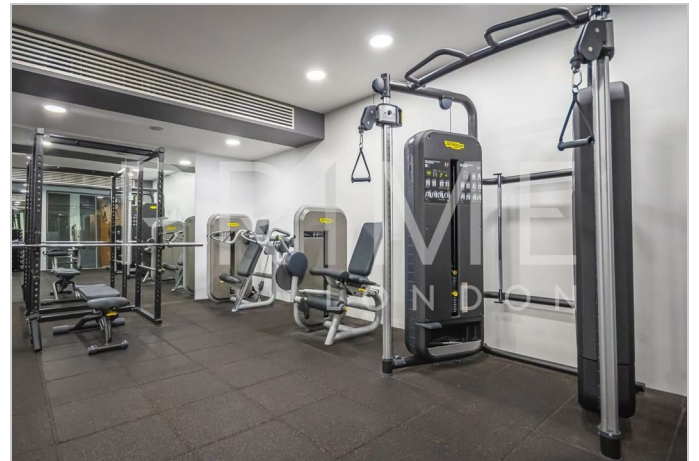

These particulars, whilst believed to be accurate are set out as a general outline only for guidance and do not constitute any part of an offer or contract. Intending purchasers should not rely on them as statements of representation of fact, but must satisfy themselves by inspection or otherwise as to their accuracy. No person in this firm's employment has the authority to make or give any representation or warranty in respect of the property.