

Principal Tower

2 Principal Place, Worship Street, EC2A 2FG

Asking Price £9,900,000



Floor Plan

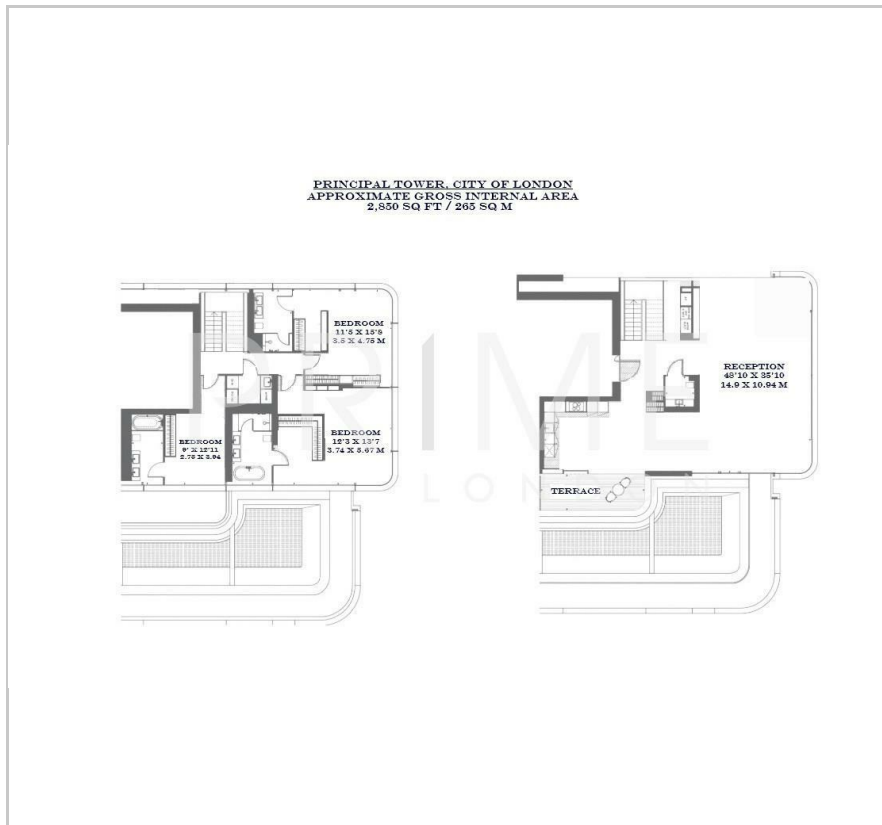

Area Map

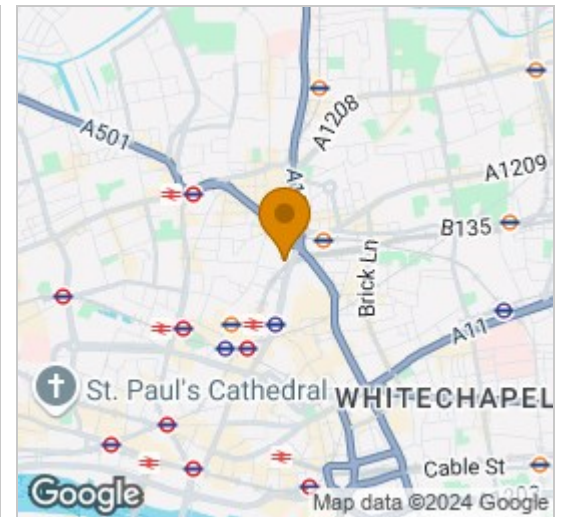

Energy Efficiency Graph

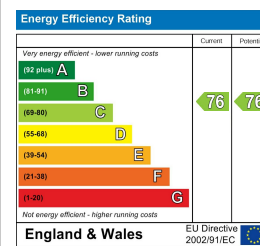

Viewing

By appointment. Contact us on 0207 052 1075 if you wish to arrange a viewing appointment for this property, or require further information.

- Exceptional three bedroom ▪ 2,850 sq ft (265 sqm) penthouse
- Triple aspect living and dining area ▪ Striking skyline views of London
- Residents' pool, spa, gym, cinema and lounge ▪ 24 hour concierge



This impressive 2,850 sq ft duplex penthouse, located in the renowned Principal Tower, is available for chain free sale through Prime London.

The spacious, triple-aspect living and dining area is paired with a modern open-plan kitchen, extending onto a private terrace, perfect for taking in the city views. A striking floating hardwood staircase connects the two floors and adds a distinctive design feature.

Upstairs, three ensuite bedrooms offer sweeping views across the city. The main and guest bedrooms include dual-aspect views and walk-in dressing rooms with wraparound wardrobes. The en-suite bathrooms are finished in Italian marble and feature dual vanities, walk-in showers, and bathtubs, creating a calm and elegant retreat.

Located moments from the City of London, this penthouse offers more than a home—it provides a lifestyle. With floor-to-ceiling glazing, this residence offers uninterrupted panoramic views of London's skyline, including Tower Bridge and St. Paul's Cathedral.

Residents enjoy exclusive amenities, including a 24 hour concierge, infinity pool, spa, sauna, gym overlooking the piazza, a cinema, and a residents' lounge.



These particulars, whilst believed to be accurate are set out as a general outline only for guidance and do not constitute any part of an offer or contract. Intending purchasers should not rely on them as statements of representation of fact, but must satisfy themselves by inspection or otherwise as to their accuracy. No person in this firm's employment has the authority to make or give any representation or warranty in respect of the property.