

Pullman Court

65 Drayton Gardens, Chelsea, SW10 9QZ

£1,846 Per Week



Floor Plan

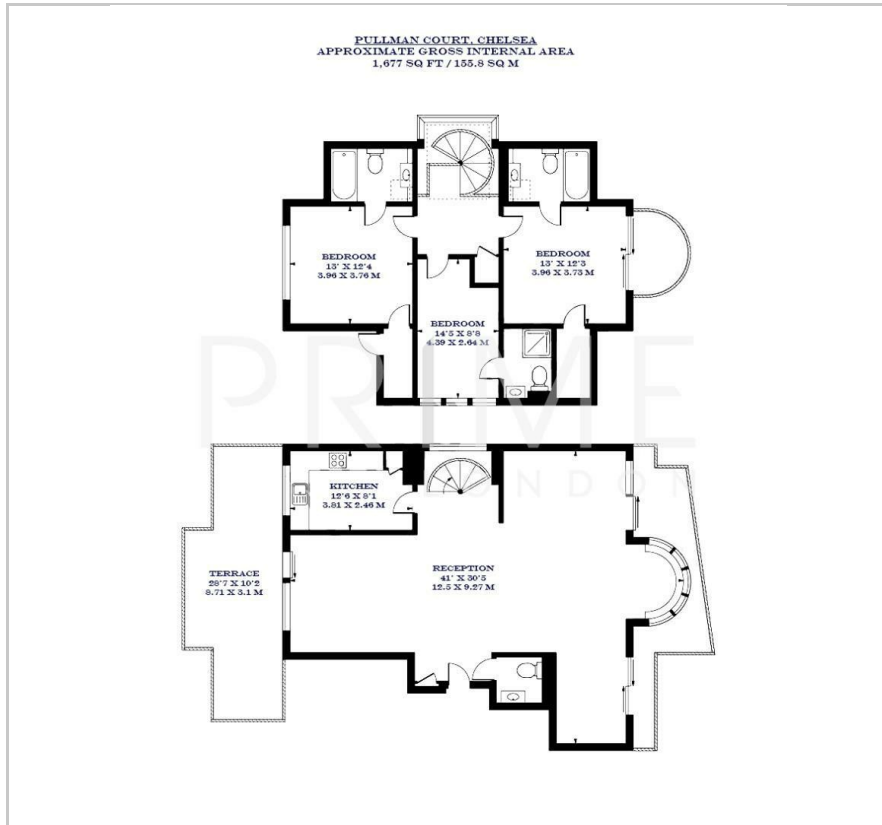

Area Map

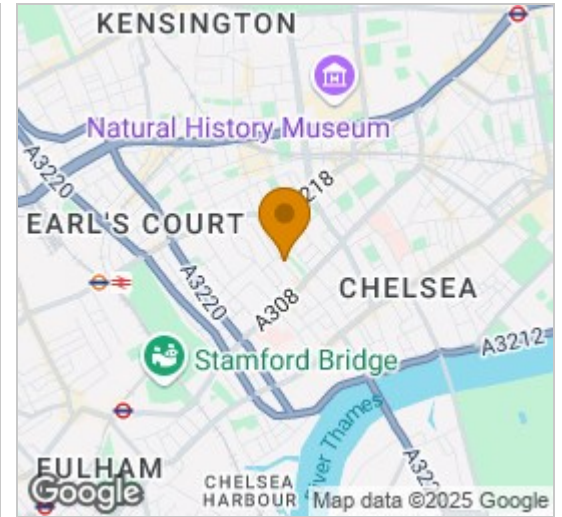

Energy Efficiency Graph

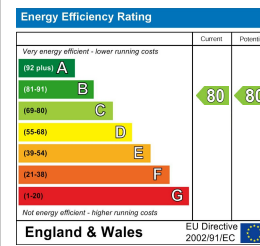

Viewing

By appointment. Contact us on 0207 052 1075 if you wish to arrange a viewing appointment for this property, or require further information.

- Three bedroom penthouse ■ 1,677 sq ft (155.8 sqm) apartment
- Prime Chelsea location ■ Expansive terrace and two balconies
- Modern, refurbished kitchen ■ Private parking



This stunning three-bedroom duplex apartment, located in the highly desirable Pullman Court within the heart of Chelsea, is available for lease through Prime London.

Spanning 1,677 sq ft (155.8 sqm), the property boasts an abundance of natural light, exceptional living space, and a private roof terrace perfect for entertaining.

The upper floor features three generously sized bedrooms, each with an ensuite bathroom. Two of the bedrooms also include walk-in closets, offering ample storage space. The lower floor features two expansive open-plan reception areas, each leading to private balconies. The sleek, recently refurbished kitchen is both stylish and functional, complemented by a convenient guest WC.

Pullman Court is positioned on Drayton Gardens, one of Chelsea's most prestigious residential streets. It is moments away from Fulham Road's vibrant shops, restaurants, and cafes.

South Kensington Tube Station is only a short walk away, providing excellent transport links via the District and Piccadilly Lines.



These particulars, whilst believed to be accurate are set out as a general outline only for guidance and do not constitute any part of an offer or contract. Intending purchasers should not rely on them as statements of representation of fact, but must satisfy themselves by inspection or otherwise as to their accuracy. No person in this firm's employment has the authority to make or give any representation or warranty in respect of the property.