

## Bramah House

9 Gatliff Road, Grosvenor Waterside, SW1W 8DQ

£1,000 Per Week



## Floor Plan

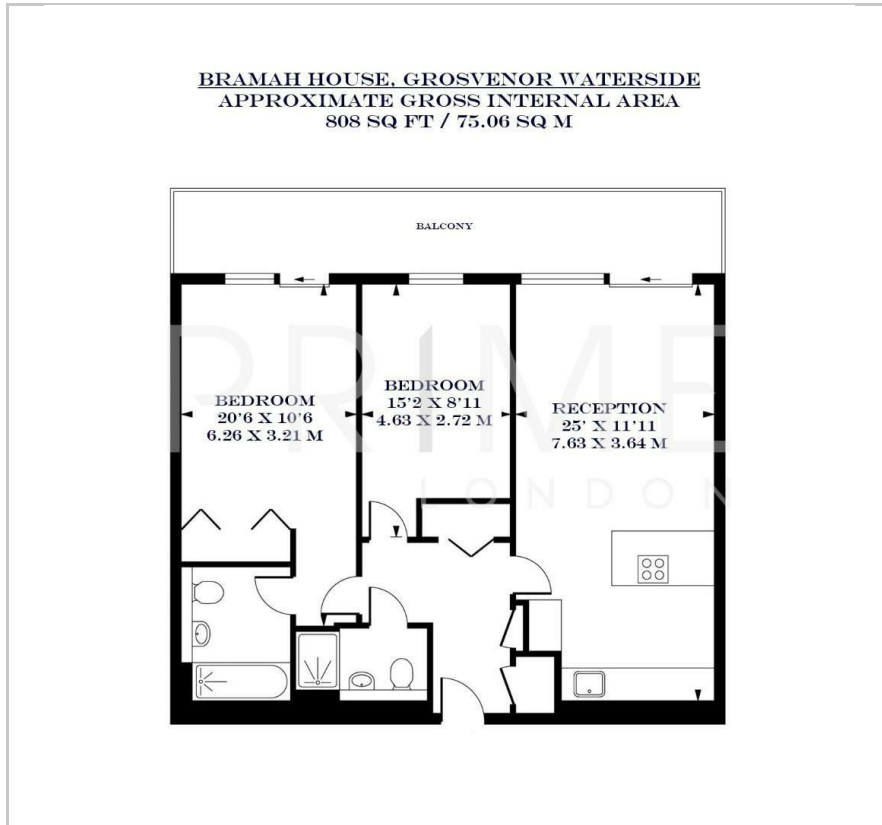

## Area Map

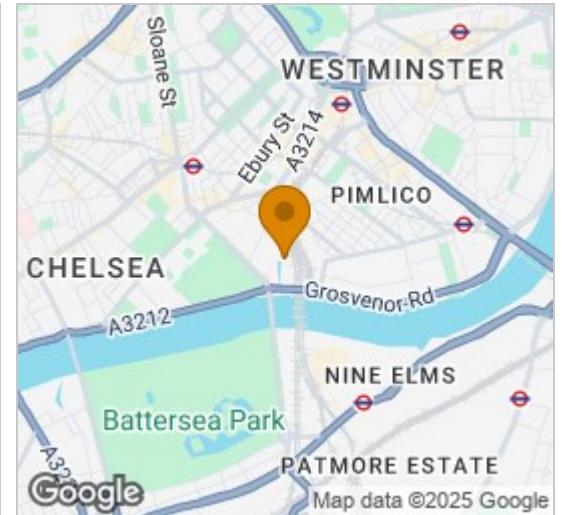

## Energy Efficiency Graph

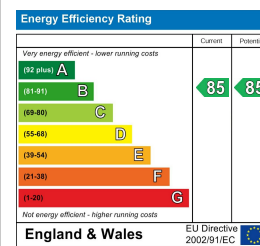

## Viewing

By appointment. Contact us on 0207 052 1075 if you wish to arrange a viewing appointment for this property, or require further information.

- Two bedroom apartment
- 808 sq ft (75.06 sqm)
- Generous private terrace
- Residents' gym, spa and on-site cafe
- Short walk from King's Road
- 24 hour concierge



A bright two-bedroom apartment, located in the popular in Bramah House, part of the prestigious Grosvenor Waterside development in Chelsea, is now available to lease through Prime London.

Spanning 808 sq ft (75.06 sqm), this stunning property boasts a stylish open-plan kitchen fitted with Miele integrated appliances and a wine cooler, seamlessly leading to a spacious reception area adorned with elegant dark hardwood flooring. The principal bedroom offers generous storage with two double wardrobes and features an en-suite bathroom complete with a shower over the bath. A second double bedroom and a sleek family shower room complete the layout.

Residents of Grosvenor Waterside enjoy exclusive access to newly refurbished facilities, including a 24-hour concierge and a state-of-the-art luxury spa gym.

Ideally located on the north side of the river near Chelsea Bridge, the development is within walking distance of Battersea Park and conveniently close to Sloane Square underground station, offering excellent connections to central London. Victoria station (serving Victoria, Circle, and District lines in Zone 1) is also nearby.



These particulars, whilst believed to be accurate are set out as a general outline only for guidance and do not constitute any part of an offer or contract. Intending purchasers should not rely on them as statements of representation of fact, but must satisfy themselves by inspection or otherwise as to their accuracy. No person in this firm's employment has the authority to make or give any representation or warranty in respect of the property.