



The Tower

St George Wharf, SW8 2DU

Asking Price £620,000

-  1
-  1
-  1
-  C

Floor Plan

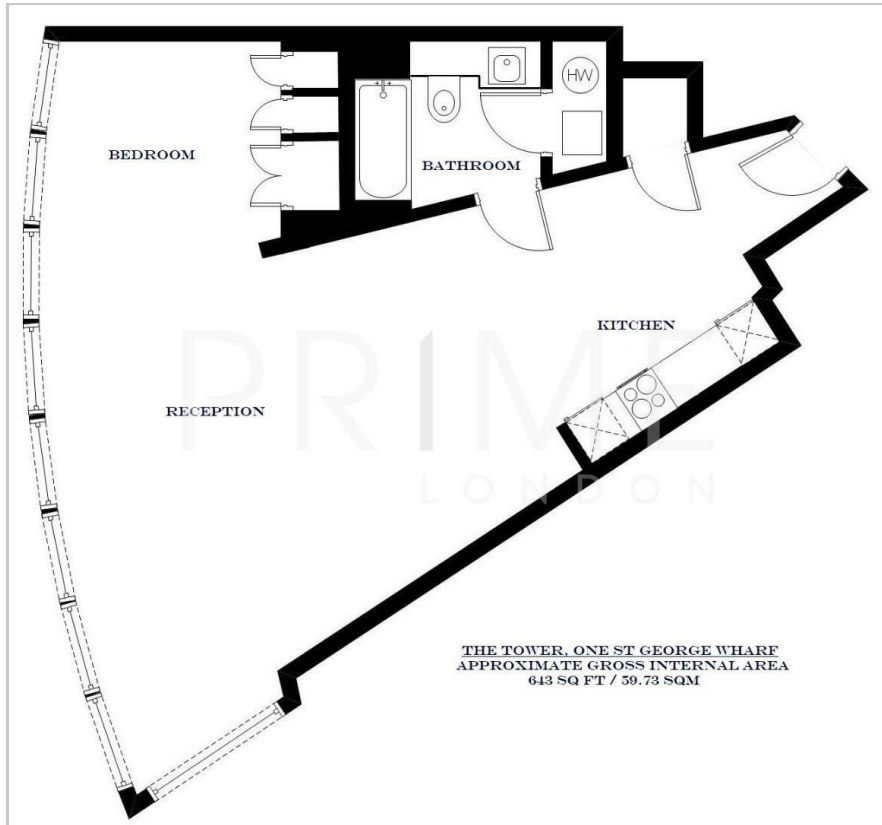

Area Map

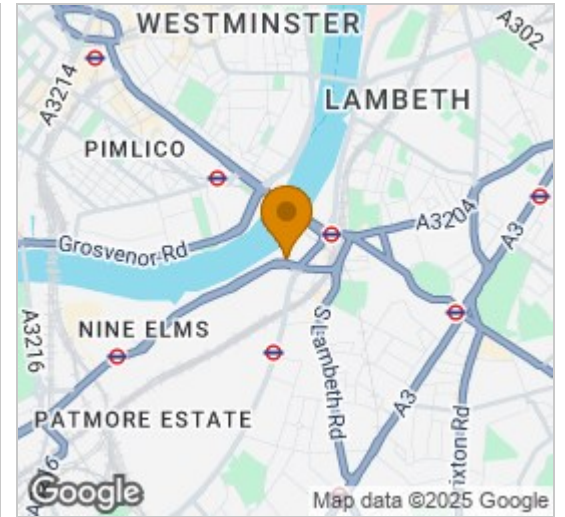

Energy Efficiency Graph

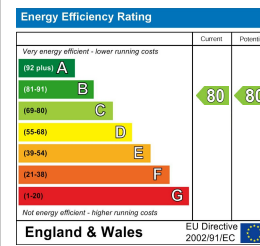

Viewing

By appointment. Contact us on 0207 928 6663 if you wish to arrange a viewing appointment for this property, or require further information.

- Luxury Manhattan apartment
- Chain free
- 24 hour concierge
- 643 sq. ft. (59.73 sq. m)
- Swimming pool, sauna, steam room, treatment room, gym
- Valet parking



This exceptional one bedroom apartment, located in a great position within the iconic St George Wharf Tower on the River Thames (offering excellent residents' facilities and beautiful finishes within the property), is available for chain free sale through Prime London. The property also comes with secure valet parking.

This 643 sq ft (59.73 sq m) apartment offers an excellent living space with well-crafted materials throughout including marble, glass and polished stone finishes. The apartment further benefits from floor to ceiling windows, fully comprehensive kitchen, modern bathroom and valet parking.

Amenities include front door concierge with valet parking, first floor gym, pool and sauna facilities as well as a private cinema. St George Wharf offers on site riverside bars and restaurants such as Waterfront London, The Riverside, Four Degree and Pop Art Sushi as well as direct access to Vauxhall Underground Station on the Victoria Line.

For additional convenience other on site outlets include Tesco Express, Pret a Manger, Hudson's Dry Cleaners, Riverside Medical Centre & Dental Spa and more.



These particulars, whilst believed to be accurate are set out as a general outline only for guidance and do not constitute any part of an offer or contract. Intending purchasers should not rely on them as statements of representation of fact, but must satisfy themselves by inspection or otherwise as to their accuracy. No person in this firm's employment has the authority to make or give any representation or warranty in respect of the property.