



Salamanca Tower

4 Salamanca Place, Albert Embankment, SE1 7HB

Asking Price £635,000



Floor Plan

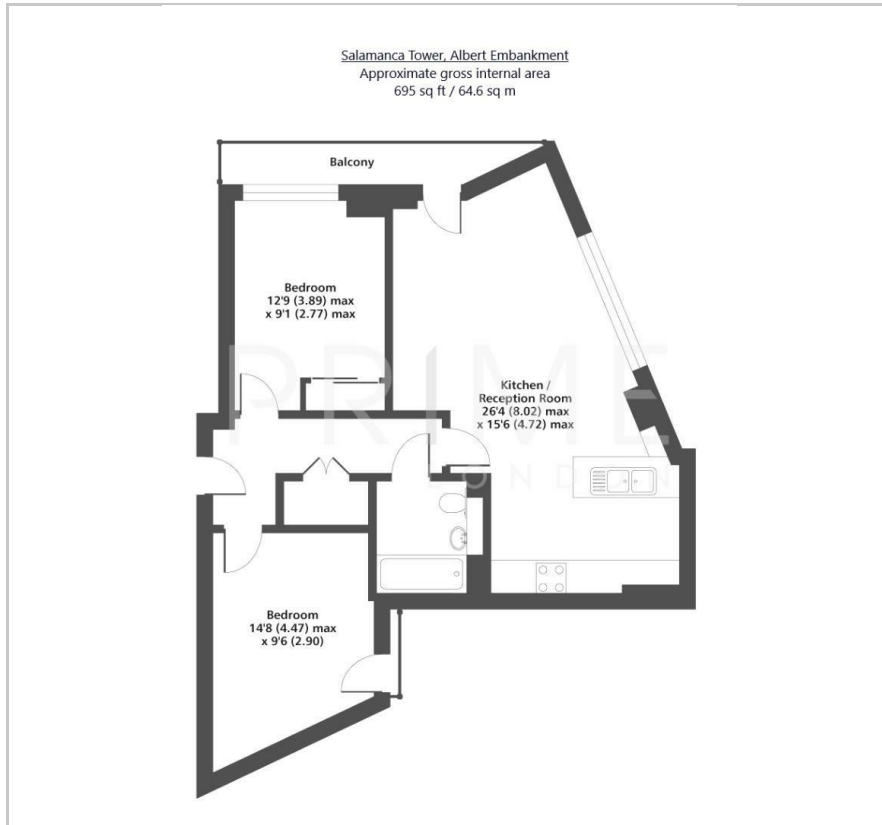

Area Map

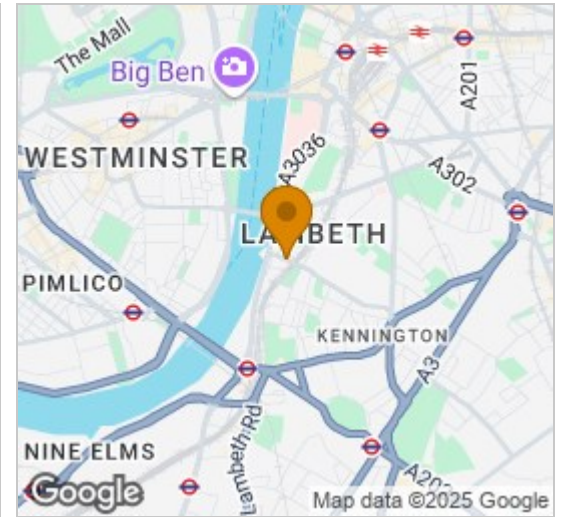

Energy Efficiency Graph

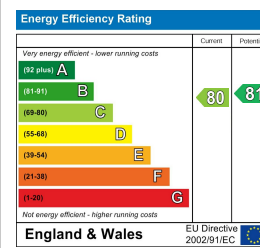

Viewing

By appointment. Contact us on 0207 928 6663 if you wish to arrange a viewing appointment for this property, or require further information.

- Modern two bedroom ▪ 695 sq ft / 64.6 sq m apartment
- Excellent condition
- Chain free
- Lift access
- Secure parking space
- Residents' only Roof Terrace
- Next to the River Thames



Kept in excellent condition, this high floor and bright two double bedroom apartment of c. 695 sq ft / 64.6 sq m within the modern Salamanca Tower, is available for chain free sale through Prime London. The property also comes with a secure underground parking space.

The reception room - with floor to ceiling windows and access to the private balcony with views of The Shard - offers a large living space which leads on to an open plan and modern integrated kitchen. The property further comprises two spacious double bedrooms with built in storage, and family bathroom, and excellent storage in the hall.

Salamanca Tower, which boasts a large residents' only Roof Terrace with views of the Houses of Parliament and The Shard, is within walking distance of the shops, restaurants, and attractions of London's South Bank and the West End. The rail/tube links of Vauxhall and Waterloo are within easy reach and there is a frequent bus service offering quick access to the whole of London on the doorstep.

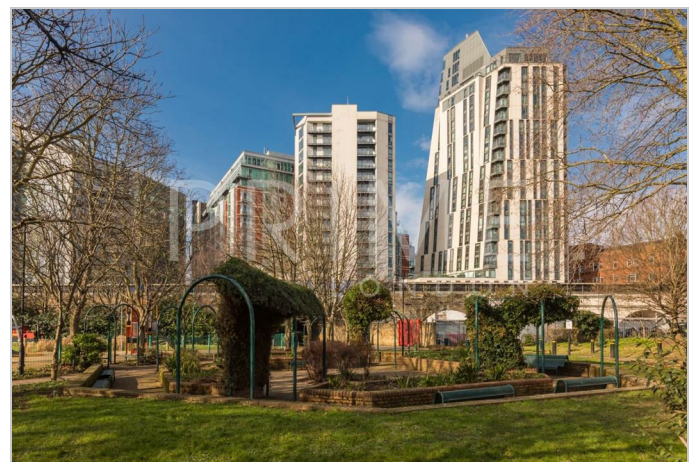

These particulars, whilst believed to be accurate are set out as a general outline only for guidance and do not constitute any part of an offer or contract. Intending purchasers should not rely on them as statements of representation of fact, but must satisfy themselves by inspection or otherwise as to their accuracy. No person in this firm's employment has the authority to make or give any representation or warranty in respect of the property.