

## Westmark Tower

1 Newcastle Place, West End Gate, W2 1EQ

Asking Price £1,280,000



2



2



1



B

Floor Plan

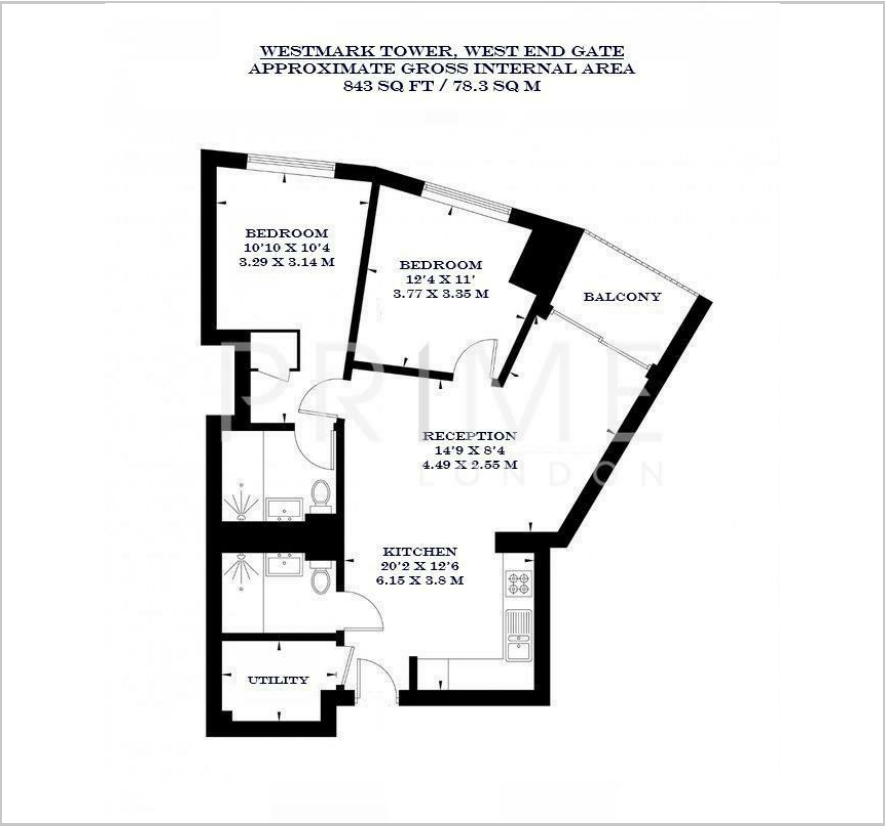

Area Map



Energy Efficiency Graph

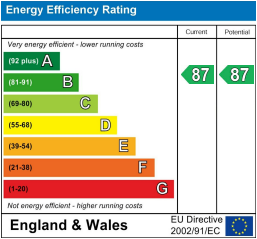

Viewing

By appointment. Contact us on 0207 052 1075 if you wish to arrange a viewing appointment for this property, or require further information.

- Two bedroom apartment
- Private balcony
- Walking distance to
- 843 sq ft (78.3 sqm)
- Residents' pool, spa/sauna, gym, cinema and lounge
- 24 hour concierge
- Paddington Station



This bright two-bedroom, two-bathroom apartment, nestled in the vibrant West End Gate community, is available for chain free sale through Prime London.

Spanning 843 sq ft (78.3 sqm), this residence features a spacious open-plan reception room with dedicated dining space and floor-to-ceiling windows, which fill the area with natural light.

The modern kitchen is generously sized, while both bedrooms offer built-in wardrobes and luxurious carpeting. The two elegantly stone-finished bathrooms are fitted with ambient lighting, and the apartment includes a convenient utility room.

Additional highlights include underfloor heating, air conditioning, double-glazed windows, and hardwood floors in the reception area.

Residents at West End Gate benefit from a range of premium amenities, such as 24-hour security, concierge services, a communal lounge, meeting rooms, a peaceful reading area, a swimming pool, jacuzzi, spa, onsite gym, private dining room, luxurious cineplex (with on-demand Blu-ray disc access and PS4 Pro availability), and beautifully landscaped communal gardens.

The property is within reach of Paddington and Edgware Road Underground, Overground, and Train Stations,



These particulars, whilst believed to be accurate are set out as a general outline only for guidance and do not constitute any part of an offer or contract. Intending purchasers should not rely on them as statements of representation of fact, but must satisfy themselves by inspection or otherwise as to their accuracy. No person in this firms employment has the authority to make or give any representation or warranty in respect of the property.