



Moore House

2 Gatliff Road, Grosvenor Waterside, SW1W 8DU

£1,153 Per Week



Floor Plan

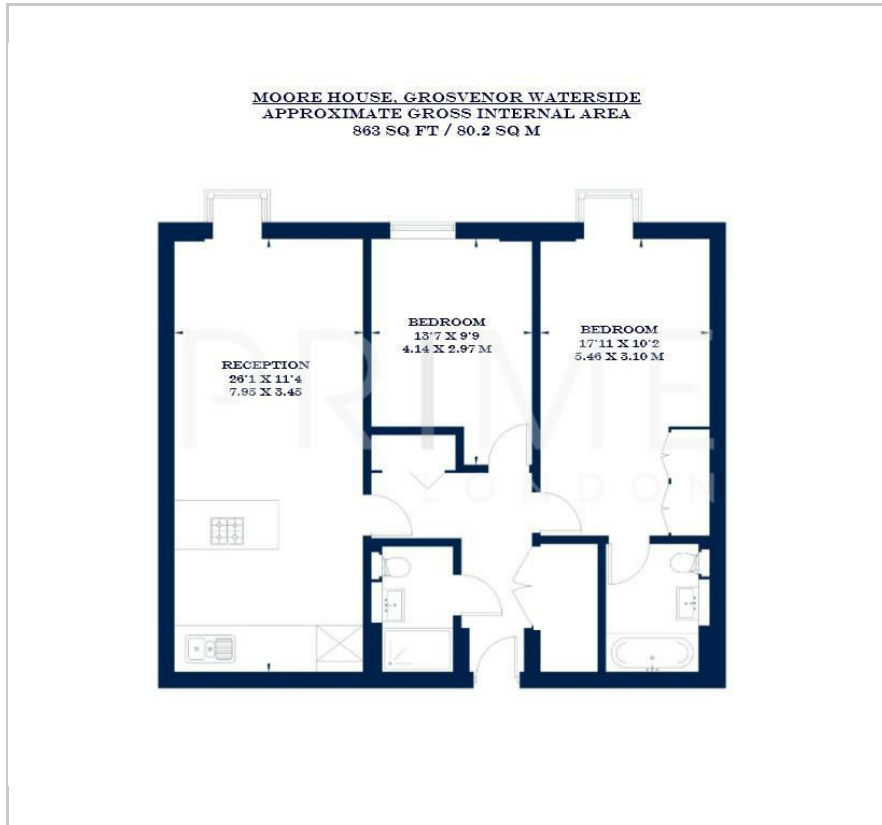

Area Map

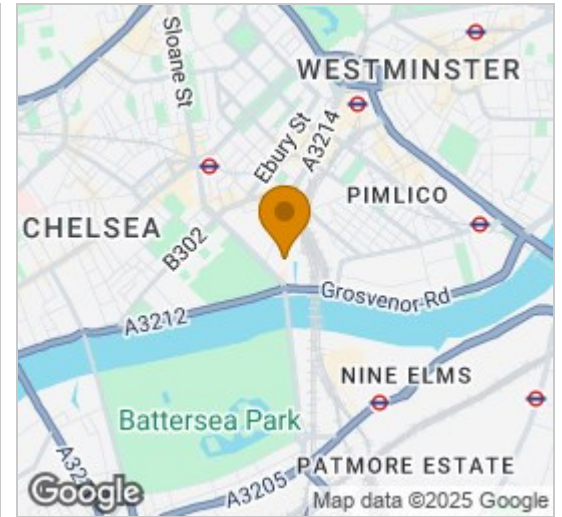

Energy Efficiency Graph



Viewing

By appointment. Contact us on 0207 052 1075 if you wish to arrange a viewing appointment for this property, or require further information.

- Two bedroom apartment
- Ample storage throughout
- Moment's away from King's Raod
- 863 sq ft (80.2 sqm)
- Residents' gym, spa, and on-site creche
- 24 hour concierge



A bright two-bedroom apartment in Moore House, part of the prestigious Grosvenor Waterside development in Chelsea, is now available for lease through Prime London.

Spanning 863 sq ft (80.2 sqm), this beautiful property features a modern open-plan kitchen equipped with Miele integrated appliances and a wine cooler, which flows seamlessly into a spacious reception area with sophisticated dark hardwood flooring. The principal bedroom offers ample storage with double wardrobes and includes an en-suite bathroom with a shower over the bath. A second double bedroom and a contemporary family shower room complete the apartment's layout.

Residents of Grosvenor Waterside benefit from exclusive access to newly refurbished amenities, including a 24-hour concierge and a state-of-the-art luxury spa gym.

Perfectly situated on the north side of the river near Chelsea Bridge, the development is within walking distance of Battersea Park and conveniently close to Sloane Square underground station, offering excellent links to central London. Victoria station (serving the Victoria, Circle, and District lines in Zone 1) is also nearby.



These particulars, whilst believed to be accurate are set out as a general outline only for guidance and do not constitute any part of an offer or contract. Intending purchasers should not rely on them as statements of representation of fact, but must satisfy themselves by inspection or otherwise as to their accuracy. No person in this firm's employment has the authority to make or give any representation or warranty in respect of the property.