

Sophora House

Vista Chelsea Bridge Wharf, SW8 4NQ

£1,200,000



2



2



1



B

Floor Plan

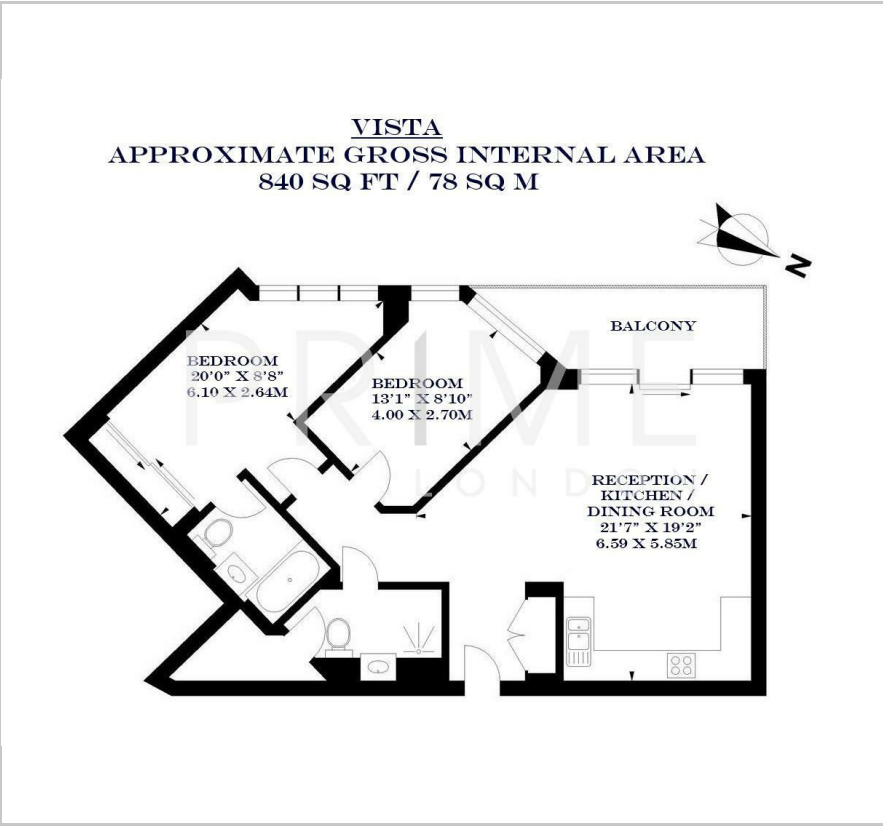

Area Map

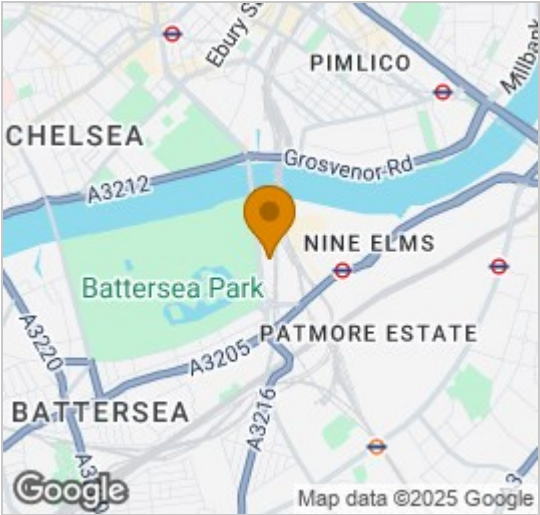

Energy Efficiency Graph

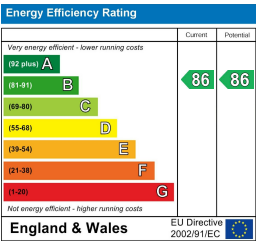

Viewing

By appointment. Contact us on 0207 928 6663 if you wish to arrange a viewing appointment for this property, or require further information.

- Bright two-bedroom ■ 841 sq ft (78.16 sqm) apartment
- Private balcony ■ Views of Battersea Park
- Residents' gym and ■ 24 hour concierge swimming pool



This bright 841 sq ft (78.16 sqm) and stylish two bedroom apartment sought after Vista, Chelsea Bridge Wharf development, is available for sale through Prime London.

The property features a spacious private balcony with stunning views over Battersea Park. Inside, you'll find an open-plan reception room, a fully integrated modern kitchen, and two double bedrooms—one of which includes built-in storage and an en-suite bathroom. Additional highlights include floor-to-ceiling windows, abundant natural light, wood flooring, air conditioning, underfloor heating, and ample storage space.

Vista Chelsea Bridge Wharf is a beautifully maintained modern development providing residents with exceptional amenities, including a state-of-the-art gym, swimming pool, and 24-hour concierge. Ideally situated overlooking Battersea Park, it offers a perfect blend of luxury and convenience.

Vista development is well situated, moments from Sloane Square, Kings Road and next door to the prestigious Battersea Power Station development, with the newly opened underground station (Northern Line). Transport links with Battersea Park and Queenstown Road stations being within 0.3 miles from the property.



These particulars, whilst believed to be accurate are set out as a general outline only for guidance and do not constitute any part of an offer or contract. Intending purchasers should not rely on them as statements of representation of fact, but must satisfy themselves by inspection or otherwise as to their accuracy. No person in this firm's employment has the authority to make or give any representation or warranty in respect of the property.