



Quarter House

Juniper Drive, Battersea Reach, SW18 1GX

Asking Price £625,000



Floor Plan

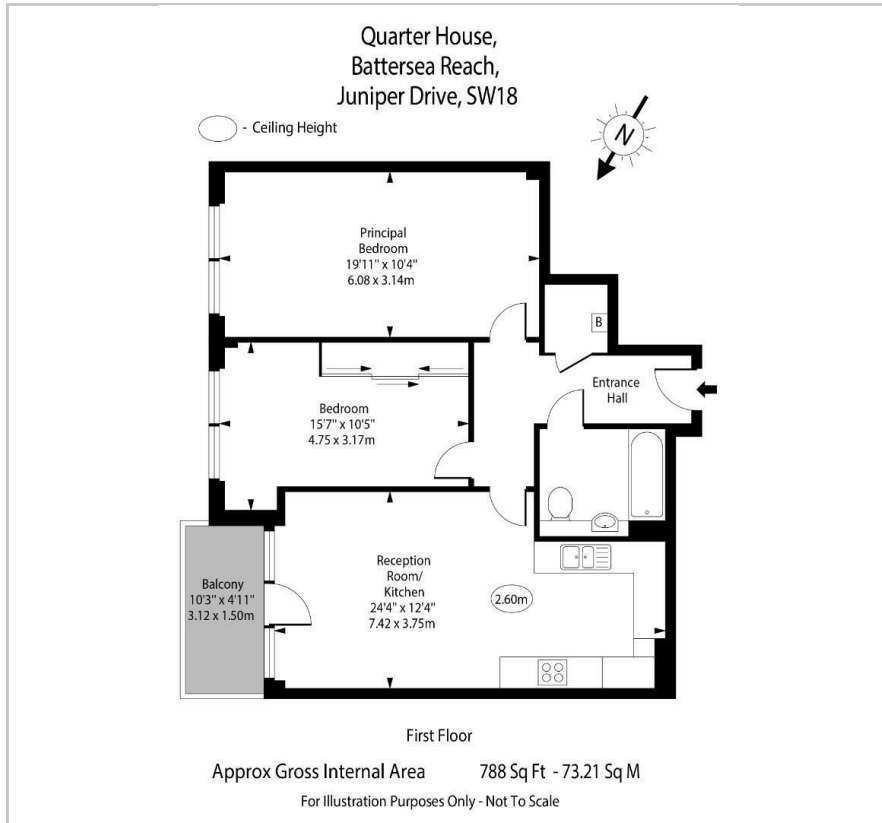

Area Map



Energy Efficiency Graph



Viewing

By appointment. Contact us on 0207 928 6663 if you wish to arrange a viewing appointment for this property, or require further information.

- Chain Free
- Two bedrooms
- Private balcony
- 788 sq ft (73.3 sq m)
- Open plan kitchen and reception
- 24 hour concierge



Situated on the first floor of Quarter House, within the highly desirable Battersea Reach development, this charming two bedroom one bathroom apartment offers a serene garden-facing view with a glimpse of the River Thames.

Boasting 788 sq ft (73.3 sq m) of living space, the apartment is available chain-free. It comprises a spacious open-plan living area with stunning wooden flooring, access to a private balcony, and a high-end fully fitted kitchen with integrated appliances. The accommodation also includes two generously sized double bedrooms and a well-appointed bathroom.

Battersea Reach is a sought-after riverside community, offering modern apartments, landscaped open spaces, and excellent transport links.

The award-winning development is complemented by a range of premium amenities, including a 24 hour concierge, residents' only gym, business centre with private meeting rooms, bike storage, and over six acres of landscaped grounds.

Residents also benefit from on-site shops and services such as Tesco Express, Young's Bar & Restaurant, Caserta Italian Café, and a beauty salon.



These particulars, whilst believed to be accurate are set out as a general outline only for guidance and do not constitute any part of an offer or contract. Intending purchasers should not rely on them as statements of representation of fact, but must satisfy themselves by inspection or otherwise as to their accuracy. No person in this firm's employment has the authority to make or give any representation or warranty in respect of the property.