

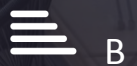

Cleland House

32 John Islip Street, Westminster, SW1P 4FF

£2,350,000



Floor Plan

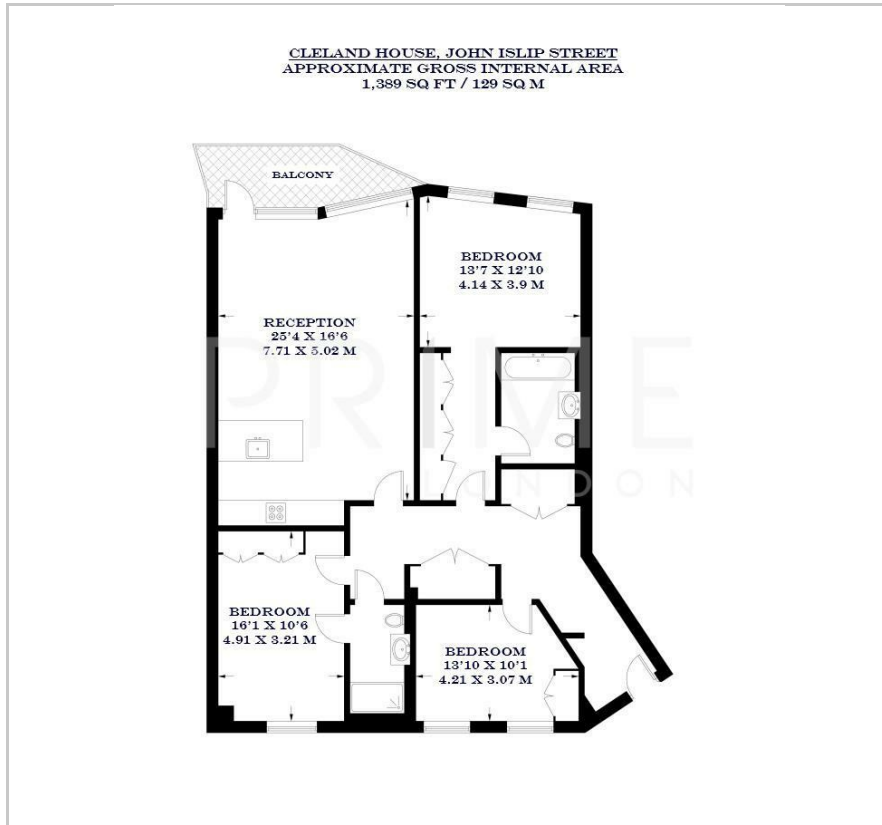

Area Map



Energy Efficiency Graph

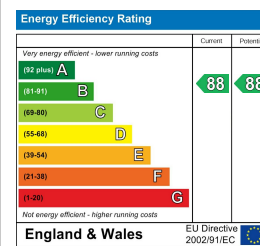

Viewing

By appointment. Contact us on 0207 052 1075 if you wish to arrange a viewing appointment for this property, or require further information.

- Modern three bedroom ▪ 1,389 sq ft (129 sqm) apartment
- Private balcony ▪ Parking space
- Residents' leisure suite ▪ 24 hour concierge including gym and pool



This spacious 1,389 sq ft (129 sqm) apartment, set within the stunning Cleland House development in Westminster, is available for chain-free sale through Prime London.

The property is offered inclusive of secure allocated parking.

The property comprises a large open-plan reception with floor-to-ceiling windows, a fully fitted high-end kitchen, three double bedrooms with ample storage, and two beautifully finished bathrooms. The property also benefits from comfort cooling and wooden flooring.

Noted as one of London's premier addresses, Abell & Cleland has been created to provide residences of exceptional quality. This luxurious and centrally located development offers landscaped gardens, a residents' gymnasium, swimming pool, sauna, and steam room, as well as a business Suite.

Close to the Division Bell area surrounding the Houses of Parliament, Abell & Cleland has been conceived by award-winning architects as a range of apartments that match the grand surroundings of their remarkable Westminster location.

Positioned to the south of St. James's Park and east of Victoria, the area includes some of London's most iconic landmarks while retaining a surprisingly village-like atmosphere.



These particulars, whilst believed to be accurate are set out as a general outline only for guidance and do not constitute any part of an offer or contract. Intending purchasers should not rely on them as statements of representation of fact, but must satisfy themselves by inspection or otherwise as to their accuracy. No person in this firm's employment has the authority to make or give any representation or warranty in respect of the property.