

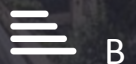

The Knightsbridge Apartments

Knightsbridge, SW7 1RH

£6,000 Per Week



Floor Plan

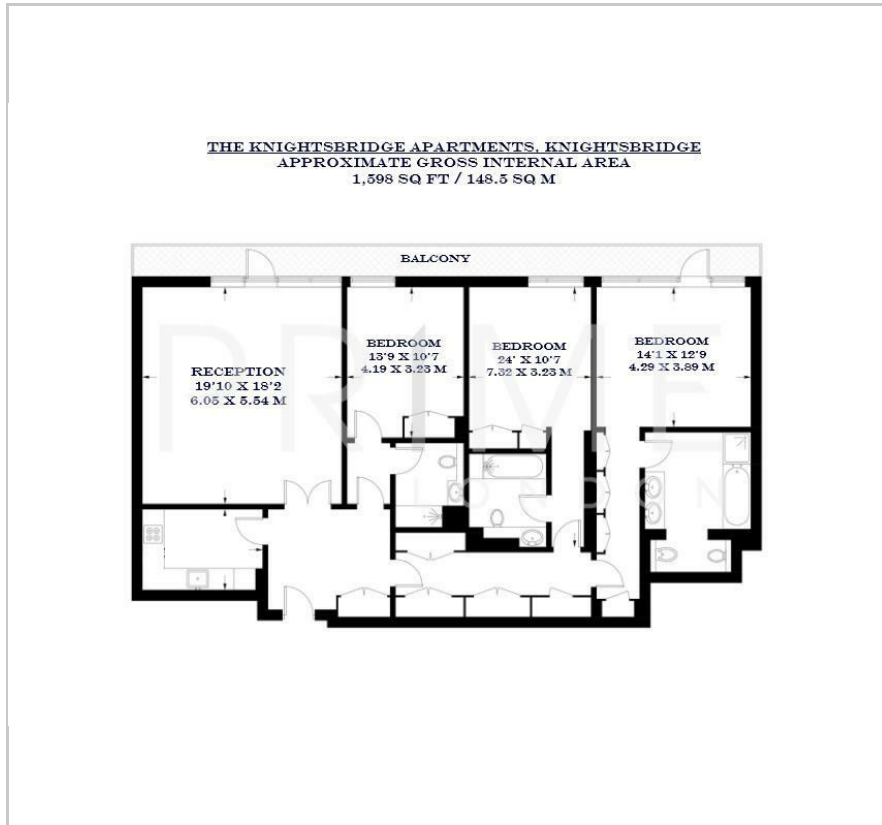

Area Map



Energy Efficiency Graph

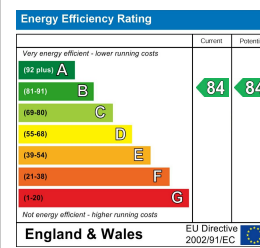

Viewing

By appointment. Contact us on 0207 052 1075 if you wish to arrange a viewing appointment for this property, or require further information.

- Three bedroom apartment
- Generous private balcony
- Short stroll from Knightsbridge underground station
- 1,598 sq ft (148.5 sqm)
- Residents' gym, pool, spa and communal garden
- 24 hour concierge

This luxurious three bedroom apartment, located in the prestigious Knightsbridge Apartments, is available now for lease through Prime London.

This exquisite lateral apartment, spanning 1,598 sq ft (148.5 sqm), boasts a spacious and elegantly designed reception and dining area. The separate modern kitchen is fully fitted with high-end appliances. There are three well-proportioned double bedrooms, each offering built-in storage, while the master suite enjoys the added luxury of floor-to-ceiling windows, flooding the space with natural light and providing direct access to a private balcony with stunning views.

Residents of The Knightsbridge Apartments benefit from exceptional amenities, including a 24-hour concierge, a luxurious spa, a state-of-the-art gym, and an indoor swimming pool.

Knightsbridge Underground Station (Piccadilly Line) is just a short walk away, offering transport links across London.

The area is also home to world-renowned shopping destinations, including Harrods and Harvey Nichols, as well as an array of fine dining establishments and cultural landmarks.



These particulars, whilst believed to be accurate are set out as a general outline only for guidance and do not constitute any part of an offer or contract. Intending purchasers should not rely on them as statements of representation of fact, but must satisfy themselves by inspection or otherwise as to their accuracy. No person in this firm's employment has the authority to make or give any representation or warranty in respect of the property.