

## Iris House

12 Hemlock Street, Poplar Riverside, E14 0XY

£550 Per Week

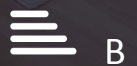
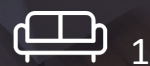

## Floor Plan

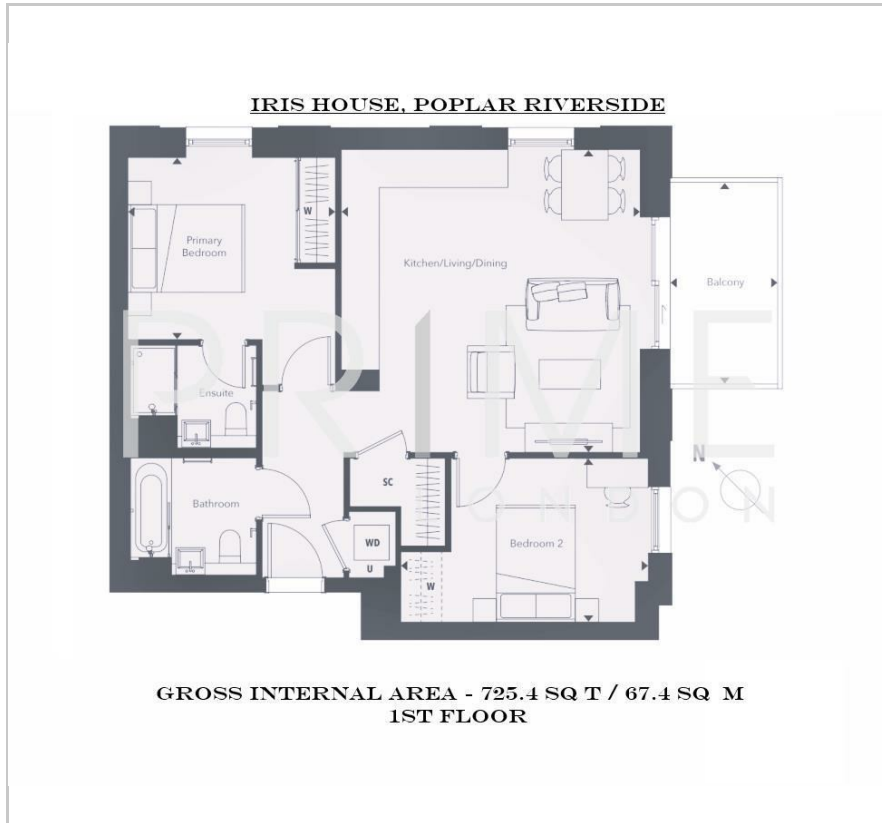

## Area Map

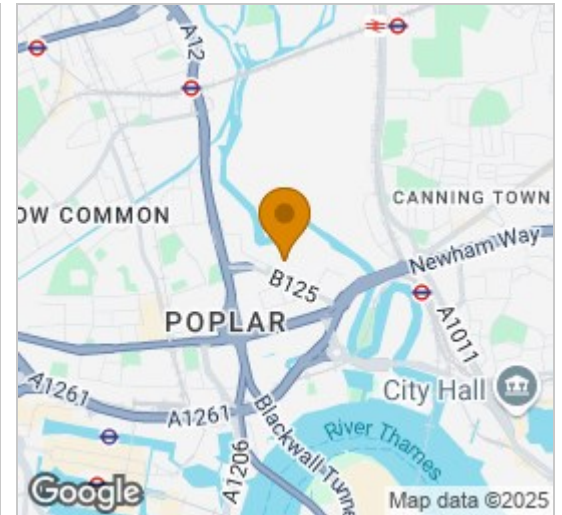

## Energy Efficiency Graph



## Viewing

By appointment. Contact us on 0207 052 1075 if you wish to arrange a viewing appointment for this property, or require further information.

- Two bedroom apartment
- First Floor
- Concierge service
- Cinema and game rooms
- Furnished
- 726 sq ft (67 sqm)
- Swimming pool, Gym and Spa
- Co-working space

A beautifully presented two-bedroom apartment of 726 sq ft (67 sq m) on the first floor of Iris House in the sought-after Poplar Riverside development. Offered fully furnished, this stylish apartment combines modern design with outstanding facilities.

Residents benefit from 24 hour security and a concierge service, as well as access to a state-of-the-art gym and The Spa, which includes a swimming pool, sauna, steam room, and treatment room. There is also a private cinema and games room, along with a co-working space ideal for remote working.

Poplar Riverside is perfectly positioned for easy access to Canary Wharf, which is just a short journey away. Westfield Stratford, one of East London's premier shopping destinations, is within cycling distance, while Bond Street and Heathrow International Airport are also easily reachable.



These particulars, whilst believed to be accurate are set out as a general outline only for guidance and do not constitute any part of an offer or contract. Intending purchasers should not rely on them as statements of representation of fact, but must satisfy themselves by inspection or otherwise as to their accuracy. No person in this firm's employment has the authority to make or give any representation or warranty in respect of the property.