

Valencia Tower

250 City Road, EC1V 2AQ

£819 Per Week



Floor Plan

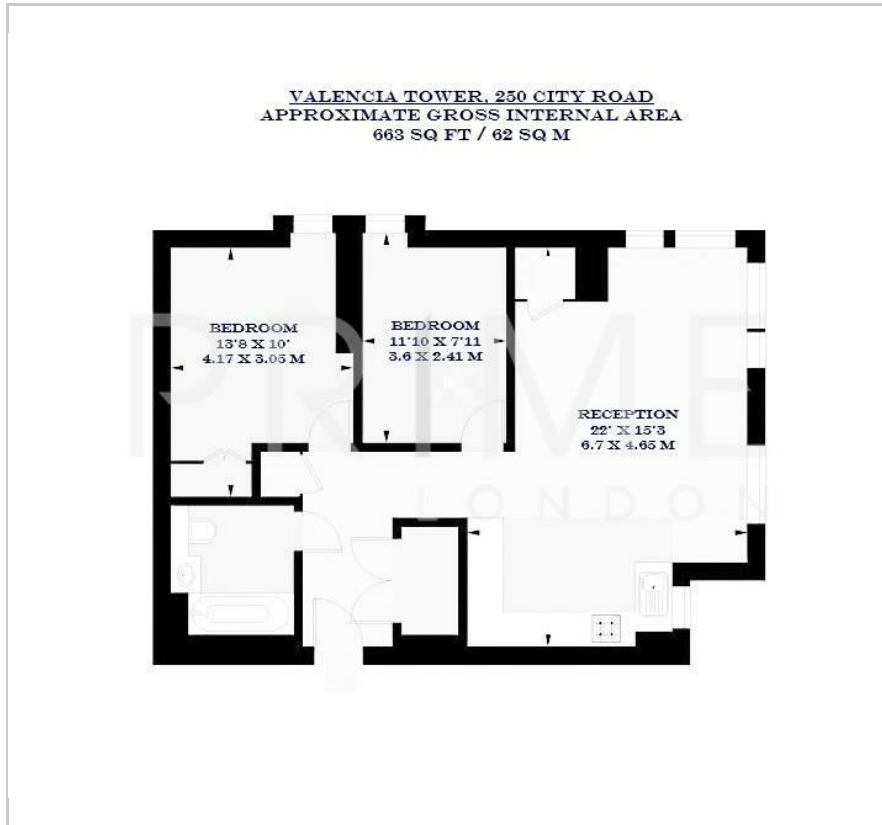

Area Map

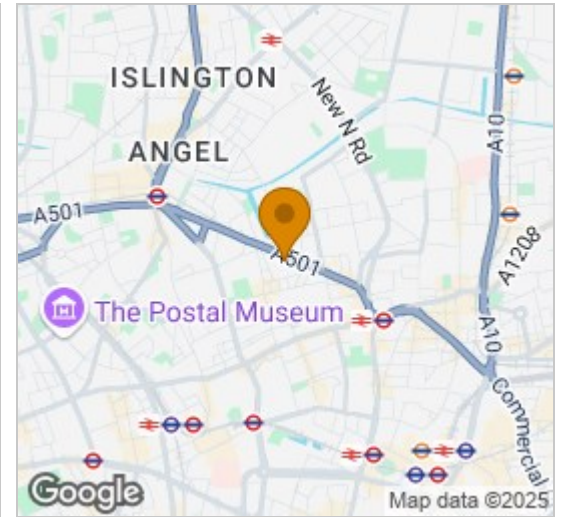

Energy Efficiency Graph

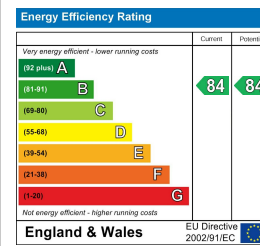

Viewing

By appointment. Contact us on 0207 052 1075 if you wish to arrange a viewing appointment for this property, or require further information.

- Two bedroom apartment
- 663 sq ft (62 sqm)
- Floor to ceiling windows
- Fully furnished to a high standard
- Residents' spa, pool, gym and games room
- 24 hour concierge

This impressive two-bedroom apartment, situated in the renowned Valencia Tower 250 City Road, is available for lease through Prime London.

Spanning over 663 sq ft (62 sqm), the property features a spacious open-plan kitchen and reception area, complete with a wine cooler. The property includes two large double bedrooms, each with built-in storage, and a luxurious bathroom complete with large tiles and a striking herringbone design on the feature wall.

Residents can enjoy breathtaking views of landscaped gardens, along with an array of premium amenities. These include a gym, a terrace, a 20-meter swimming pool, and a spa. The development also offers concierge services, a residents' lounge, a games room, and a reading room.

250 City Road is situated in one of the most sought-after areas of London. The development is surrounded by vibrant neighbourhoods such as Shoreditch, Old Street, and Islington, offering an array of dining, shopping, and entertainment options.



These particulars, whilst believed to be accurate are set out as a general outline only for guidance and do not constitute any part of an offer or contract. Intending purchasers should not rely on them as statements of representation of fact, but must satisfy themselves by inspection or otherwise as to their accuracy. No person in this firm's employment has the authority to make or give any representation or warranty in respect of the property.