



Bowery Apartments

Fountain Park Way, White City Living, W12 7HZ

£875 Per Week



Floor Plan

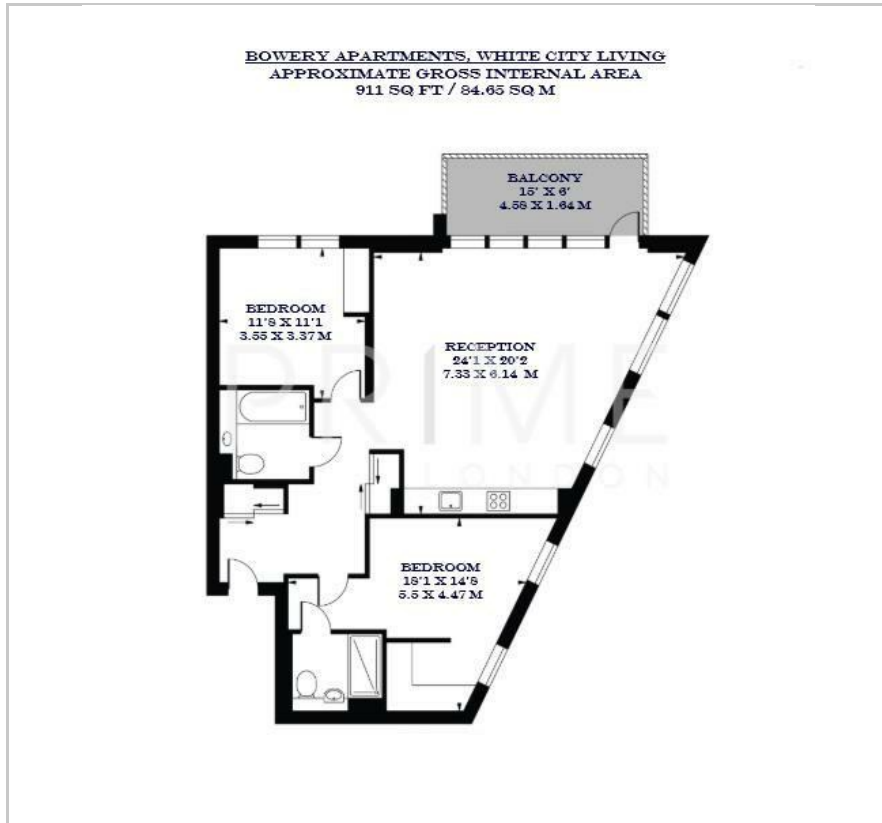

Area Map



Energy Efficiency Graph



Viewing

By appointment. Contact us on 0207 052 1075 if you wish to arrange a viewing appointment for this property, or require further information.

- Two bedroom apartment
- 911 sq ft (84.65 sqm)
- Floor to ceiling windows and private balcony
- Exclusive residents' facilities including pool, gym and private cinemas
- Stone's throw away from Westfield London
- 24 hour concierge



This beautifully finished two bedroom apartment, located within the prestigious White City Living development, is available for lease through Prime London.

Spanning approximately 911 sq ft (84.65 sqm), the property offers open-plan living and dining area, enhanced by floor-to-ceiling windows that lead out onto a private balcony overlooking the beautifully landscaped communal gardens. The contemporary kitchen is fully fitted with high-spec Siemens appliances, sleek cabinetry, and stone worktops.

The principal bedroom is complete with bespoke fitted wardrobes and a luxurious en suite shower room. The second bedroom is also a good-sized double, served by a main bathroom. Additional features include comfort cooling, underfloor heating, and excellent storage space.

Residents of White City Living benefit from access to outstanding amenities, including a 24-hour concierge, two private cinemas, a fully equipped gym, a 17-metre swimming pool with hydrotherapy facilities, a spa with treatment rooms, a resident's club and private dining suite, and business lounges.

White City Living is positioned moments away from the extensive shopping, dining, and entertainment options at Westfield London. Excellent transport links are nearby, with White City (Central Line), Wood Lane (Hammersmith & City Line), and Shepherd's Bush (Overground and Central Line) stations all within walking distance.



These particulars, whilst believed to be accurate are set out as a general outline only for guidance and do not constitute any part of an offer or contract. Intending purchasers should not rely on them as statements of representation of fact, but must satisfy themselves by inspection or otherwise as to their accuracy. No person in this firm's employment has the authority to make or give any representation or warranty in respect of the property.