



## Principal Tower

2 Principal Place, Worship Street, EC2A 2FB

£950 Per Week





Floor Plan

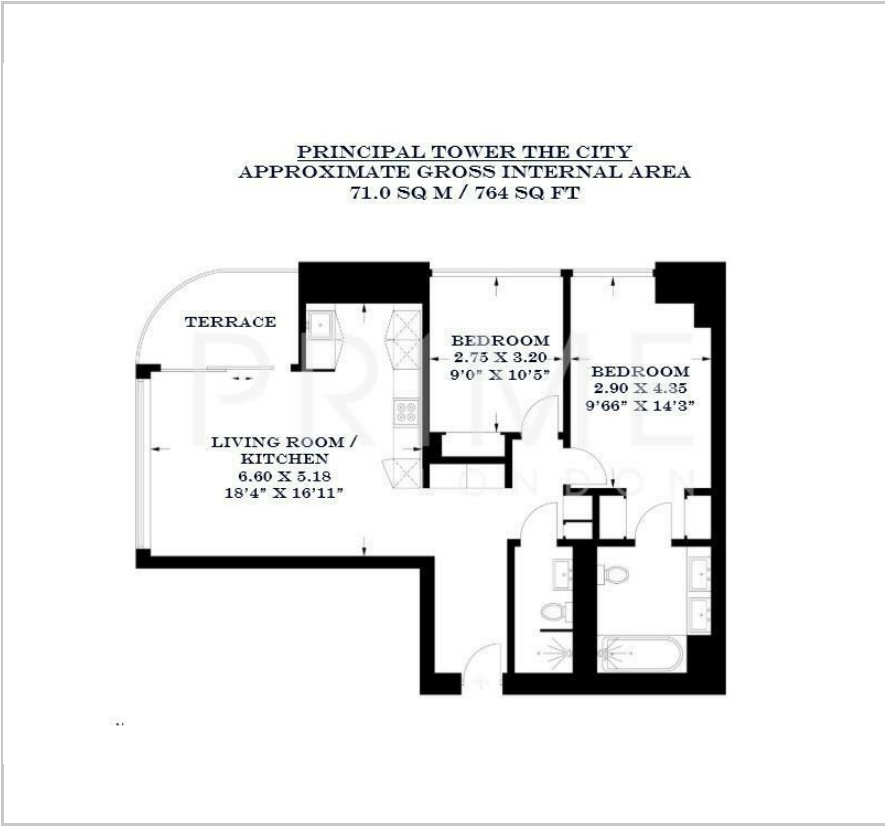

Area Map

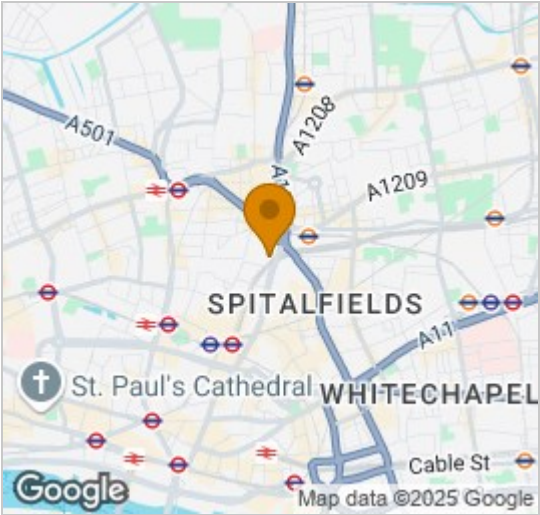

Energy Efficiency Graph

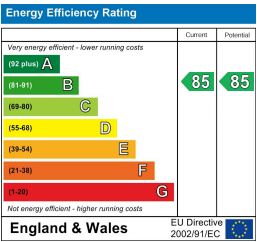

Viewing

By appointment. Contact us on 0207 052 1075 if you wish to arrange a viewing appointment for this property, or require further information.

- Two bedroom apartment
- Private balcony
- Located between Shoreditch and The City
- 764 sq ft (71 sqm)
- Residents' gym, pool, spa and cinema room
- 24 hour concierge



This two bedroom apartment, situated in the iconic Principal Tower, is available for lease through Prime London.

Spanning 764 sq ft (71 sqm), the apartment features a spacious open-plan living and dining area that opens onto a private balcony, two well-sized double bedrooms with generous built-in wardrobes, and two sleek, modern bathrooms, one of which is ensuite to the principal bedroom.

Residents of Principal Tower enjoy access to an impressive array of five-star amenities, including a 24-hour concierge, residents' lounge, fully equipped gym, private cinema, luxurious spa, and a pool.

Ideally located on the edge of the City and moments from the vibrant Shoreditch district, Principal Tower offers a unique lifestyle that combines business and culture. Residents benefit from excellent transport connections via five nearby stations, ensuring seamless travel throughout London and beyond.



These particulars, whilst believed to be accurate are set out as a general outline only for guidance and do not constitute any part of an offer or contract. Intending purchasers should not rely on them as statements of representation of fact, but must satisfy themselves by inspection or otherwise as to their accuracy. No person in this firm's employment has the authority to make or give any representation or warranty in respect of the property.