



The View

20 Palace Street, SW1E 5BA

Asking Price £1,075,000



Floor Plan

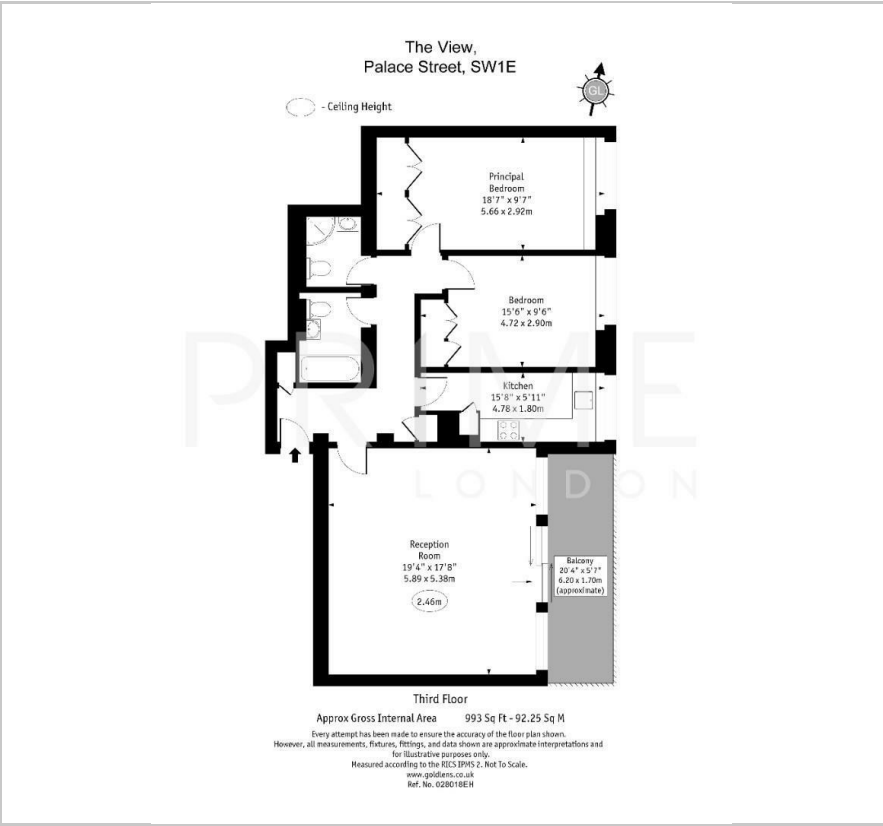

Area Map



Energy Efficiency Graph

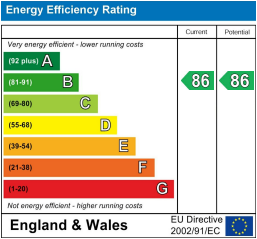

Viewing

By appointment. Contact us on 0207 052 1075 if you wish to arrange a viewing appointment for this property, or require further information.

- Two bedroom apartment
- 24 hour concierge
- Excellent central location
- 993 sq ft (92.25 sqm)
- Air conditioning
- Plethora of local amenities and transport links



A bright two bedroom apartment in the heart of Victoria, offering 993 sq ft (92.25 sqm) of internal space, located within the exclusive 20 Palace Street and available for chain free sale through Prime London.

Situated within easy reach of both Victoria and St James's Park stations, the property benefits from an outstanding central location. The apartment is presented in excellent condition and comprises a spacious reception room that leads onto a private balcony with open views.

There is a separate, fully integrated kitchen, which enjoys an abundance of natural light. The living accommodation is completed by a master bedroom, a second large double bedroom, and two bathrooms.

The View also offers residents a 24 hour concierge service for added convenience.

20 Palace Street is just a stone's throw from Buckingham Palace, with a wealth of local amenities in Westminster, Victoria, and Belgravia. On your doorstep are the vibrant Cardinal Place and Nova developments, home to an array of restaurants, bars, cafés, coffee shops, and designer boutiques.

Transport links are plentiful, with easy access to most of London's Underground lines and major airports, making this property an ideal home or investment in one of the capital's most desirable locations.



These particulars, whilst believed to be accurate are set out as a general outline only for guidance and do not constitute any part of an offer or contract. Intending purchasers should not rely on them as statements of representation of fact, but must satisfy themselves by inspection or otherwise as to their accuracy. No person in this firm's employment has the authority to make or give any representation or warranty in respect of the property.