



1 Fareham Street

Soho, W1F 8BB

£830 Per Week





Floor Plan

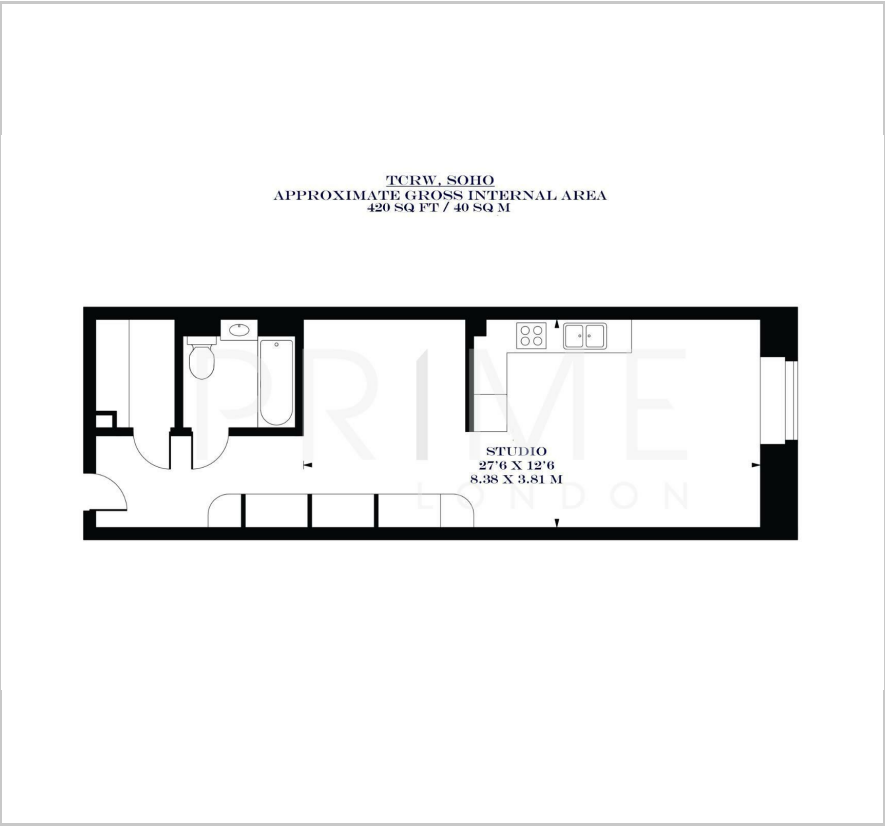

Area Map



Energy Efficiency Graph

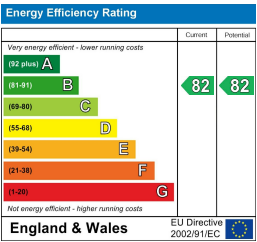

Viewing

By appointment. Contact us on 0207 052 1075 if you wish to arrange a viewing appointment for this property, or require further information.

- Studio apartment
- 420 sq ft (40 sqm)
- Floor to ceiling windows
- Centrally located
- 0.1 miles to Tottenham Court Road Station
- 24 hour concierge



This thoughtfully designed and fully furnished studio, located in the popular TCRW development, is available for lease through Prime London.

Totalling 420 sq ft (40 sqm), the property showcases stylish interiors, and features floor-to-ceiling windows invite an abundance of natural light, enhancing the open-plan layout that includes a sleek kitchen equipped with integrated appliances, a comfortable living space, and a peaceful sleeping area complete with built-in storage. The bathroom is finished to a high standard, featuring modern fixtures.

Perfectly positioned in one of London's most dynamic neighbourhoods, this apartment places you moments from an array of top-tier restaurants, iconic shopping destinations, and world-class cultural institutions.

Residents benefit from excellent transport connections, 24 hour concierge services, secure entry, and access to communal amenities, making it an exceptional choice for those seeking a vibrant city lifestyle.



These particulars, whilst believed to be accurate are set out as a general outline only for guidance and do not constitute any part of an offer or contract. Intending purchasers should not rely on them as statements of representation of fact, but must satisfy themselves by inspection or otherwise as to their accuracy. No person in this firms employment has the authority to make or give any representation or warranty in respect of the property.