



## 1 Merino Gardens

London Dock, E1W 2DF

£646 Per Week



1



1



1



B



Floor Plan

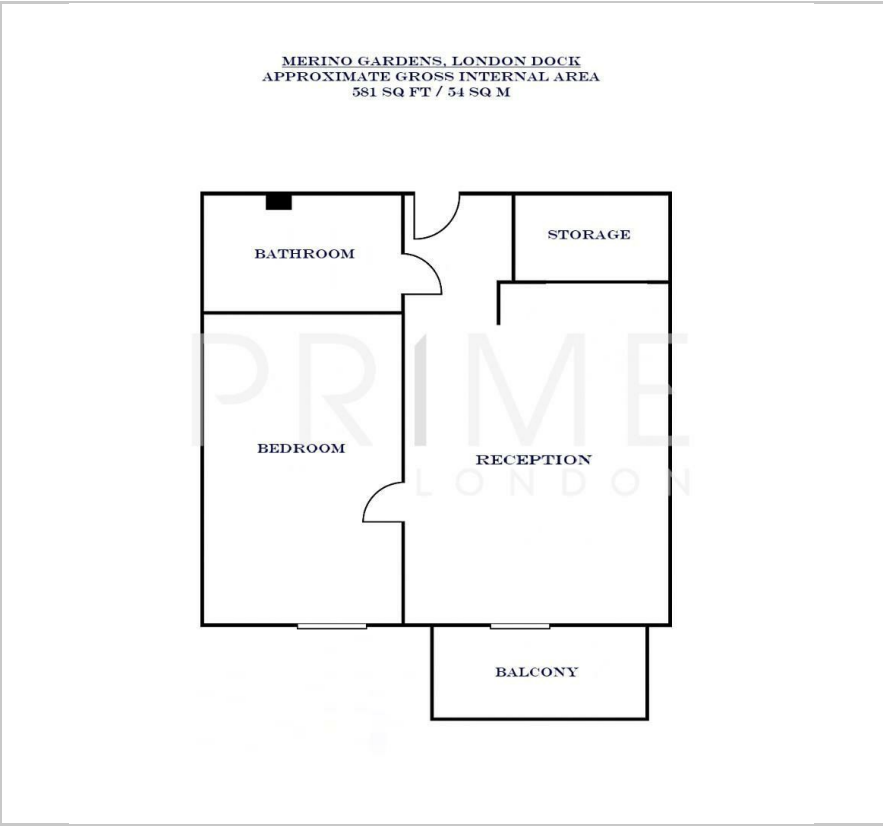

Area Map

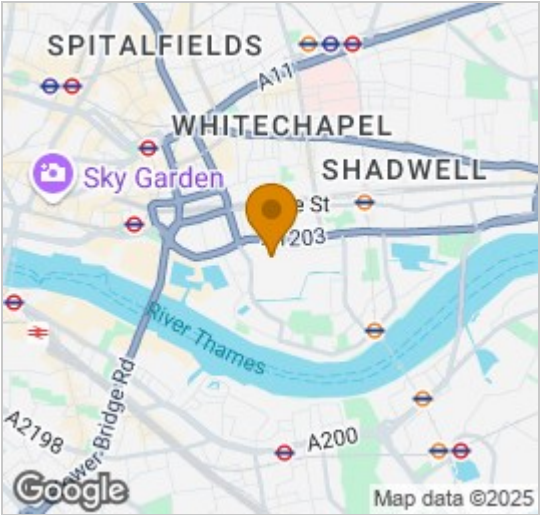

Energy Efficiency Graph

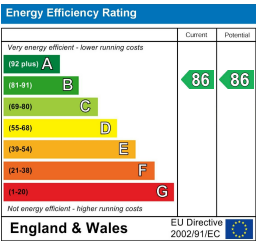

Viewing

By appointment. Contact us on 0207 052 1075 if you wish to arrange a viewing appointment for this property, or require further information.

- One bedroom apartment
- 581 sq ft (54 sqm)
- Private balcony overlooking
- Residents' gym, pool, spa and rooftop terrace
- Just moments from Tower Hill
- 24 hour concierge Station

This beautifully finished one bedroom apartment, located in the prestigious London Dock development, is available for lease through Prime London.

Recently completed, the apartment totals 581 sq ft (54 sqm) and boasts a bright and airy open-plan living and dining area, a sleek contemporary kitchen with fully integrated appliances, a spacious bedroom with excellent wardrobe storage, and a stylish bathroom featuring a large walk-in shower. The property also features a private balcony, providing views of the tranquil Quayside.

Residents of London Dock benefit from exclusive access to exceptional on-site amenities, including beautifully landscaped courtyards, rooftop terraces, a state-of-the-art gym, and a luxurious swimming pool.

Ideally situated just moments from Tower Hill (District and Circle lines) and Tower Gateway (DLR), the development is within easy reach of Tower Bridge, the Tower of London, St Katharine Docks, the River Thames, and the heart of the City of London.



These particulars, whilst believed to be accurate are set out as a general outline only for guidance and do not constitute any part of an offer or contract. Intending purchasers should not rely on them as statements of representation of fact, but must satisfy themselves by inspection or otherwise as to their accuracy. No person in this firms employment has the authority to make or give any representation or warranty in respect of the property.