



Three Riverlight Quay

Nine Elms, SW8 5BE

£960 Per Week



2



2



1



B

Floor Plan

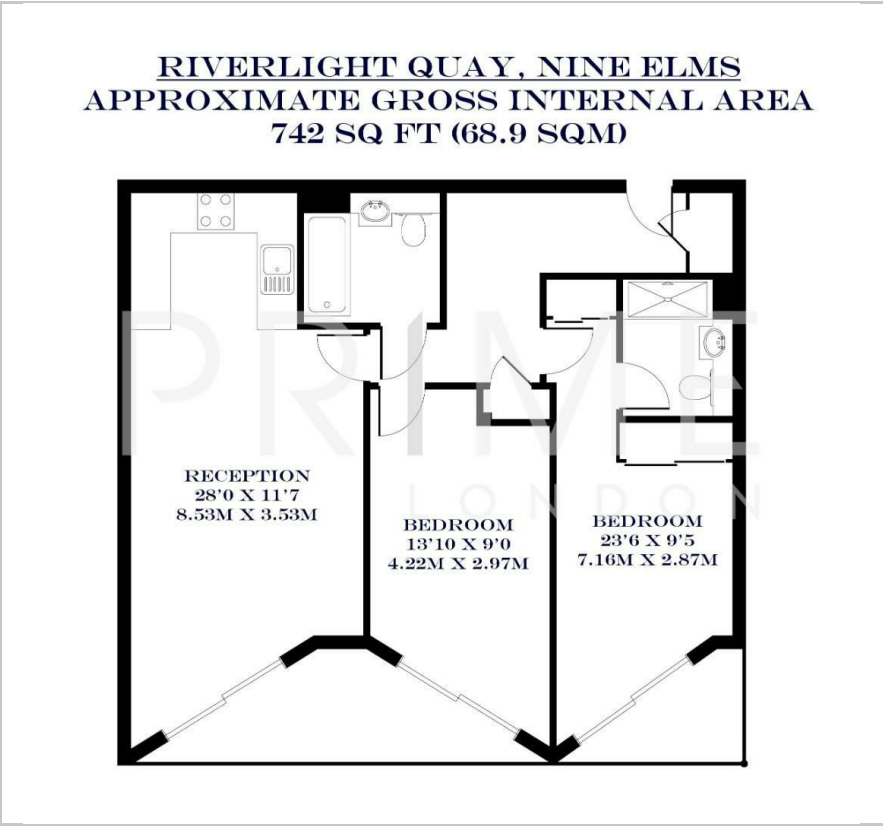

Area Map

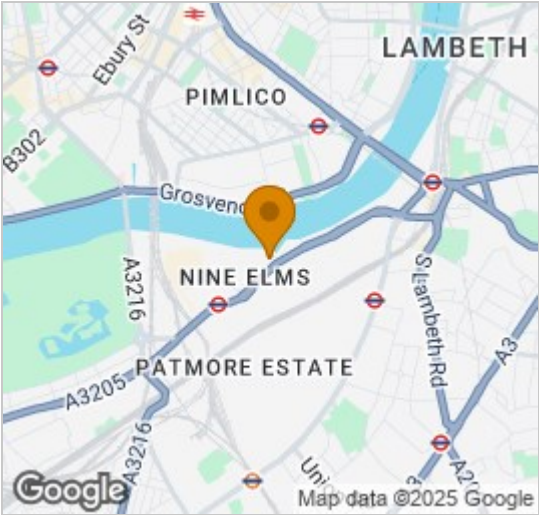

Energy Efficiency Graph

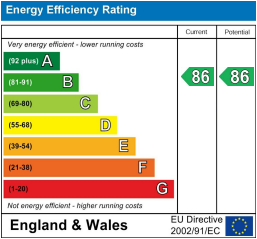

Viewing

By appointment. Contact us on 0207 928 6663 if you wish to arrange a viewing appointment for this property, or require further information.

- Lease from September to July ■ 742 sq ft (68.9 sqm)
- On-site leisure and resident's ■ 24 hour concierge facilities



This wonderfully furnished two bedroom two bathroom apartment, with two private balconies, is available for lease from September to July within the sought after Riverlight development through Prime London.

This apartment offers 742 sq ft (68.9 sqm) of living space and a high specification level throughout, including comfort cooling and under floor heating.

An exclusive on-site residents Clubhouse offers a unique third space between home and work which to socialise, exercise and be entertained, from a private screening room to virtual golf facilities; a residents club lounge and library and a 15m swimming pool, state-of-the-art gymnasium and spa.

Riverlight offers excellent transport links and a wide range of leisure and retail facilities at street level, including cafés, bar and restaurant and a creche.



These particulars, whilst believed to be accurate are set out as a general outline only for guidance and do not constitute any part of an offer or contract. Intending purchasers should not rely on them as statements of representation of fact, but must satisfy themselves by inspection or otherwise as to their accuracy. No person in this firms employment has the authority to make or give any representation or warranty in respect of the property.