

Denver Building

6 Malthouse Road, Nine Elms, SW11 7BY

£911 Per Week



2



2



1



B

Floor Plan

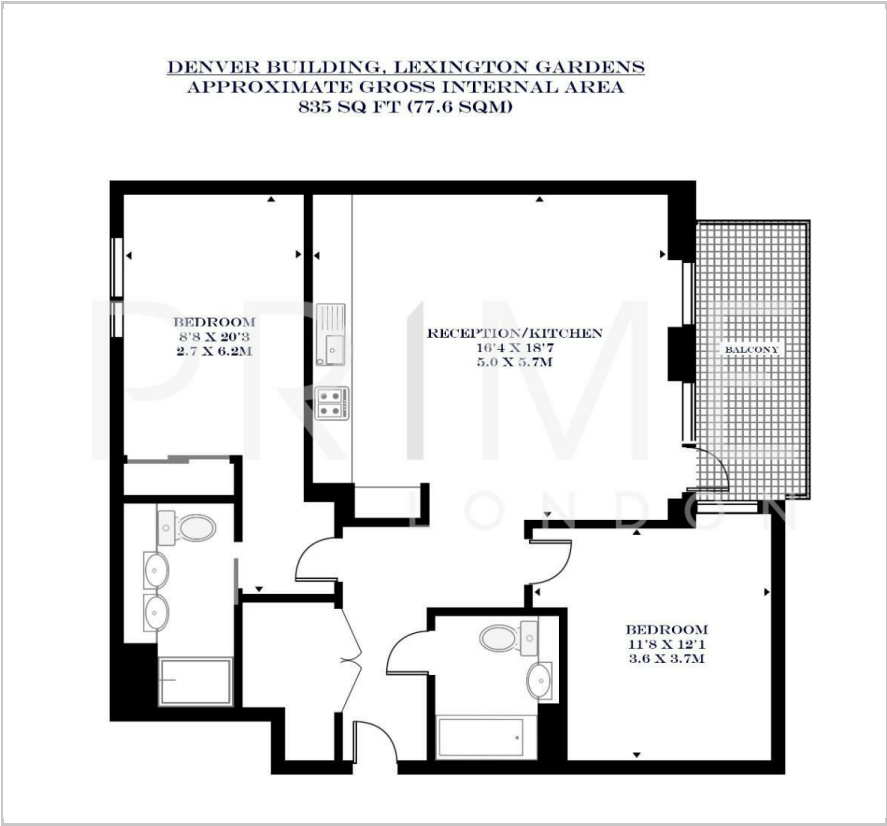

Area Map

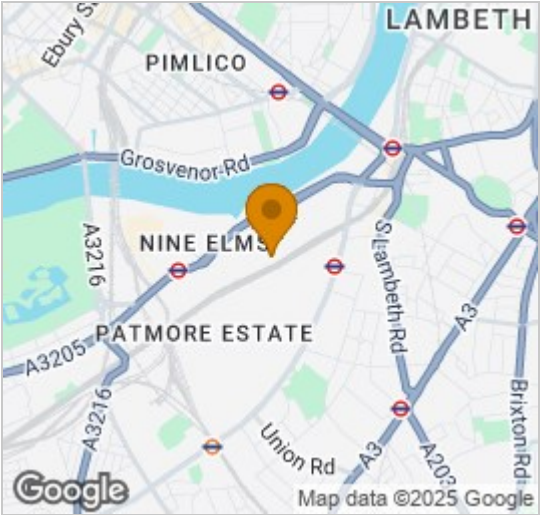

Energy Efficiency Graph

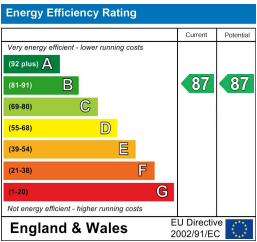

Viewing

By appointment. Contact us on 0207 928 6663 if you wish to arrange a viewing appointment for this property, or require further information.

- Beautifully furnished ■ West facing balcony apartment
- 835 sq ft (77.6 sqm) ■ Plethora of residents' only facilities
- 24 hour concierge ■ Fitness suite



In an excellent westerly position, this well laid out and furnished two bedroom, two bathroom apartment, with private balcony, is available for lease through Prime London.

Moments away from the Nine Elms Underground station, this 835 sq ft (77.6 sqm) apartment comprises of an open plan kitchen and living area, two large double bedrooms (master with ensuite), a separate bathroom and plenty of storage.

Lexington Gardens benefits from the brilliant selection of private amenities, including a 24 hour concierge, a media lounge, meeting suite, podium gardens, yoga room and fully equipped fitness suite.

The development is adjacent to the new US Embassy as well as a variety of local restaurants, supermarkets and other amenities.

Uniquely situated between Vauxhall Bridge and the new Battersea Power Station, Nine Elms is London's newest and most exciting district. As the last piece of the jigsaw in a master plan that has finally opened up this part of Central London, Nine Elms will be a state of the art destination for living, culture, green spaces, education, industry, work and entertainment.



These particulars, whilst believed to be accurate are set out as a general outline only for guidance and do not constitute any part of an offer or contract. Intending purchasers should not rely on them as statements of representation of fact, but must satisfy themselves by inspection or otherwise as to their accuracy. No person in this firm's employment has the authority to make or give any representation or warranty in respect of the property.