

Landmark Pinnacle

10 Marsh Wall, Canary Wharf, E14 9GU

£1,753 Per Week

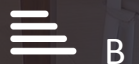
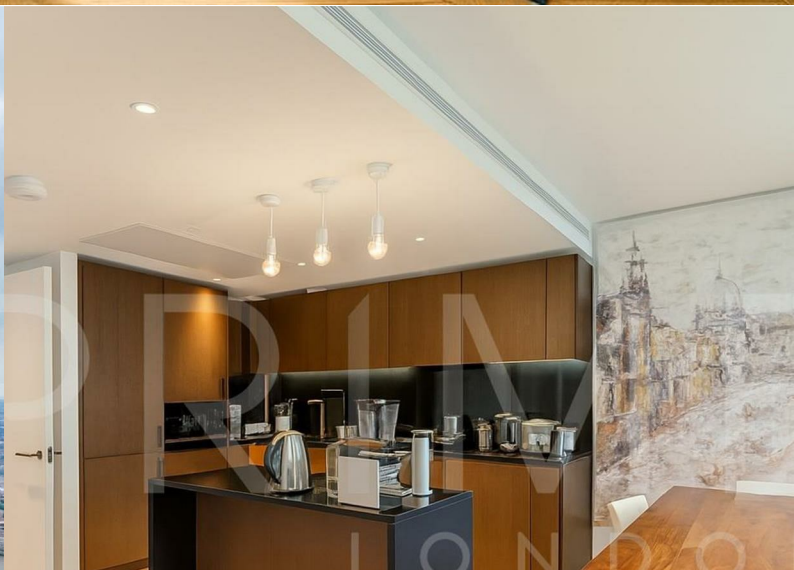

Floor Plan

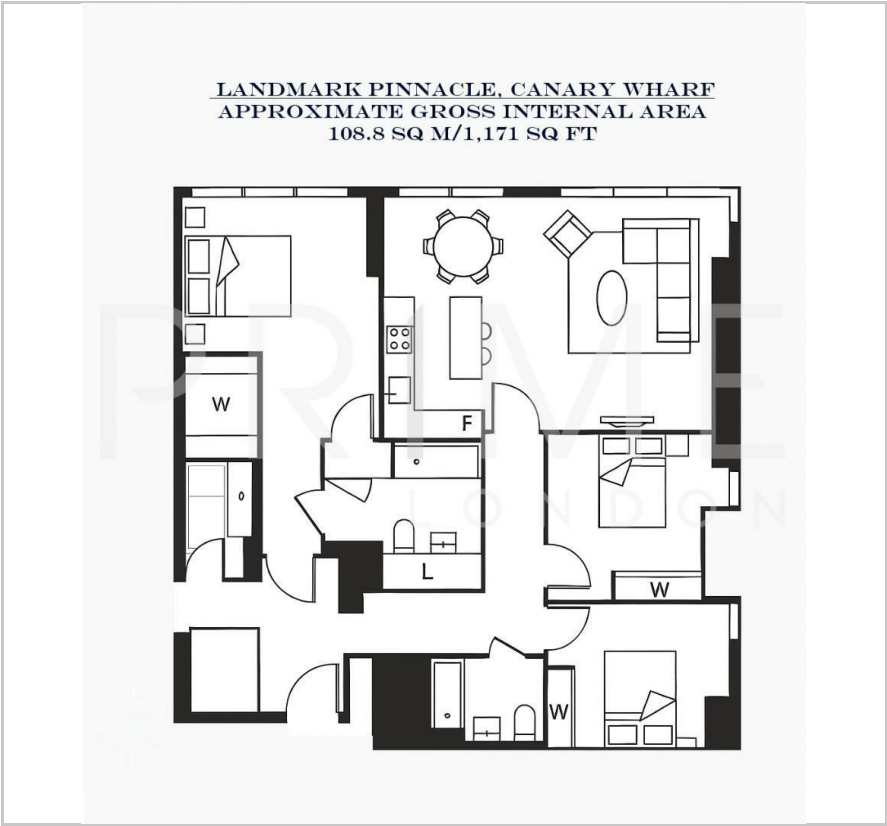

Area Map



Energy Efficiency Graph

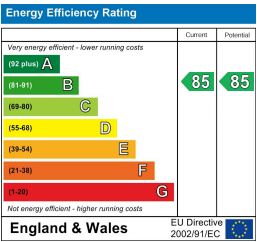

Viewing

By appointment. Contact us on 0207 052 1075 if you wish to arrange a viewing appointment for this property, or require further information.

- Three bedroom apartment ■ 1,171 sq ft (108.8 sqm)
- Fully furnished to a high standard ■ Resident's gym, studio, cinema and meeting rooms
- Just 0.3 miles to Heron Quays ■ 24 hour concierge DLR



This exceptional three bedroom penthouse, situated within the iconic Landmark Pinnacle development in Canary Wharf, is available for lease through Prime London.

Positioned high above the city, the apartment offers breath-taking panoramic views of the London skyline, framed through impressive floor-to-ceiling windows that flood the interior with natural light. The property features a contemporary open-plan layout. A sleek, modern kitchen flows effortlessly into the spacious reception area, creating a stylish and functional space. Three generously sized bedrooms provide a calm and comfortable retreat. There are two beautifully appointed bathrooms complete with modern fittings.

Residents of Landmark Pinnacle enjoy access to an exceptional suite of on-site amenities, including a 24 hour concierge, landscaped gardens and a children's play area, a residents' lounge and library, private dining and meeting rooms, a fully equipped gym and studio, a cinema/media room, secure bicycle storage, electric car charging points, and more.

Transport links are superb, with Heron Quays DLR just 0.3 miles away, Canary Wharf Underground Station within 0.5 miles, and Thames Clippers river services easily accessible.



These particulars, whilst believed to be accurate are set out as a general outline only for guidance and do not constitute any part of an offer or contract. Intending purchasers should not rely on them as statements of representation of fact, but must satisfy themselves by inspection or otherwise as to their accuracy. No person in this firms employment has the authority to make or give any representation or warranty in respect of the property.