



Beaufort Mansions

Beaufort Street, Chelsea, SW3 5AE

£995 Per Week



1



2



1



D

Floor Plan

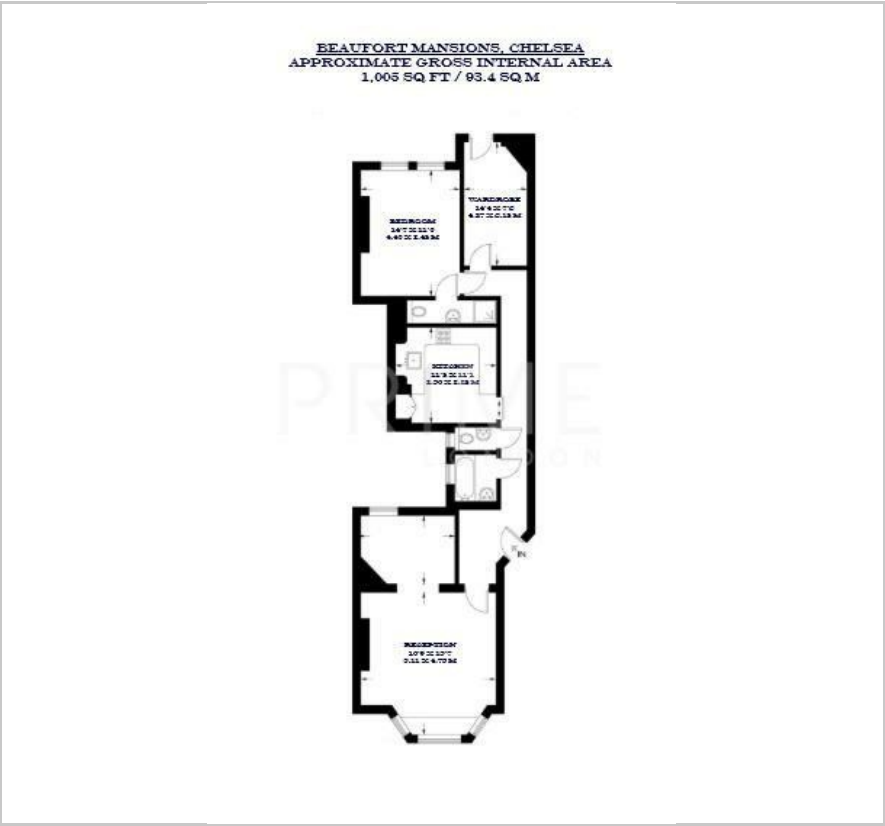

Area Map

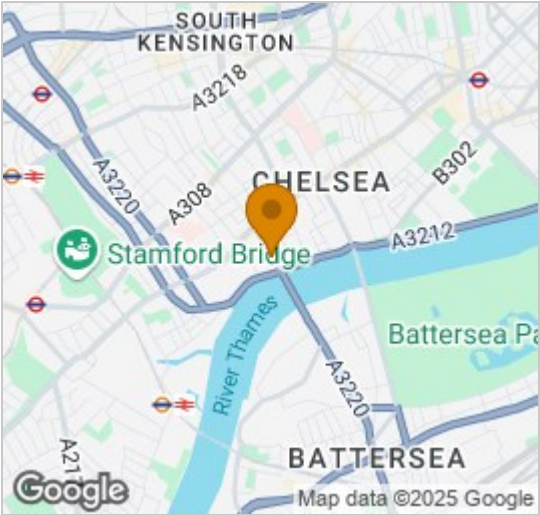

Energy Efficiency Graph

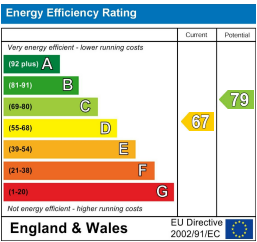

Viewing

By appointment. Contact us on 0207 052 1075 if you wish to arrange a viewing appointment for this property, or require further information.

- One bedroom apartment
- Generous walk in wardrobe
- Prestigious Chelsea location
- 1,005 sq ft (93.4 sqm)
- Direct access to peaceful communal gardens
- Short walk to South Kensington station

SHORT LET - This beautifully presented one bedroom apartment, located in the prestigious Chelsea neighbourhood, is available for short let through Prime London.

Totalling 1,005 sq ft (93.4 sqm), the property offers generous proportions and refined finishes throughout. It features a spacious reception room, a double bedroom with an adjoining dressing room, two well-appointed bathrooms, a fully equipped kitchen, and the added benefit of direct access to a peaceful communal garden.

Perfectly positioned, Beaufort Mansions is located at the centre of Chelsea's most desirable lifestyle. King's Road is on your doorstep, with a vibrant mix of designer fashion, independent boutiques, cafés, and renowned restaurants.

Excellent transport links include South Kensington and Sloane Square stations, ensuring seamless access to the West End, Heathrow, and the rest of London.



These particulars, whilst believed to be accurate are set out as a general outline only for guidance and do not constitute any part of an offer or contract. Intending purchasers should not rely on them as statements of representation of fact, but must satisfy themselves by inspection or otherwise as to their accuracy. No person in this firm's employment has the authority to make or give any representation or warranty in respect of the property.