



## 4 Sloane Gardens

Belgravia, SW1W 8DL

£1,700 Per Week





Floor Plan

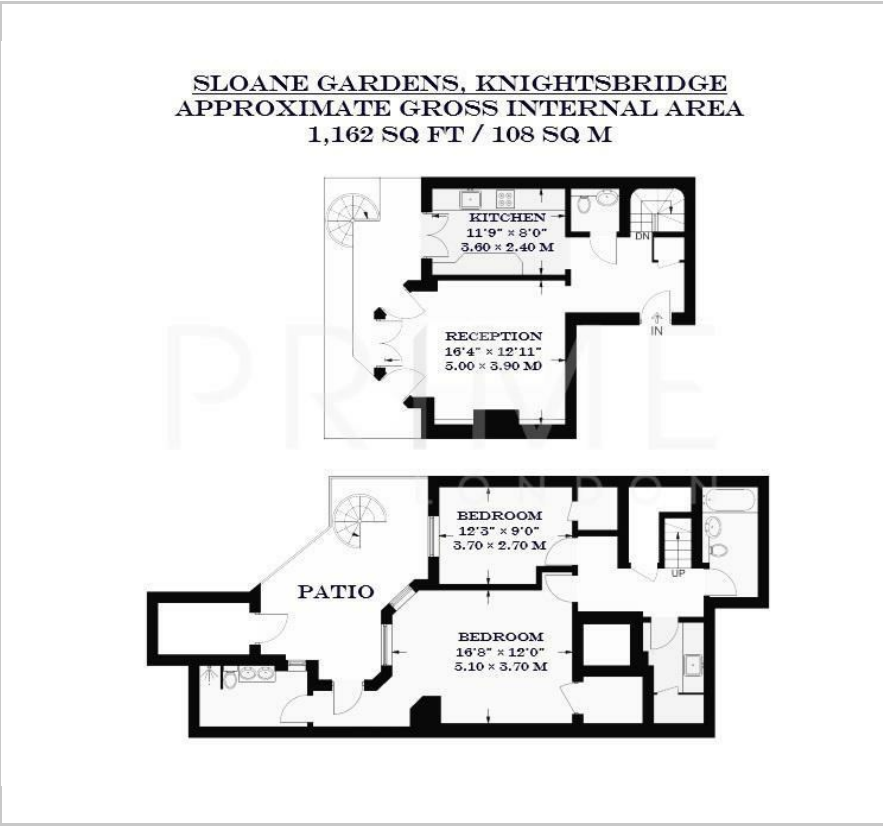

Area Map

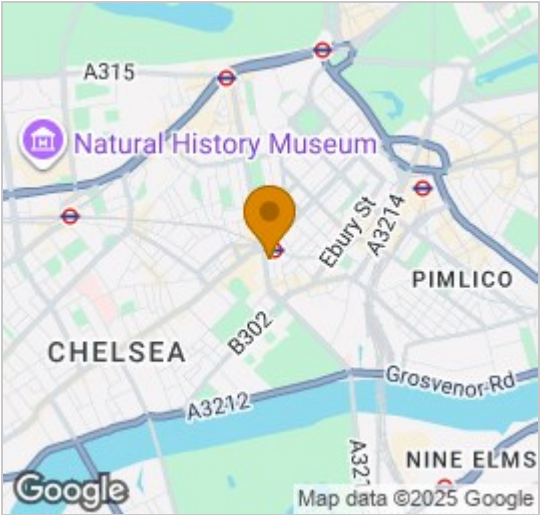

Energy Efficiency Graph

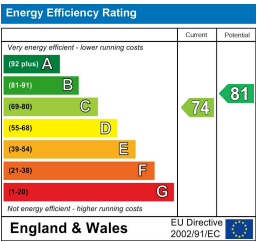

Viewing

By appointment. Contact us on 0207 052 1075 if you wish to arrange a viewing appointment for this property, or require further information.

- Duplex apartment
- Period features
- Perfectly positioned between Belgravia and Chelsea
- 1,162 sq ft (107 sqm)
- Private patio with access to communal gardens
- Less than 5 minutes' walk to Sloane Square Station

This beautifully presented two bedroom duplex apartment, located in the sought after Belgravia neighbourhood, is available for lease through Prime London.

This unique home spans 1,162 sq ft (107 sqm) and combines high ceilings, wooden flooring and charming garden views, with French doors leading directly from the reception onto the private patio and into the landscaped communal gardens. The contemporary kitchen is fitted with Neff appliances and premium cookware.

On the lower floor are the two bedrooms, with the master bedroom featuring a walk-in wardrobe, en suite bathroom, along with access to a second private patio. The second bedroom features its own walk in wardrobe, with a family bathroom adjacent.

Additional benefits include a dedicated utility room, a secure vault for extra storage, and a private outdoor dining area.

The apartment is ideally located within easy reach of Chelsea, Kensington and Belgravia, offering an excellent selection of shops, cafés, and fine dining restaurants.

Sloane Square Station is located a stone's throw away.



These particulars, whilst believed to be accurate are set out as a general outline only for guidance and do not constitute any part of an offer or contract. Intending purchasers should not rely on them as statements of representation of fact, but must satisfy themselves by inspection or otherwise as to their accuracy. No person in this firms employment has the authority to make or give any representation or warranty in respect of the property.