



## Lombard Wharf

12 Lombard Road, Battersea, SW11 3GN

£750 Per Week



Floor Plan

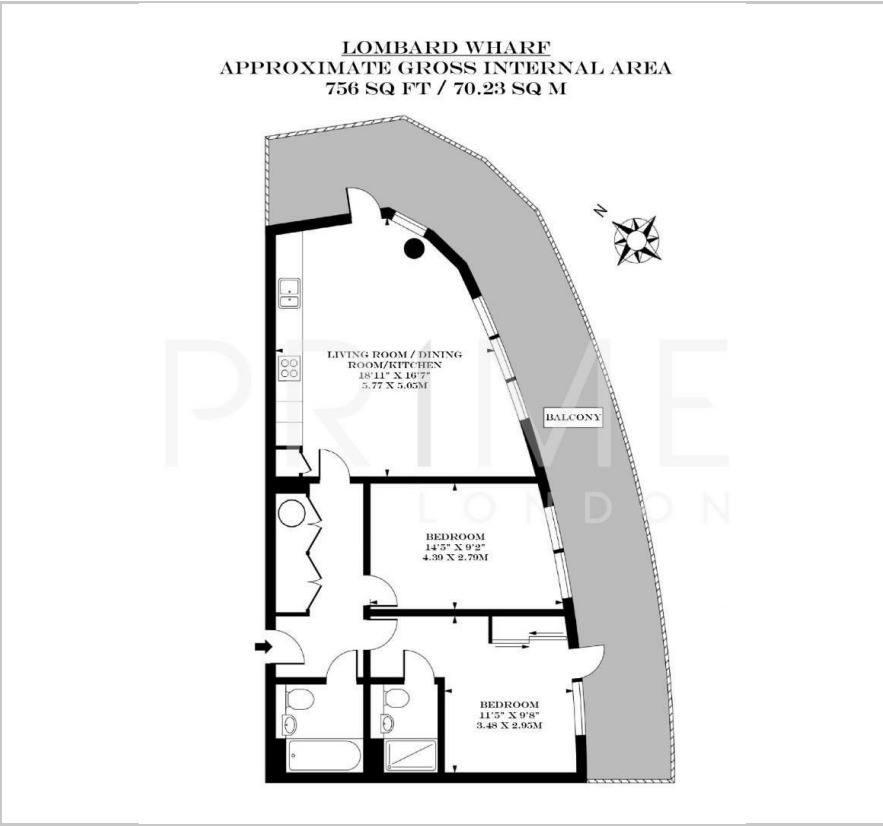

Area Map



Energy Efficiency Graph

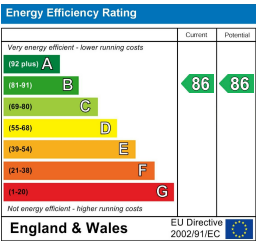

Viewing

By appointment. Contact us on 0207 928 6663 if you wish to arrange a viewing appointment for this property, or require further information.

- Two bedroom apartment
- Fully furnished
- Private wrap-around terrace
- Fitness suite
- 756 sqft (70.23 sqm)
- River views
- 24 Hour concierge
- Secure cycle storage



This beautifully presented fully furnished two-bedroom apartment in the iconic Lombard Wharf development, offering exceptional living space and panoramic views across London is available to let through Prime London.

The apartment extends to 756 sqft (70.23) and is thoughtfully laid out. A spacious open-plan living, dining and kitchen area forms the heart of the home, with full-height curved windows flooding the space with natural light and opening onto a private wrap-around terrace. The modern kitchen is fitted with integrated appliances and offers ample room for dining and entertaining. The principal bedroom benefits from an ensuite shower room, while a second well-proportioned double bedroom is accompanied by a stylish family bathroom. Both bedrooms enjoy direct access to the terrace, maximising the apartment's impressive outlook. Additional features include underfloor heating and comfort cooling throughout.

Residents of Lombard Wharf enjoy the benefit of a 24-hour concierge service providing security and convenience, a residents-only fitness suite, secure cycle storage and striking architectural design, with the tower's unique twisted form creating a landmark riverside presence.

Located in Battersea, the development is within walking distance of Battersea Square and Clapham Junction, providing fast connections into Central London (Waterloo in just 8 minutes). The Thames Clipper riverboat service is also nearby, offering a scenic and convenient commute.

Surrounded by green spaces, artisan shops, cafés and cultural venues, Lombard Wharf offers a rare combination of riverside tranquillity and vibrant city living.



These particulars, whilst believed to be accurate are set out as a general outline only for guidance and do not constitute any part of an offer or contract. Intending purchasers should not rely on them as statements of representation of fact, but must satisfy themselves by inspection or otherwise as to their accuracy. No person in this firm's employment has the authority to make or give any representation or warranty in respect of the property.