



The Tower

One St George Wharf, SW8 2DA

£1,038 Per Week



Floor Plan

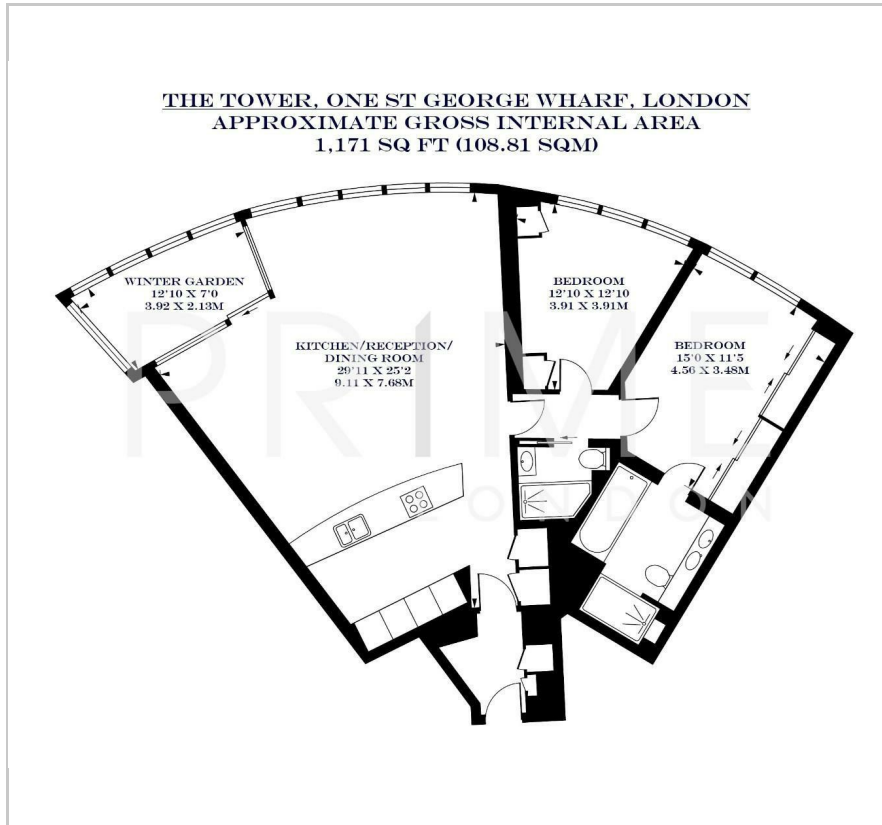

Area Map

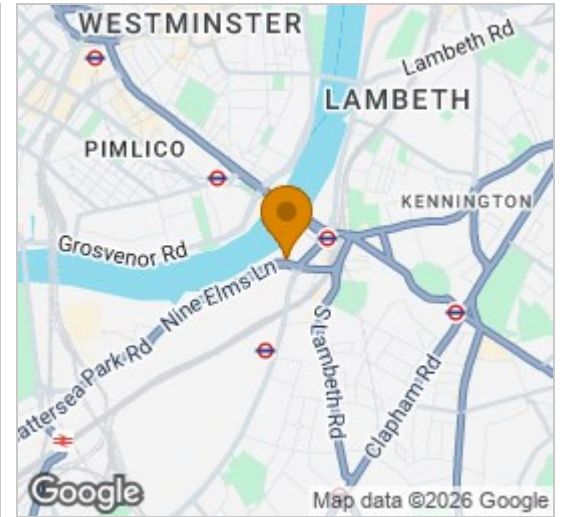

Energy Efficiency Graph

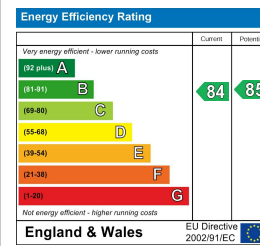

Viewing

By appointment. Contact us on 0207 928 6663 if you wish to arrange a viewing appointment for this property, or require further information.

- Stunning apartment
- High floor
- Gym, pool and sauna facilities
- Valet parking
- 1,171 sq ft (108.81 sqm)
- Fully furnished
- Private cinema
- Front door concierge



This exceptional two bedroom apartment, located on a high floor within the iconic St George Wharf Tower on the River Thames, offering excellent views of London, is available for lease through Prime London. The property also comes with secure valet parking.

This 1,171 sq ft (108.81 sqm) apartment offers stunning views across London and the new high-rise vicinity of Nine Elms, and features an excellent specification throughout including marble, glass and polished stone finishes. The apartment further benefits from its own sky garden balcony, fully comprehensive kitchen with Miele appliances, and modern bathrooms.

Amenities include front door concierge with valet parking, first floor gym, pool and sauna facilities as well as a private cinema.

St George Wharf also offers on site riverside bars and restaurants such as Waterfront London, The Riverside, Cottons, and Vine Bar, as well as direct access to Vauxhall Underground Station.

For additional convenience other on-site outlets include Tesco Express, Pret a Manger, Hudson's Dry Cleaners, Riverside Medical Centre, Dental Spa and more.



These particulars, whilst believed to be accurate are set out as a general outline only for guidance and do not constitute any part of an offer or contract. Intending purchasers should not rely on them as statements of representation of fact, but must satisfy themselves by inspection or otherwise as to their accuracy. No person in this firm's employment has the authority to make or give any representation or warranty in respect of the property.